

4

3

2

1

Please Approve this Drawing

| | |
|-----------|--|
| Date | |
| Signature | |

| REVISIONS | | | | |
|-----------|-----------------|-----------|----------|--------------|
| LTR | DESCRIPTION | DATE | APPROVED | NOTE |
| | INITIAL RELEASE | 06/27/'18 | | ECN-10706015 |
| △ | | | | |
| △ | | | | |
| △ | | | | |

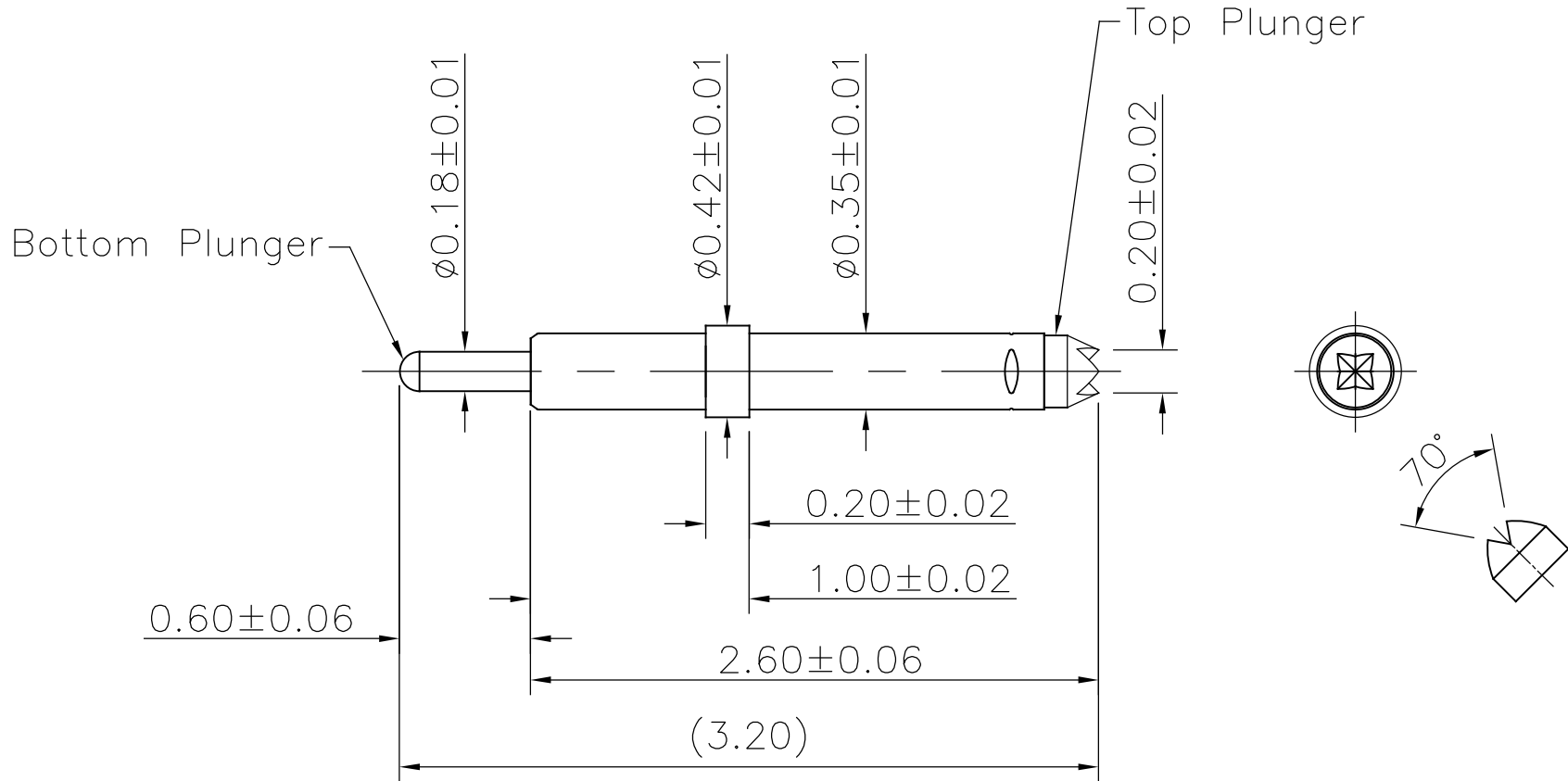

- Notes :
- Materials and Finishes
 - Top plunger : BeCu alloy with gold plating
 - Barrel : PhBz alloy with gold plating
 - Spring : SWP with flash Au
 - Bottom Plunger : BeCu alloy with gold plating
 - Mechanical
 - Recommended travel : 0.40 mm
 - Full travel : 0.50 mm
 - Spring force : 10 g at initial travel
 - Spring force : 30 g \pm 20% at recommended travel
 - Spring force : 36 g \pm 20% at full travel
 - Durability :
 - Mechanical life 200k cycles(minimum) at recommended travel

| | | | | |
|---|------------|--|--|---------|
| DRAWN | | SCALE: 25 / 1 | 中國探針股份有限公司 C.C.P. CONTACT PROBES CO.,LTD. | |
| CHECKED | | SHEET: 1 OF 1 | TITLE: $\phi 0.35 * \phi 0.18 * 3.20$ mm | |
| APPROVED | | DATE:06/27/'18 | A Probes | |
| DIMENSIONS ARE IN MILLIMETERS TOLERANCES ARE: DECIMALS ± .25 X.X ± .15 X.XX ± .10 | | THE INFORMATION AND DESIGN DISCLOSED HEREIN WAS ORIGINATED BY AND IS THE PROPERTY OF C.C.P. CONTACT PROBES CO.,LTD. C.C.P. CONTACT PROBES CO.,LTD. RESERVES ALL PATENT, PROPRIETARY DESIGN, MANUFACTURING, REPRODUCTION, USE AND SALES RIGHTS THEREOF, AND TO ANY ARTICLE DISCLOSED HEREIN EXCEPT TO THE EXTENT RIGHTS ARE EXPRESSLY GRANTED TO OTHERS. THE FOREGOING DOES NOT APPLY TO VENDOR PROPRIETARY RIGHTS. | | |
| UNIT : mm | FILE PATH: | SIZE A4 | DRAWING NO. DE4-035DF24-03F0 | REV. A0 |

4

3

2

1