

REVISIONS			
No.	DESCRIPTION	ECN No.	DATE
	RELEASE		

Please Approve this Drawing

Date	
Signature	

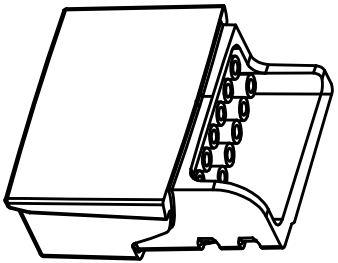
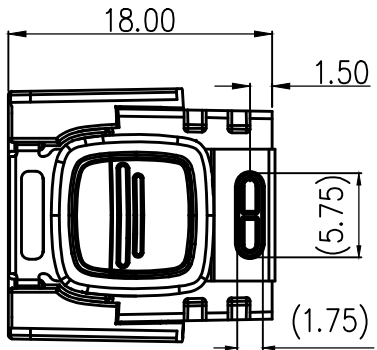
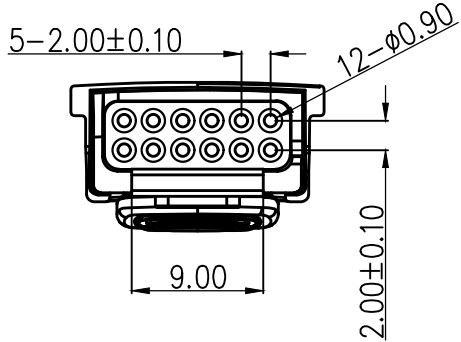
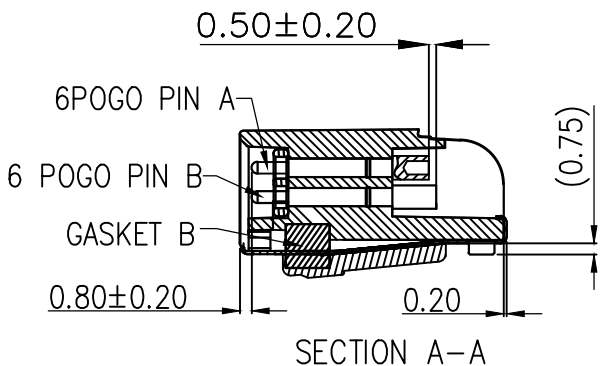
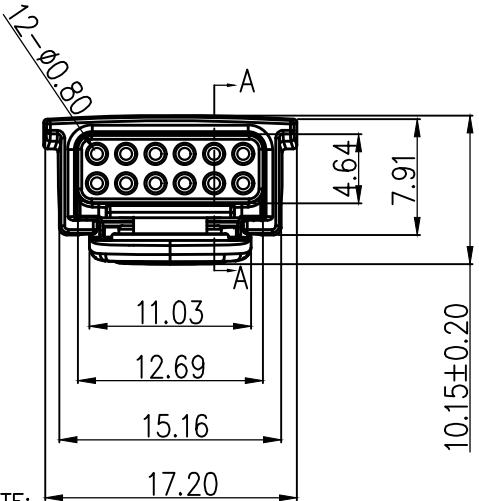
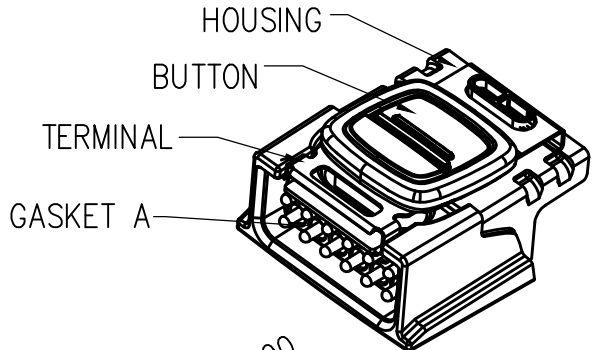
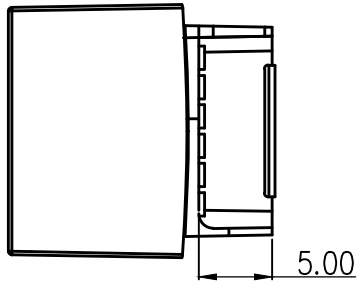

- NOTE:
- Material:
    - Housing: Black PA46
    - pogo pin A(6PCS): Brass&sus304 Au Plated
    - pogo pin B(6PCS): Brass&sus304 Au Plated
    - Gasket A: CR Black
    - Terminal:SUS 301
    - Gasket B: Poron Black
    - Button: PC
  - Electrical:
    - Rated Current & Voltage: DC 12V; 1A
    - Contact Resistance: 100 mΩ maximum at Working Height. (Quiescence)
  - Mechanical:
    - Pogo A Full Stroke: 2.20 mm
    - Pogo A Working Stroke: 1.70 mm
    - Pogo A Spring Force: 80g±20% at 1.70mm Stroke.
    - Pogo B Full Stroke: 2.20 mm
    - Pogo B Working Stroke: 1.70 mm
    - Pogo B Spring Force: 80g±20% at 1.70mm Stroke.
    - Durability: 100,000 cycles (minimum)
  - To ensure the best usage, please operate it based on the working Height  
Based on the Engineering Drawings, shall not exceed the maximum allowed compression
  - RoHs complied product

DRAWN	SCALE: 1:1	UNIT	mm	DRAWING NO.	F047AA00-12200ST
CHECKED	SHEET: 1 of 1	PROJECT		TITLE: 12-Pos Pogo Pin Connector	
APPROVED	DATE: 06/25/09'	VER.	A.0		
THE UNMARKED TOLERANCE ARE AS BELOW :			C.C.P. (DG) CONTACT PROBES CO.,LTD.		
LENGTH		ANGLE		东莞中探探针有限公司	
0~6.0	±0.05mm	0.0	±2.0°	The information in this document is property of C.C.P company and should not be copied or reproduced in any other way, without written permission.	
>6~30	±0.10 mm	0.0	±1.0°		
>30~120	±0.15mm	0.00	±0.50°		