

REVISIONS

| NO. | DESCRIPTION | ECN NO. | DATE |
|-----|-----------------|---------|------|
| A.0 | INITIAL RELEASE | | |

Please Approve this Drawing

| | |
|-----------|--|
| Date | |
| Signature | |

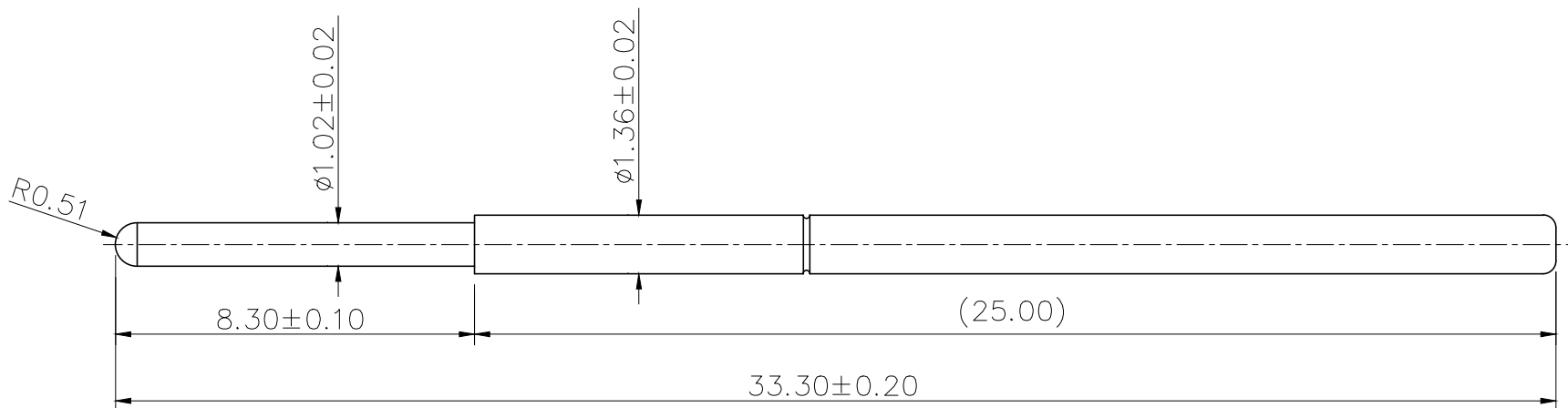

NOTE;

- Material (材料)
 - Top Plunge: BeCu Au plated
 - Barrel: Brass Au plated
 - Spring: SUS
- Mechanical:
 - Full stroke: 6.30 mm
 - Spring Force 250g ± 20% at 6.30mm stroke
- RoHS and HF compliant product.

| | | | | | | | |
|--|---------|------------|-------------------|--------------|--|---|--------------------|
| DRAW (设计) | 杨增达 | SCALE (比例) | 10 : 1 | UNIT (单位) | mm | DRAWING NO. (图号) | P-25D1-1525 |
| COUNTER SIGN (会签) | | SHEET (页数) | 1 of 1 | PROJECT (视图) | | MATERIAL (材质) | Seeing notes (见备注) |
| AUDIT (审核) | | DATE (日期) | 2018.09.21 | VER (版次) | A.0 | TITLE (品名) | Test Probe |
| APPROVE (核准) | | PLATE (镀层) | Seeing notes(见备注) | | | | |
| THE UNMARKED TOLERANCE ARE AS BELOW : (未标记的公差) LENGTH (尺寸) | | | | | | C.C.P. (DG) CONTACT PROBES CO.,LTD. 东莞中探探针有限公司 | |
| 0~6.0 | ±0.05mm | 0. | ANGLE (角度) | | The information in this document is property of C.C.P company and should not be copied or reproduced in any other way, without written permission. | | |
| >6~30 | ±0.10mm | 0.0 | ±2.0° | | | | |
| >30~120 | ±0.15mm | 0.00 | ±1.0° | | | | |
| | | | ±0.50° | | | | |

PRODUCED BY AN AUTODESK STUDENT VERSION

PRODUCED BY AN AUTODESK STUDENT VERSION