

REVISIONS (修正)			
NO. (序号)	DESCRIPTION(描述)	DCN NO.(变更号)	DATE(日期)
D.0	NEW RELEASE	DCN-201407013	2014.07.01
D.1	转开模图	DCN-201409062	2014.09.22

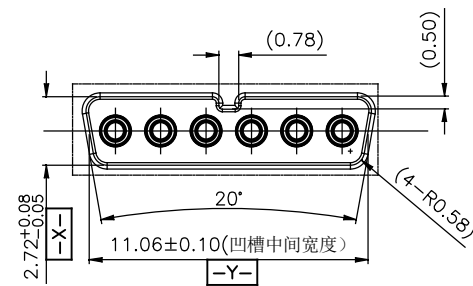

Detail A  
Scale 2:1

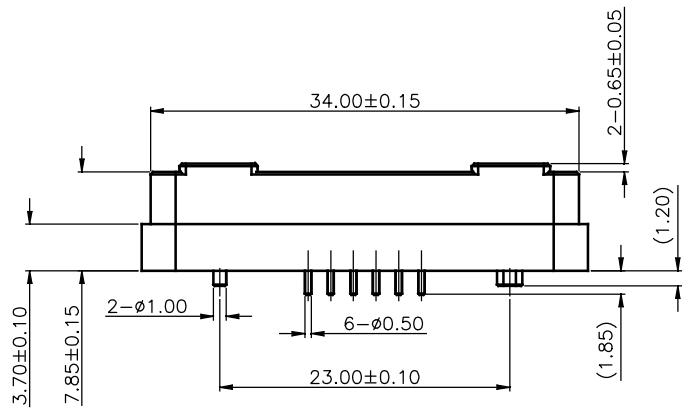
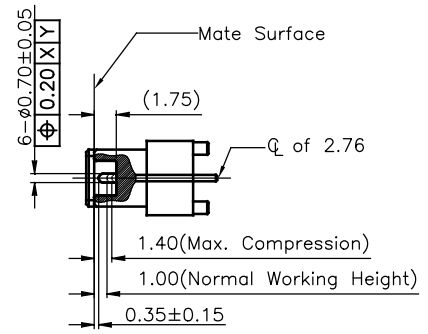
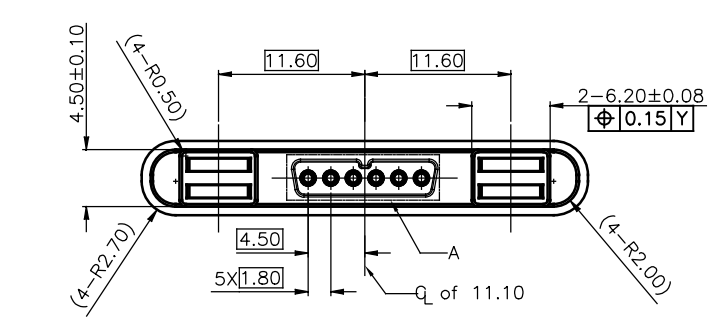
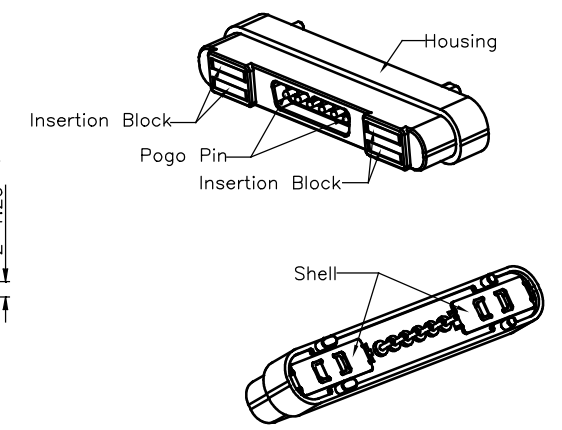
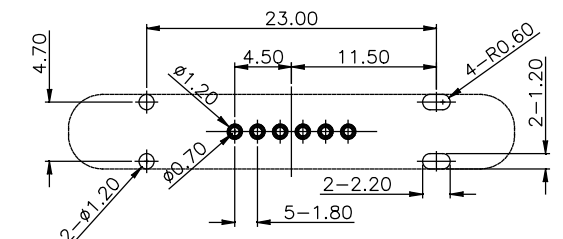
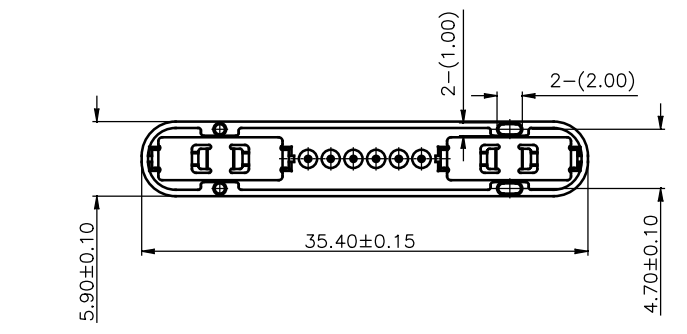

NOTES:

- Materials:
  - .Housing: LCP UL94V-0 Black.
  - .Pogo pin: Brass
  - .Shell: SUS304
  - .Insertion block : Magnetic steel
  - .Magnet: Magnetic material
- Plating:
  - .Pogo pin: 10 micro-inch minimum Au over 50~100 micro-inch nickel.
- Electrical:
  - .Rated current & voltage: DC12V, 3A.
  - .Contact resistance: 50 mohm maximum at working height(quiescence)
- Mechanical:
  - .Normal force: 70±20g at Normal working height
  - .Durability: 10,000 cycles(minimum)
- When the current is greater than 1A then need to increase the time delay circuit(3 second)
- To ensure the best usage, please operate it based on the working height. Based on the engineering drawings, shall not exceed the maximum allowed compression
- Harmful material control please follow DOC. NO."DQ03050"

Please Approve this Drawing	
Date	
Signature	

DRAWN (设计)	TXS	SCALE (比例)	5 : 3	UNIT (单位)	mm	DRAWING NO. (图号)	P2578MP01-06C180HT
CHECKED (确认)		SHEET (页数)	1 of 1	PROJECT (视图)		TITLE (品名)	Pitch 1.80
APPROVED (核准)		DATE (日期)	2014.09.22	VER. (版本)	D.1		6-Pos Pogo pin Conn.

THE UNMARKED TOLERANCE ARE AS BELOW :  
(未标记的公差)

LENGTH (尺寸)		ANGLE (角度)	
0~6.0	±0.05mm	0.	±2.0°
>6~30	±0.10mm	0.0	±1.0°
>30~120	±0.15mm	0.00	±0.5°

C.C.P. (DG) CONTACT PROBES CO.,LTD.  
东莞中探探针有限公司

The information in this document is property of C.C.P company and should not be copied or reproduced in any other way, without written permission.