

4

3

2

1

Please Approve this Drawing

Date	
Signature	

REVISIONS				
LTR	DESCRIPTION	DATE	APPROVED	NOTE
	INITIAL RELEASE	11/02/'16		ECN-10511007
△				
△				
△				

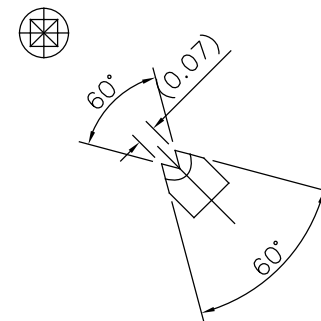
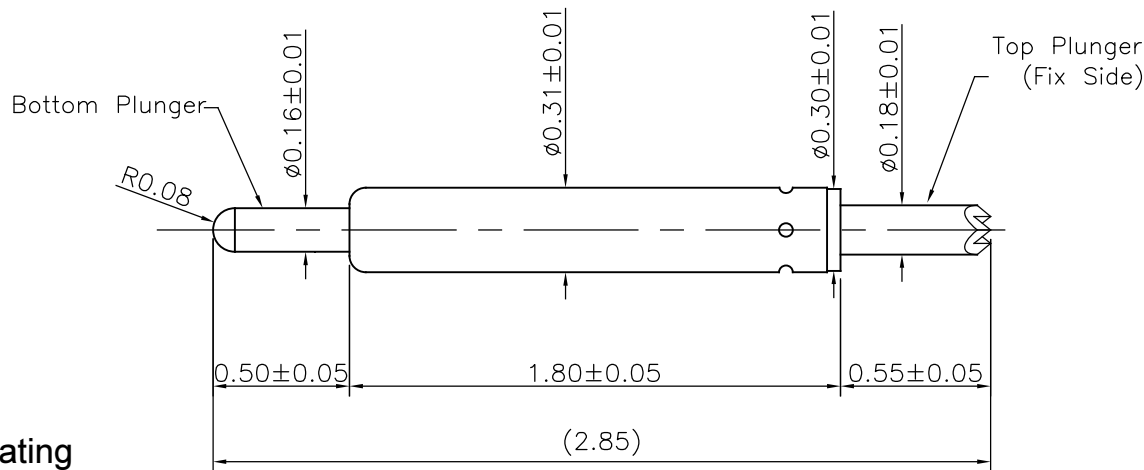

Notes :

1.Materials and Finishes

Top Plunger : Pd alloy

Barre I: PhBz alloy with gold plating

Spring1 : SUS with gold plating

Spring2 : SWP with gold plating

Bottom Plunger : BeCu alloy with gold plating

2.Mechanical

Recommended travel : 0.35 mm

Full travel : 0.45 mm

Spring force : 17 g at initial travel

Spring force : 30 g ± 20% at recommended travel

Spring force : 36 g ± 20% at full travel

3.Durability :

Mechanical life 200k cycles(minimum) at recommended travel

DRAWN	謝健琦	SCALE: 20 / 1
CHECKED		SHEET: 1 OF 1
APPROVED		DATE:11/17/'16
<small>DIMENSIONS ARE IN MILLIMETERS TOLERANCES ARE: DECIMALS ± .25 X.X ± .15 X.XX ± .10</small>		<small>THE INFORMATION AND DESIGN DISCLOSED HEREIN WAS ORIGINATED BY AND IS THE PROPERTY OF C.C.P. CONTACT PROBES CO.,LTD. C.C.P. CONTACT PROBES CO.,LTD. RESERVES ALL PATENT, PROPRIETARY DESIGN, MANUFACTURING, REPRODUCTION, USE AND SALES RIGHTS THEREOF, AND TO ANY ARTICLE DISCLOSED HEREIN EXCEPT TO THE EXTENT RIGHTS ARE EXPRESSLY GRANTED TO OTHERS. THE FOREGOING DOES NOT APPLY TO VENDOR PROPRIETARY RIGHTS.</small>
UNIT : mm	FILE PATH:	

中國探針股份有限公司 C.C.P. CONTACT PROBES CO.,LTD.		
TITLE: φ0.31*φ0.16*2.85mm Probes		
SIZE A4		DRAWING NO. PE3-031DF17-07F0 REV. 00