

PART No. PR-25W5-A14

Please Approve this Drawing

Date

Signature

| REVISIONS | | | | |
|-----------|-------------------------------|-----------|----------|-------------|
| LTR | DESCRIPTION | DATE | APPROVED | NOTE |
| A0 | INITIAL RELEASE | 06/09/04' | | ECN-9306016 |
| △ | ADD RETENTION FORCE | 04/14/05' | | ECN-9404026 |
| △ | Modify 1.42±0.01 to 1.42±0.02 | 08/19/09 | | ECN-9808014 |
| △ | Modify 1.47±0.02 to (1.47) | 08/19/09 | | ECN-9808014 |

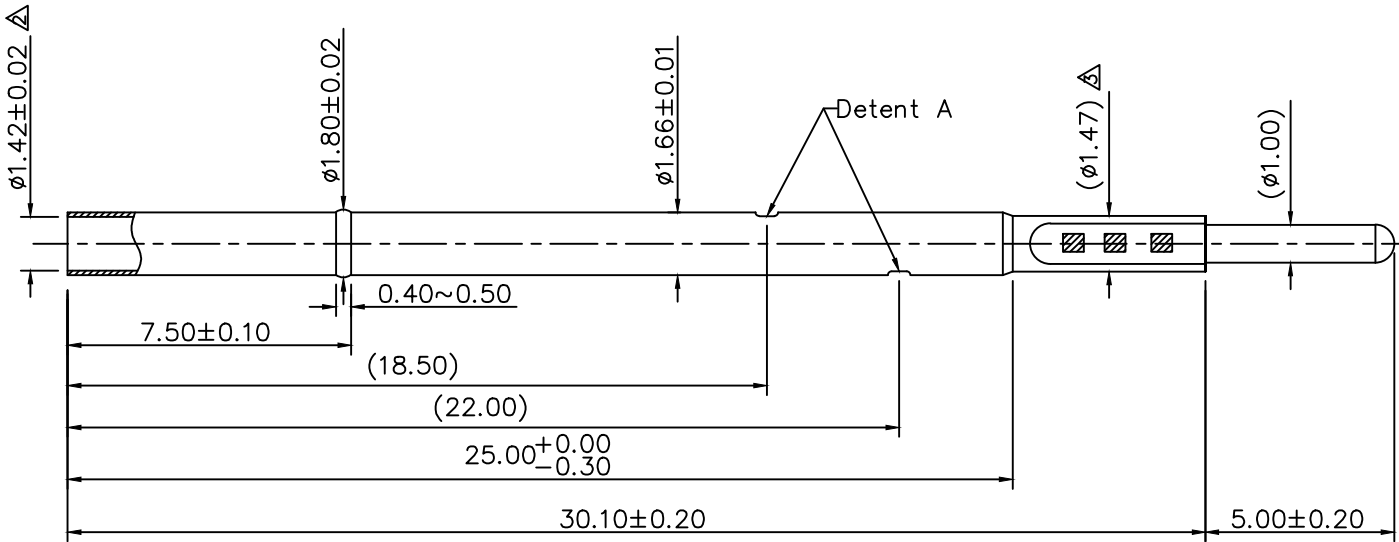

NOTES:

- MATERIALS:
RECEPTACLE : BRASS
- PLATING:
RECEPTACLE : BRASS Ni/Au
OVER SUBSTRATE PLATED 80~120 μ Nickel
2 μ Au PLATED.
- DETENT A, THE INSERT FORCE IS 0.8~1.2Kg.
- THE RETENTION FORCE OF PIN WAS CRIMPED TO RECEPTACLE SHOULD BE >2Kg

| | | | |
|---|-----------------|---|---------|
| DRAWN | SCALE: 5 / 1 | <p>中國探針有限公司 C.C.P. CONTACT PROBES CO.,LTD.</p> | |
| CHECKED | SHEET: 1 OF 1 | | |
| APPROVED | DATE: 08/19/'09 | TITLE: P-25 RECEPTACLE | |
| <small>DIMENSIONS ARE IN MILLIMETERS TOLERANCES ARE: DECIMALS .20 X .10 X.X .05 ANGLES ± 2.0° ± 1.0° ± 0.5°</small> | | <small>THE INFORMATION AND DESIGN DISCLOSED HEREIN WAS ORIGINATED BY AND IS THE PROPERTY OF C.C.P. CONTACT PROBES CO.,LTD. C.C.P. CONTACT PROBES CO.,LTD. RESERVES ALL PATENT, PROPRIETARY DESIGN, MANUFACTURING, REPRODUCTION, USE AND SALES RIGHTS THEREOF, AND TO ANY ARTICLE DISCLOSED HEREIN EXCEPT TO THE EXTENT RIGHTS ARE EXPRESSLY GRANTED TO OTHERS. THE FOREGOING DOES NOT APPLY TO VENDOR PROPRIETARY RIGHTS.</small> | |
| UNIT : mm | FILE PATH: | SIZE A4 | |
| | | DRAWING NO. R-25W5T | REV. A2 |