

PART No. PR-11V-A12

REVISIONS				
LTR	DESCRIPTION	DATE	APPROVED	NOTE
A0	INITIAL RELEASE	11/08/99'		
△	ADD TO (13.5)	05/19/04'		ECN-9305035
△	MODIFY 15+0.05 TO (15.5)	05/19/04'		ECN-9305035
△	ADD INSERT FORCE 0.5~1.2kg(AFTER PLATING)	05/19/04'		ECN-9305035
△	ADD RETENTION FORCE	04/14/05'		ECN-9404032
△	Modify 1.20 to 1.2	05/25/05'		ECN-9405031

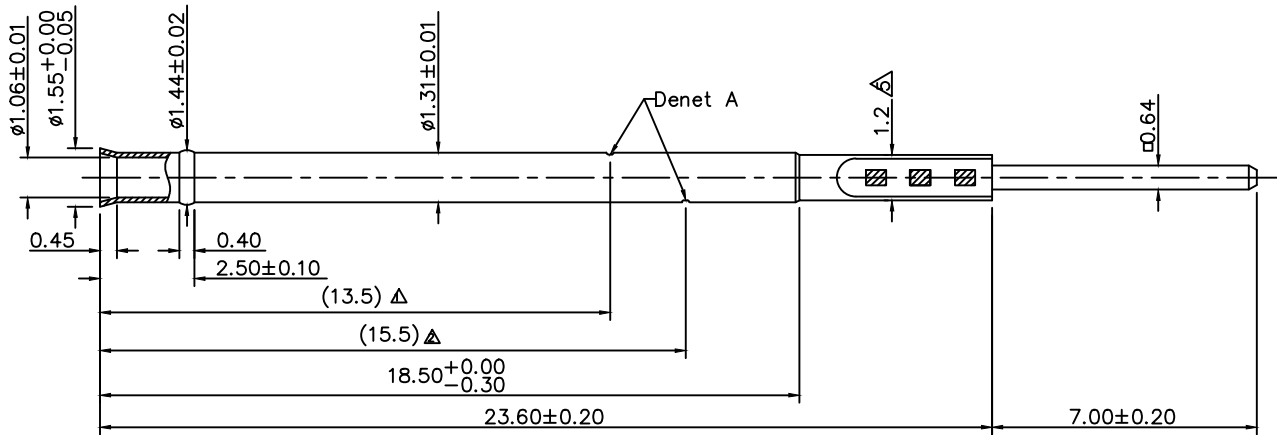

NOTES:

- MATERIALS:  
.RECEPTACLE : BRASS
- PLATING:  
.RECEPTACLE : BRASS Ni/Au  
.OVER SUBSTRATE PLATED 80~120 μ" Nickel  
. 2 μ" Au PLATED.
- DETENT A, THE INSERT FORCE IS 0.3~0.6Kg.(BEFORE PLATING)
- DETENT A, THE INSERT FORCE IS 0.5~1.2Kg.(AFTER PLATING) △
- THE RETENTION FORCE OF PIN WAS CRIMPED TO RECEPTACLE SHOULD BE >2Kg △

DRAWN	SCALE: 5 / 1	 C.C.P. CONTACT PROBES CO.,LTD.	
CHECKED	SHEET: 1 OF 1		
APPROVED	DATE: 05/25/05'	TITLE	P-11
DIMENSIONS ARE IN MILLIMETERS TOLERANCES ARE: DECIMALS ± .20 X. ± .10 X.X ± .05 ANGLES ± 2.0° ± 1.0° ± 0.5°		THE INFORMATION AND DESIGN DISCLOSED HEREIN WAS ORIGINATED BY AND IS THE PROPERTY OF C.C.P. CONTACT PROBES CO.,LTD. C.C.P. CONTACT PROBES CO.,LTD. RESERVES ALL PATENT, PROPRIETARY DESIGN, MANUFACTURING, REPRODUCTION, USE AND SALES RIGHTS THERE TO, AND TO ANY ARTICLE DISCLOSED HEREIN EXCEPT TO THE EXTENT RIGHTS ARE EXPRESSLY GRANTED TO OTHERS. THE FOREGOING DOES NOT APPLY TO VENDOR PROPRIETARY RIGHTS.	
UNIT : mm	SIZE A4	DRAWING NO.	REV.
FILE PATH:		R-11V-2	A3