

Please Approve this Drawing

Date

Signature

REVISIONS			
NO.	DESCRIPTION	ECN No.	DATE
	INITIAL RELEASE	12102053009	2102.05.30

NOTES:

- Materials:
 - .Housing : Black HTN(UL94V-0)
 - .Plunger: Brass C3604
 - .Barrel: Brass C3604
 - .Spring: SUS304
 - .Terminal: Copper Alloy
- Plating:
 - .Contact Surface :10 micro inch minimum Au over 50~100 micro inch Ni.
- Electrical
 - .Rated Current & Voltage : DC 12 V ; 1A
 - .Contact Resistance:50 mohm maximum at Working Height(Quiescence)
- Mechanical
 - .Spring Force:120g±20% at Working Height
 - .Durability:10,000 cycles(minimum)
- When the current is greater than 1A then need to increase the time delay circuit(3 second)
- To ensure the best usage, please operate it based on the working Height.
 - .Based on the Engineering Drawings, shall not exceed the maximum allowed compression.
- .RoHs and HF compliant product.

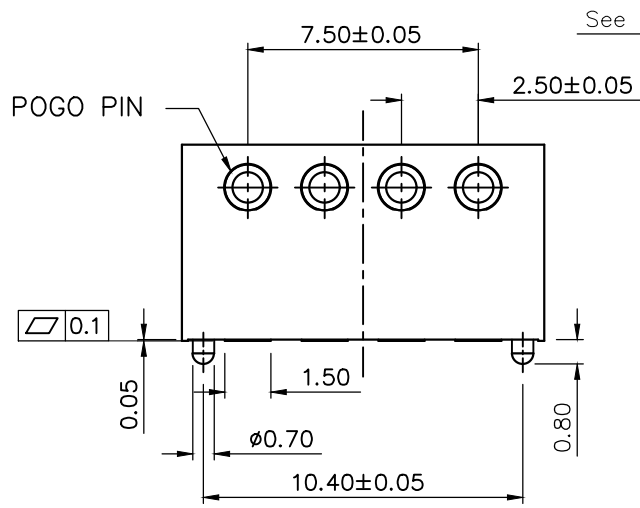
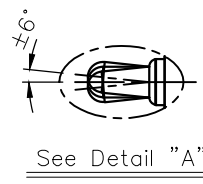
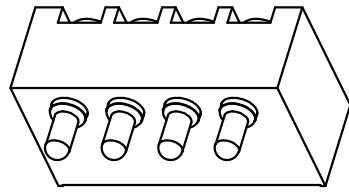
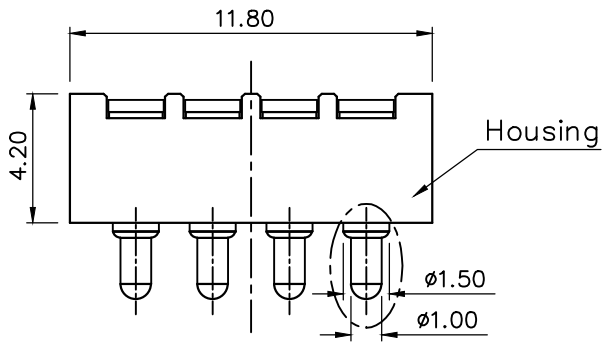

See Detail "A"

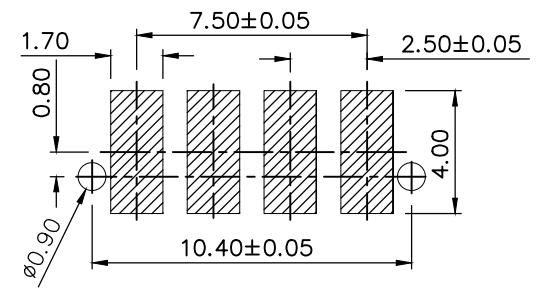
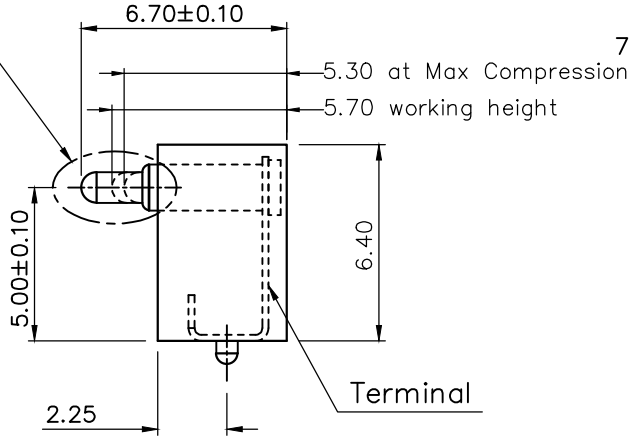

RECOMMEND PCB LAYOUT
Layout Tolerance: ± 0.05mm

DRAWN	唐华民	SCALE:	1 : 1	UNIT	mm	DRAWING NO.	R035AA05-04250RR
CHECKED		SHEET:	1 of 1	PROJECT		TITLE: 4Pin Pogo Pin Connector	
APPROVED		DATE:	2012.05.30	VER.	A.0		

THE UNMARKED TOLERANCE ARE AS BELOW :

LENGTH	ANGLE
0~6.0	±0.05mm
>6~30	±0.10mm
>30~120	±0.15mm
	0.0
	±2.0°
	±1.0°
	±0.5°

C.C.P. (DG) CONTACT PROBES CO.,LTD.
东莞中探探针有限公司

The information in this document is property of C.C.P company and should not be copied or reproduced in any other way, without written permission.