

Please Approve this Drawing

| | |
|-----------|--|
| Date | |
| Signature | |

| REVISIONS(修正) | | | |
|---------------|-----------------|----------------|------------|
| NO.(序号) | DESCRIPTION(描述) | ECN NO.(变更号) | DATE(日期) |
| A.0 | INITIAL RELEASE | ECN-2201509010 | 2015.09.07 |

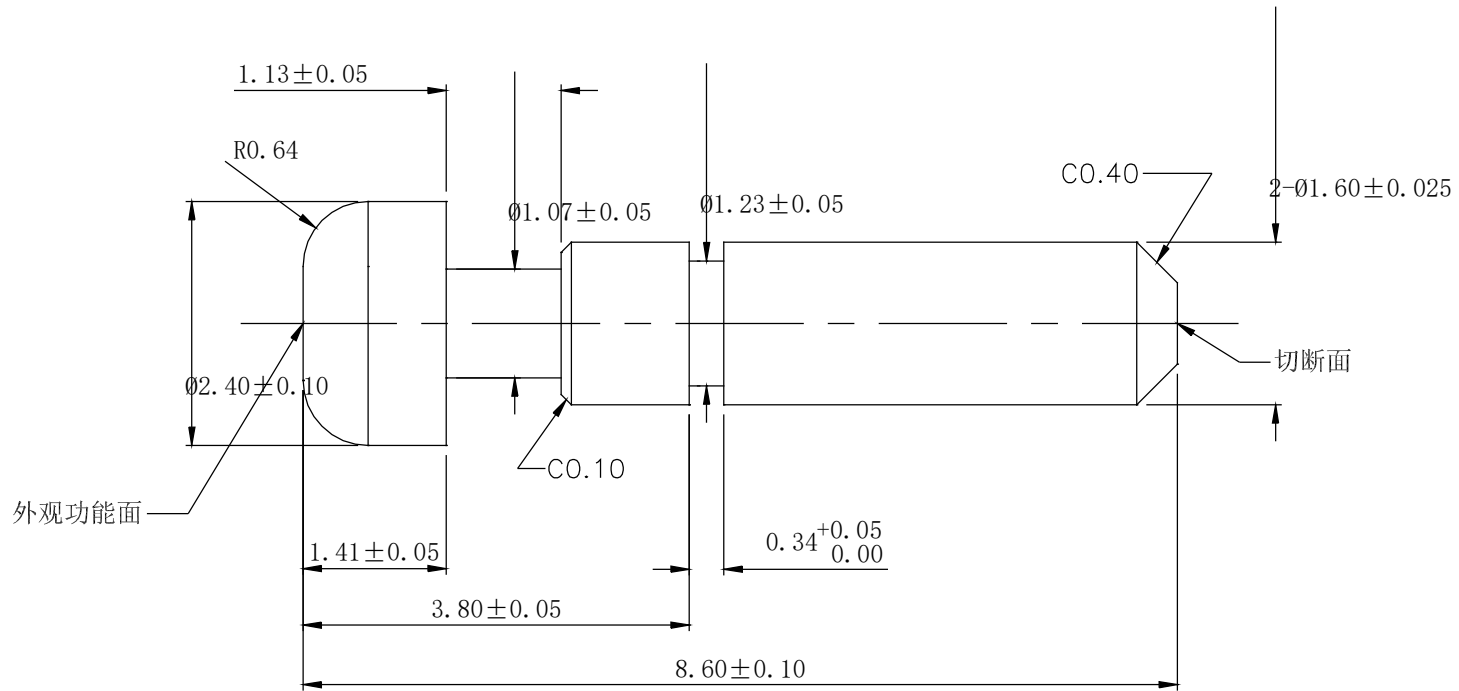

NOTE:

- Material
Pin: Brass
- Plating
Pin: 30 micro-inch Min. Au over 50~100 micro-inch nickel.
- Electrical
Rated current & voltage: DC 12V; 2A.
- Harmful material control please follow DOC. NO."DQ03050".

| | | | | | | | |
|--|------------|------------|------------|--|-----|---|---------------|
| DRAWN (设计) | nielaiding | SCALE (比例) | 15 : 1 | UNIT (单位) | mm | DRAWING NO. (图号) | HCS0586SM02-B |
| CHECKED (确认) | | SHEET (页数) | 1 of 1 | PROJECT (视图) | | TITLE (品名) | PIN |
| APPROVED (核准) | | DATE (日期) | 2015.09.07 | VER. (版本) | A.0 | | |
| THE UNMARKED TOLERANCE ARE AS BELOW : (未标记的公差) LENGTH (尺寸) | | | | ANGLE (角度) | | C.C.P. (DG) CONTACT PROBES CO.,LTD. 东莞中探探针有限公司 | |
| 0~6.0 | ±0.05mm | 0. | ±2.0° | The information in this document is property of C.C.P company and should not be copied or reproduced in any other way, without written permission. | | | |
| >6~30 | ±0.10mm | 0.0 | ±1.0° | | | | |
| >30~120 | ±0.15mm | 0.00 | ±0.50° | | | | |