

Pogo Pin Connectors

Single Pins
Connector Modules
Customized Connectors



C.C.P. CONTACT PROBES

TABLE OF CONTENT

01

04

08

10

14

15

16

17

18

19

20

22

28

51

52

55

56

57

58

59

About CCP Contact Probes

Pogo Pin Introduction

CCP Plating Technology

Pogo Pin Application

Waterproof Connector

Ball Point Connector

Screw Pin

Magnetic Connector

High Current Pin

Ultra Small Pin

Standard Connecotor

Single Pin

Non Standard Connector

Ball Point Connector

Waterproof Connector

Magnetic Connector

High Current Pin

Double End Pin

Ultra Small Pin

Screw Pin

Product List

C.C.P. Contact Probes Co., Ltd. is a leading global manufacturer of Contact Probes, Pogo Pins, Testprobes, Springloaded Connectors, and Crown Spring Connectors.

In 1986 we began as a specialized provider of test probes and socket auxiliary solutions and slowly expanded our product portfolio in related industries such as electronic components manufacturing. Among our customers are renowned brands like Apple and Amazon and our products are revered by our customers for their exceptional reliability and superior quality.

Our research and development teams are continuously improving our existing products and bringing new innovations to the market to meet the growing demands of our clients. Since 2001 CCP Contact Probes has been a public traded company listed on the Taiwan Stock Exchange. Today CCP has subsidiaries in the United States, China, Germany, India, Japan and Singapore, meeting the needs of our customers around the world.

Selected Customers



Locations

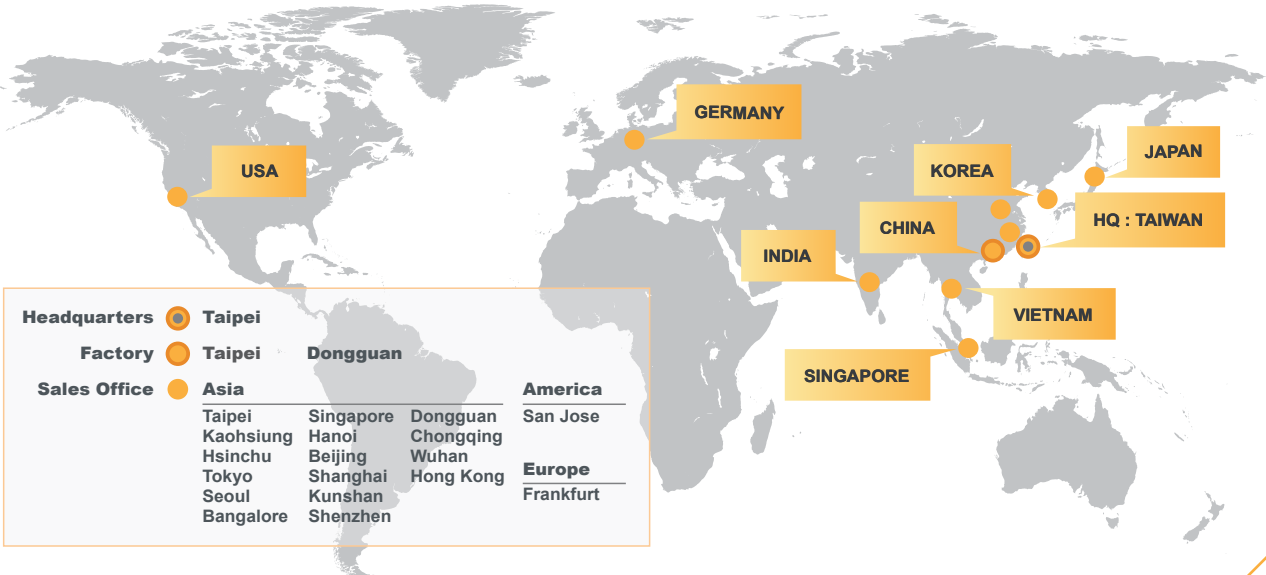

ABOUT US

Introduction

ABOUT US

History

History

2019	CCP Japan & Korea Established
2018	CCP Germany, Singapore & India Established
2016	High Current Connector Product Line
2014	CCP USA Established
2003	Listed on Taiwan Stock Market (TW. 6217)
2002	Commercial Connector Product Line
2001	CCP Dongguan Factory Established
1986	CCP Established/ Testing Product Line

Company Culture

	Yearly Home Visit
	Employee's Children Summer Camp
	Tuition Subsidy for Employee's Children

ABOUT US

Advantages



Over 30 Years of Product Development Experience
Servicing Industry-leading Clients

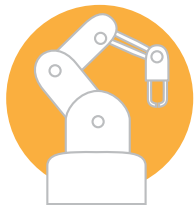

Agile and Flexible Design Process with Self-owned
Turning and Plating Factory



A Proven Track-record of Reliability, an Industry Certified Quality
Management System, and State-of-the-art Production Equipment

Product Lines

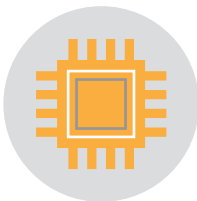

Testing
Solutions



Commercial
Connector Solutions



High Current
Connector Solutions



Industrial
Connector Solutions

POGO PIN INTRODUCTION

WHEN TO USE POGO PINS

Advantages

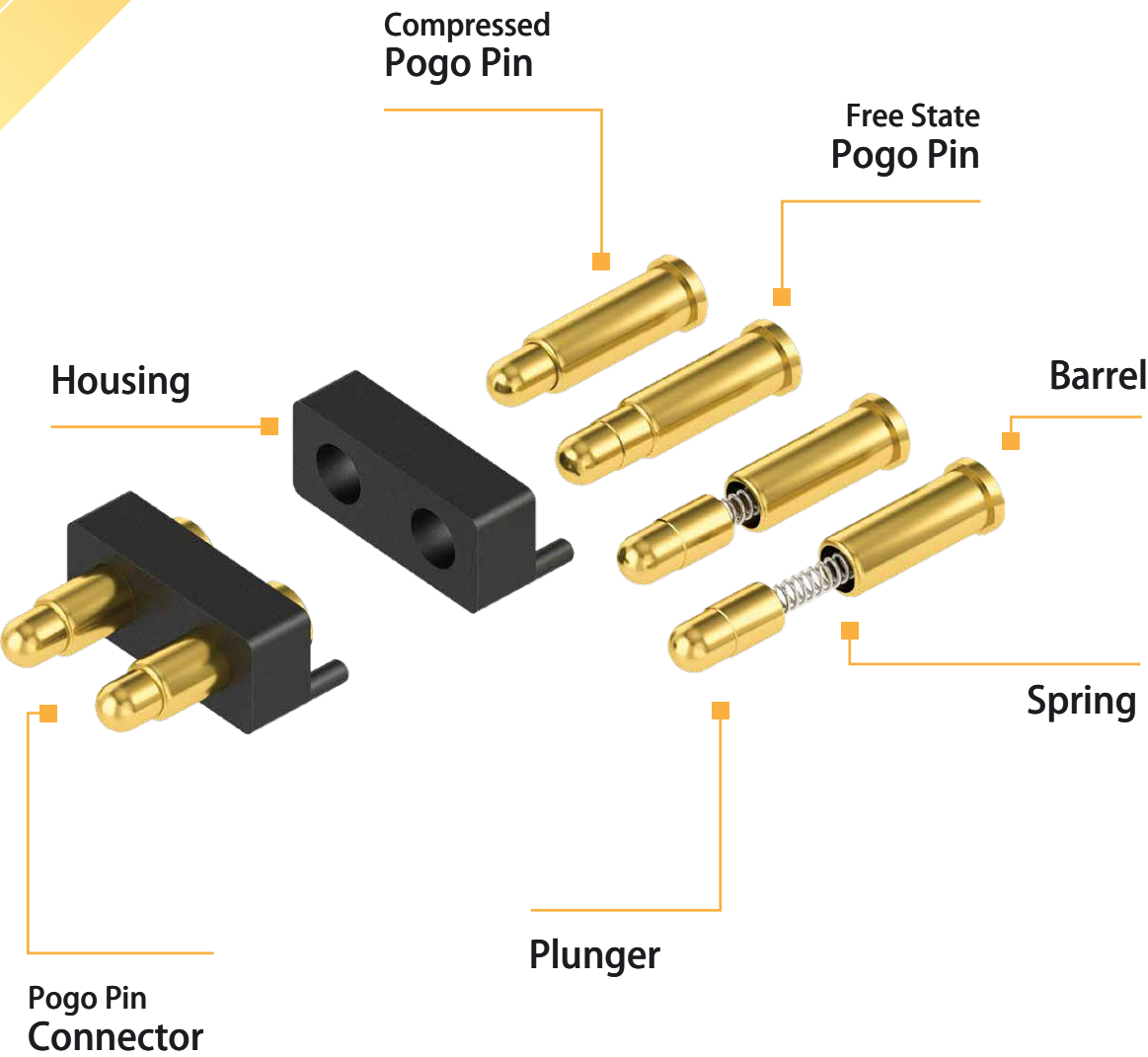

IMPROVED USER EXPERIENCE

Easy to plug-in, no accidental rip off of the cable.



STABLE CURRENT FLOW

Different pogo designs maximize the stability of the current flow, by increasing the number of contact points inside the pin.



SMALL VOLUMES POSSIBLE

Pogo pins are produced with high precision turning machines and don't require a mold as it is the case for other connectors that are using a stamping process.



LIMITED SPACE & HIGH CURRENT

The trend towards miniaturization in the electronics industry is continuing. No other connector has a better space to current ratio as a pogo pin.



SIMPLIFY ASSEMBLY AND SAVE COST

The complexity of today's electronics increases the assembly costs and difficulty significantly. Pogo pins not just reduce the manual labor time for inserting cables or pins, they also open up new design and arrangement options for industrial designers and engineers.



HIGH TOLERANCE

Small errors in the production often lead to unstable connectors as they are not properly touching the surface of their counterpart. Pogo pins allow extremely high tolerances in the production and thereby decreasing the likelihood for errors.



LONG LIFE-TIME

Pogo pins have a far superior life-time as compared to other connector types as they minimize the mechanical strain on the parts.

The current a pogo pin can carry depends largely on 3 factors:



Number of Contact Points

The ball design maximizes the number of contact points, thereby allowing a higher and more stable flow of current.



Spring Force

The higher the spring force, the better the plunger is pressed against the wall of the barrel, allowing a stable current flow.



Material

Different material types can heavily influence the conductivity of the pin, but also the roughness is important to increase the current flow.

BACK DRILL

The drilled plunger creates extra space for the spring and allowing shorter pogo pin designs.

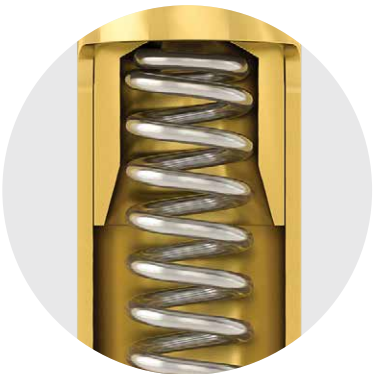

Pin Length: \approx 2.5 mm
Current: 1 A

BIAS TAIL

The biased tail of the plunger creates a lateral force and better contact.

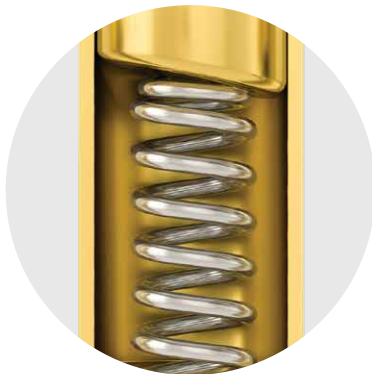

Pin Length: \approx 3.5 mm
Current: 2 A

BALL

The ball inside stabilizes the contacting areas for a better performance.



Pin Length: \approx 4.5 mm
Current: 3~5 A

Housing

Polyoxyethylen (Standard)
PBT Polybutylene terephthalate
LCP Liquid-crystal polymers
HTN Polyphthalamide
PA10T

Ball

Stainless Steel

Plunger

Brass (Standard)
Beryllium Copper
Phosphor Bronze
SK4

Surface Plating
Base Plating
Base

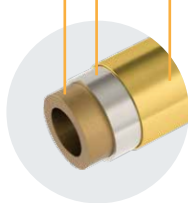

Spring

Stainless Steel

Barrel

Brass (Standard)
Beryllium Copper
Phosphor Bronze

When should you use which surface plating?

Plating	Hardness (HV)	Function	Color
Gold	200	Low resistance	Gold
Super AP	400	Superior corrosion resistance, low electrical resistance	Silver
Nickel	150-200	Low cost, corrosion resistant	Silver
Palladium-Nickel	330-380	Improved signal transmission	Silver
Red Brass (CuSnZn)	600	Replace Nickel	Silver
Palladium Cobalt	450-600	Replace Pd-Ni	Silver
Palladium Cobalt	600-800	Black color requirement	Black

CCP PLATING TECHNOLOGY

Industry-Leading Anti-Corrosion

CCP's Super AP plating is the gold-standard of the industry. Its superior composition makes it extremely resistant to electrolytic corrosion while maintaining a very low resistance. The perfect solution for any kind electrical application.

2X

NaCl

more resistant to Salt Spray

5X



more resistant to Artificial Perspiration

30X



more resistant to Electrolysis



Nickel-Free

Comparison of Gold and Super AP Plating:



CCP PLATING TECHNOLOGY

Industry-Leading Anti-Corrosion

Understanding Galvanic Corrosion:

Galvanic corrosion occurs, when two different metals of different nobility get into close contact in the presence of an electrolyte such as water. Dissimilar metals have different electrode potentials which cause one of the metals to act as a cathode and the other as an anode. The resulting current flow is the main cause for the corrosion of the lesser noble (anode) metal. Acid or alkali environments, for example on human skin, can accelerate galvanic corrosion significantly and attack even metals such as gold and plating.

Plating	Testing standard	Au(50u") Layer	APII Layer	Super AP Layer
Nickel Release	EN 12472:2005+A1:2009	Nickel-containing process	Nickel-free process	Nickel-free process
Contact Resistance (mΩ)	EIA-364-23	< 50	< 50	< 50
Salt Spray Resistance (HR)	EIA-362-26	96	96	168
Artificial Sweat Resistance (HR)	ISO-3160	96	96	168
Surface Hardness (HV)	ISO 6507-1:2005	200	400	400
Electrolysis Resistance Time	1mA, 5V, Pitch=0.60mm	<1 Min	15 Min	60 Min

POGO PIN APPLICATIONS

Spring loaded connectors can be used for a wide variety of applications. Their versatility make them true allrounders, from charging applications to high frequency signal transmission.

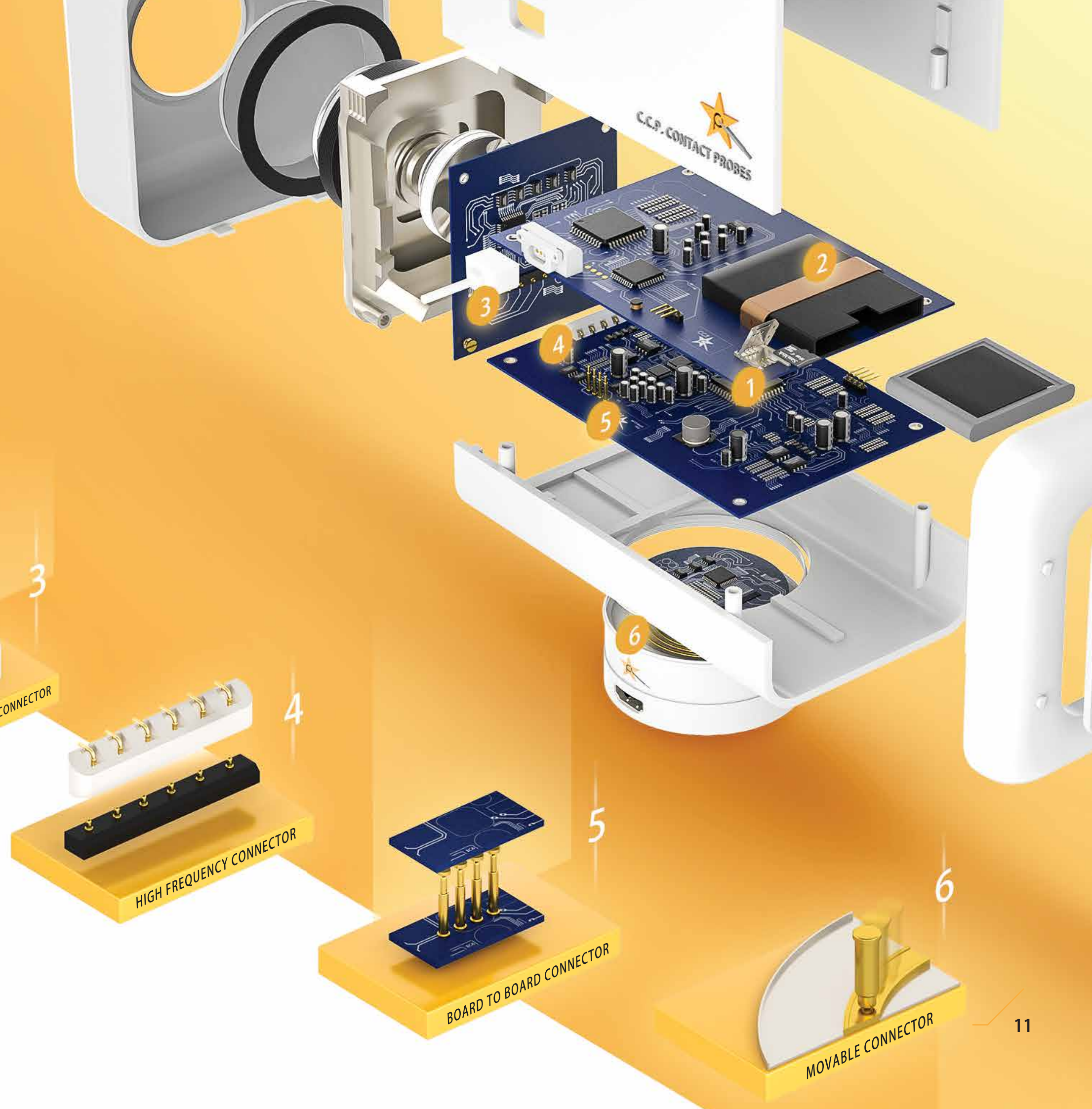

ENTERTAINMENT

- Smart Toys
- Game Consoles
- Audio Equipment

MEDICAL

- CPI Dockings
- Skin Lasers
- Inhalation Machines
- Pregnancy Monitors

SECURITY

- Smart Locks
- CCTV Cameras
- Smoke Detectors

HOUSEHOLD

- Dish Washers
- Home Pods
- Vacuum Cleaners
- Hair Dryers
- Air Purifiers
- Water Cookers

INDUSTRIAL

- Robotic Arms
- Docking Stations
- Rugged Devices
- Printers

RETAIL

- Barcode Scanners
- Smart Price Tags
- POS Systems (Point of sale)
- Credit Card Readers

PERSONAL

- Laptops
- Smartphones
- E-Cigarettes
- Smart Watches
- Ear Pods
- Cameras
- Hearing Aids

TRANSPORTATION

- Car Keys
- Navigation Systems
- Board Electronics
- Airplane Entertainment Systems

WATERPROOF CONNECTORS

O-RING
Waterproof: IPx8 at best

SEALING
Waterproof: IPx7 at best

INSERT MOLDING
Waterproof: IPx7 at best
No SMT Process Possible

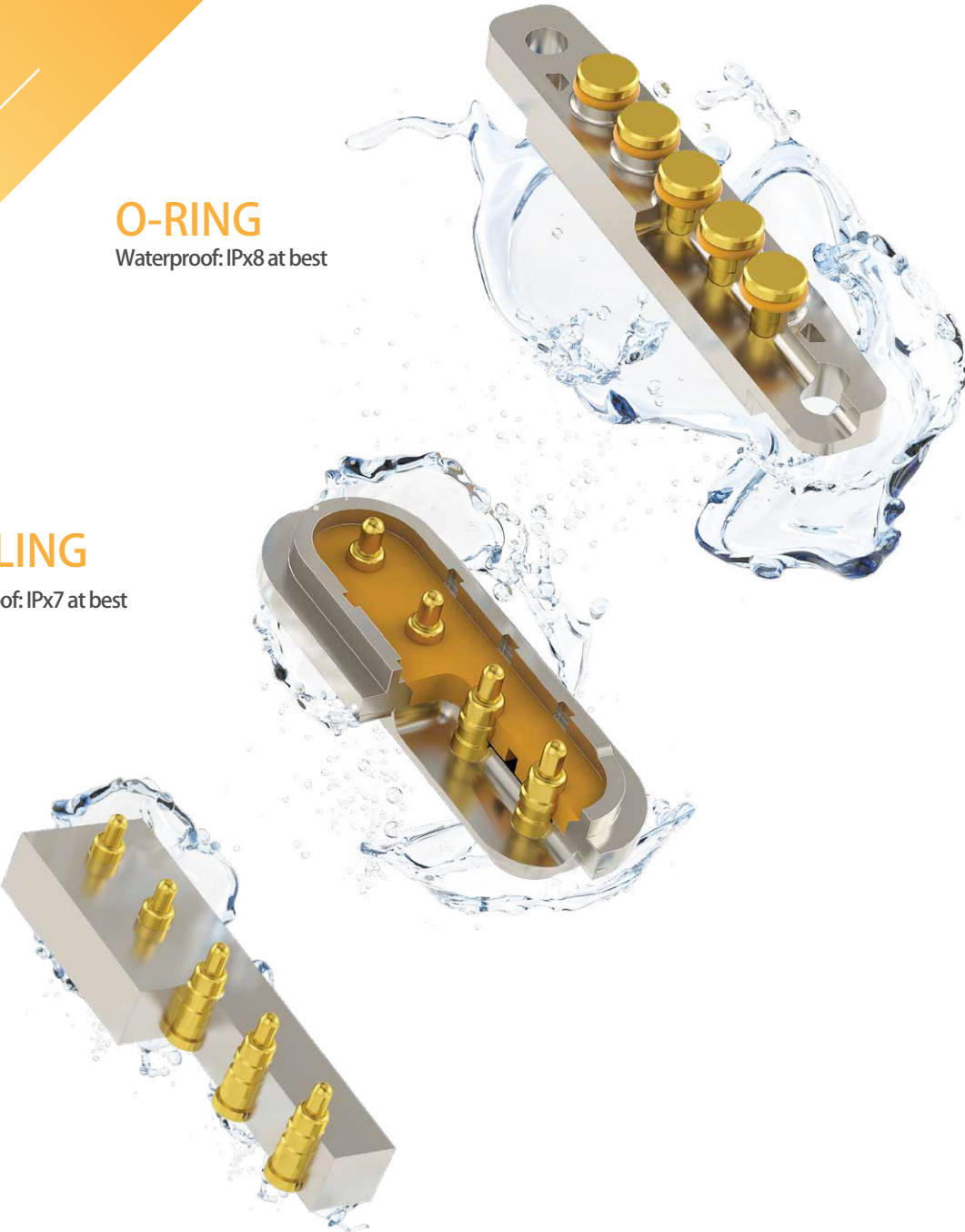

DOES WATER HARM POGO PINS?

CCP's waterproof pogo pin connectors are designed to withstand any long and short term submersion in water. For very challenging environments we recommend our SuperAP Plating which can withstand the effects of Galvanic Corrosion up to 60 times longer.

BALL POINT CONNECTOR

Keeping a stable connection to a moving target can be a challenge, as constant strain on the components can result in degradation of the materials and in worst case to a malfunction. The Ball-Point Connector solves this problem by a radically new design that offers totally new engineering possibilities and a simplified assembly without cables.



Diameter	Current	Durability
Min 0.6 mm	1A - 5A	Min 10'000 Compressions
Spring Force	Contact Resistance	Travel Distance
145g ± 20g	30 mΩ — 100 mΩ	Up to 25 km

SCREW PINS

CCP's Screw Pin design is a smart way to utilize a pogo pin as a connector as well as a mounting part, reducing the assembly cost significantly and opening new design possibilities for industrial engineers.

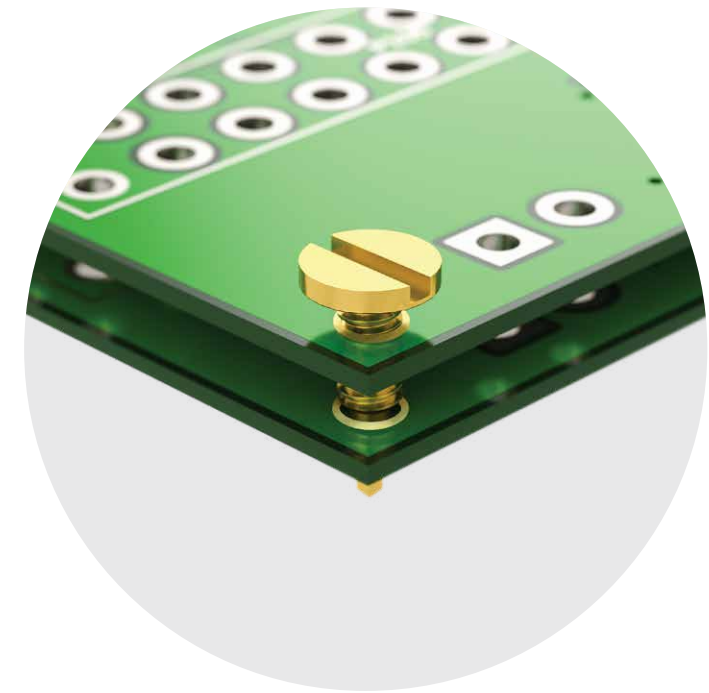
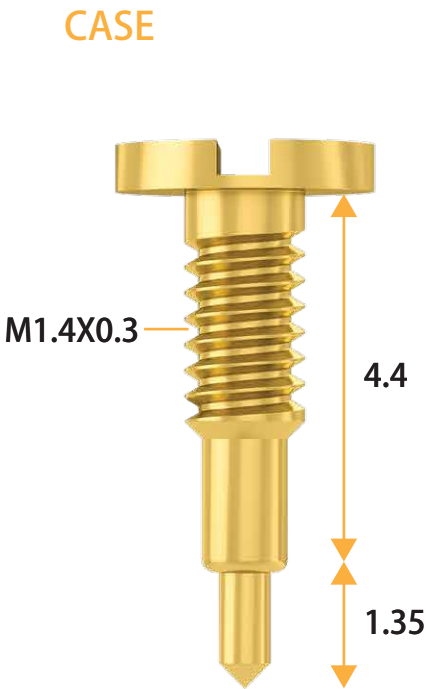

Diameter	Current	Durability
3 mm	1A	10,000 compressions
Spring Force	Contact Resistance	
120g ± 20g	200 mΩ	

MAGNETIC CONNECTORS

● Magnet ● Plastic Housing ● Pogo Pin

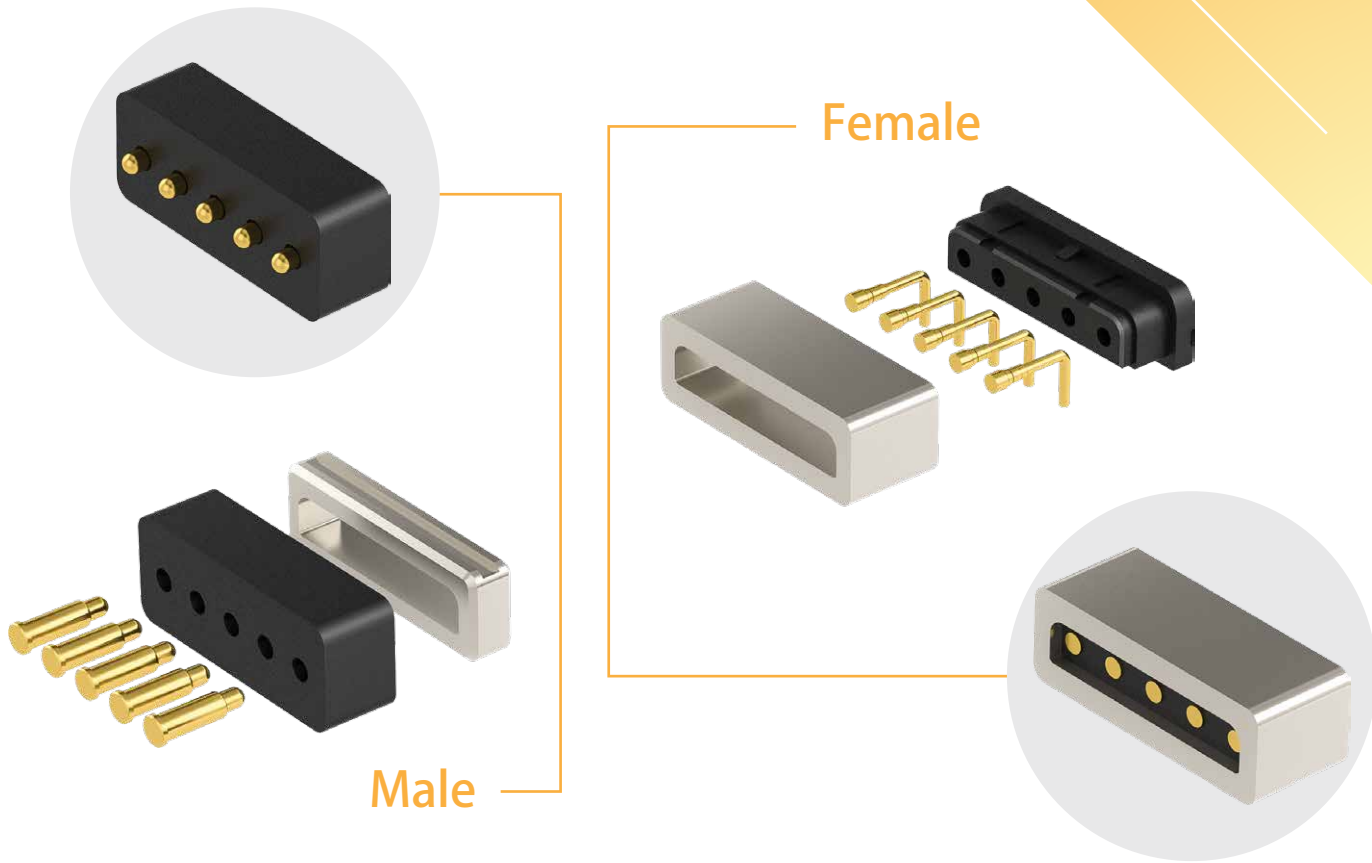

Easy to plug
Very durable

No accidental breaking
Suitable for high frequency transmission

Assembly Options		
Metal injection molded housing	Two magnets	One magnet to metal

HIGH CURRENT PINS

CCP's new high current designs takes Pogo Pins to a new level that is second to none in the industry.

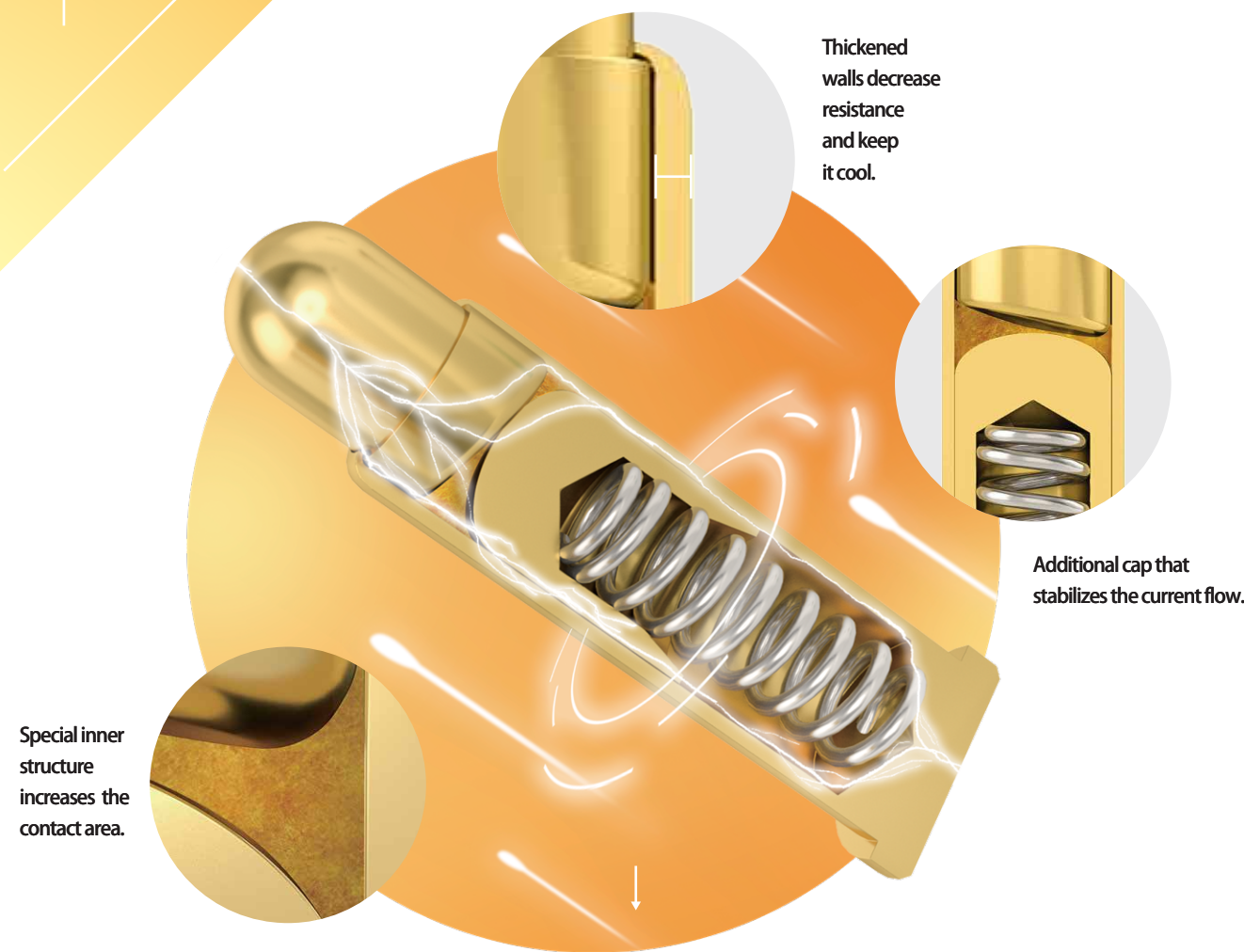

Diameter		Current	Durability
2.4 mm		13A	10,000 compressions
Spring Force		Contact Resistance	
120g ± 20g		30 mΩ	

ULTRA SMALL PINS

Meet the smallest bias-cut pogo pin on the market today making even the most compact designs possible. The pin is so small, that you could fit over 100 pins on the tip of your finger.

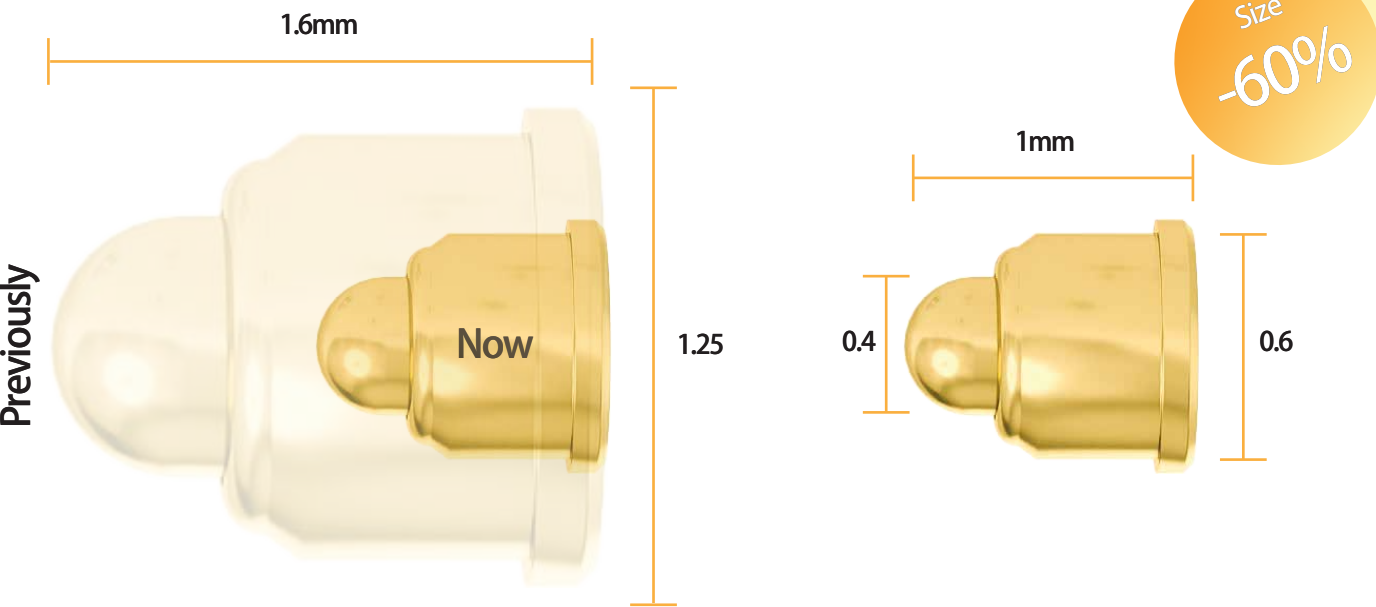
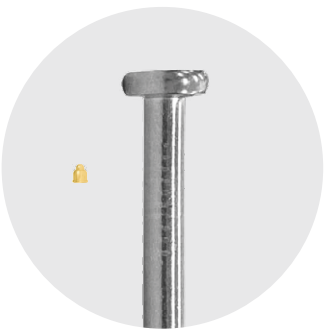

Diameter		Current	Durability
0.6 mm		1A	3,000 compressions
Spring Force		Contact Resistance	
25 g		175 mΩ	

STANDARD PINS

2.54mm Pitch

The Standard Connector Series aims to offer a comprehensive selection of internationally compatible connectors. Its smart design and simple structure makes it very cost effective even at small volumes.

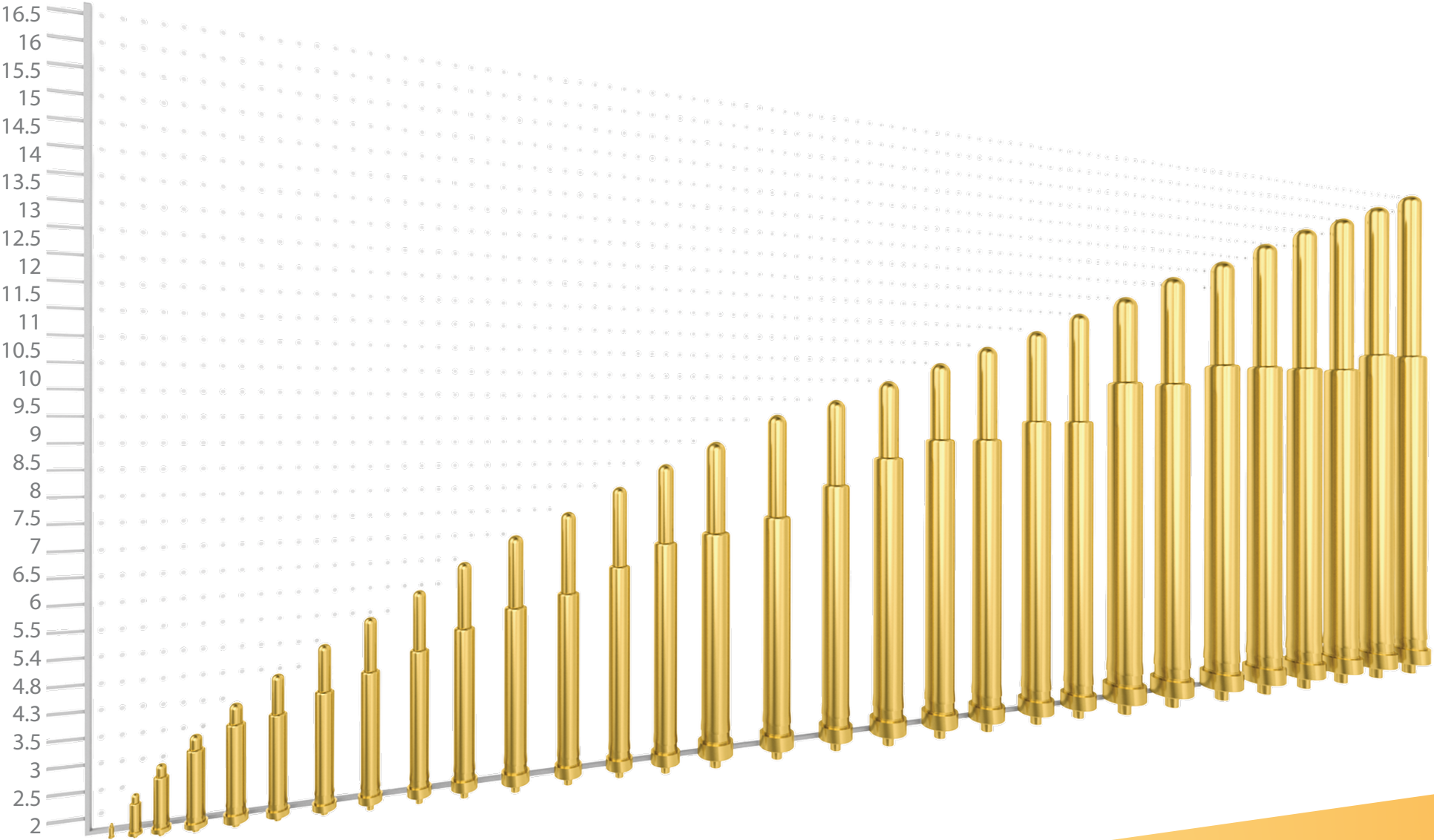

Modular Housing:

Available from 1-20 columns and up to 4 rows.

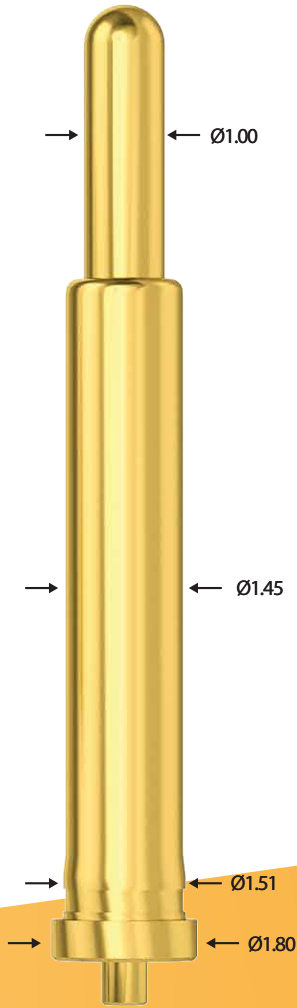
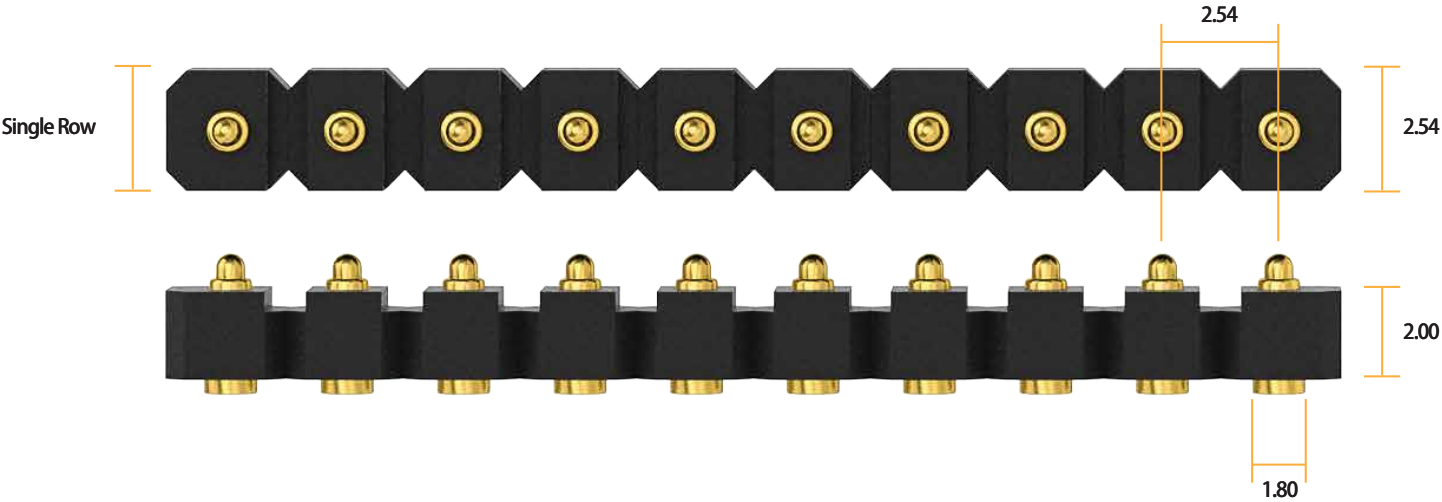

Technical Specs:

Available Spring Force: 30g, 60g and 100g
Current Rating: 1-5 Amps
Durability: 100.000 Life Cycles
Pitch: 2mm, 2.5mm or/and 2.54mm
Diameter: 1.3 and 1.45
Tail: No Tail and Tailed Versions

SINGLE PIN

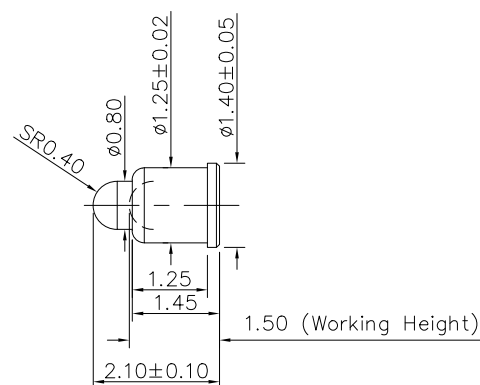

PN: H199M2-R

Length: 2.10 mm
Working Height: 1.50 mm
Current: 1 Amp
Contact Resistance: 100 mΩ
Spring Force: 100g±20%

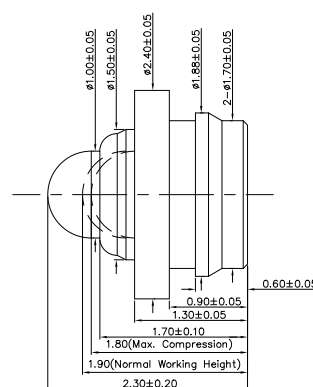

PN: P5271FP04

Length: 2.30 mm
Working Height: 1.90 mm
Current: 1 Amp
Contact Resistance: 100 mΩ
Spring Force: 80g±20g

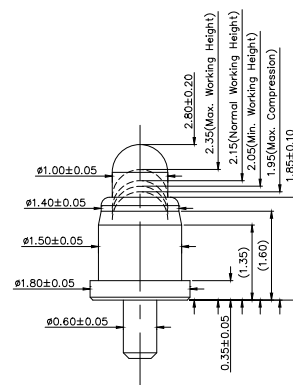

PN: P5625MF01-01A000CR

Length: 2.80 mm
Working Height: 2.15 mm
Current: 1 Amp
Contact Resistance: 100 mΩ
Spring Force: 40g±15g

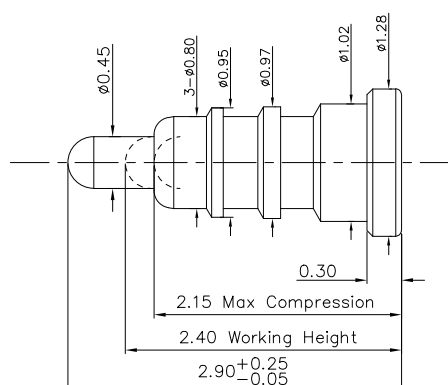

PN: P2988FH03

Length: 2.90 mm
Working Height: 2.40 mm
Current: 1 Amp
Contact Resistance: 50 mΩ
Spring Force: 60g±20g

SINGLE PIN

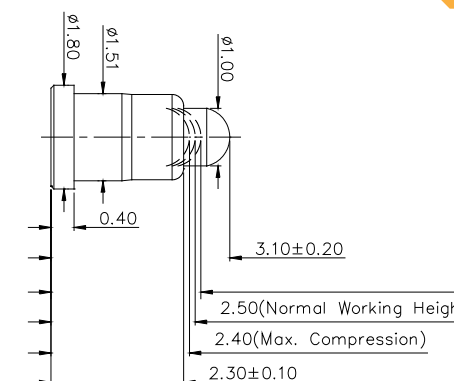

PN: P3198FH01

Length: 3.10 mm
Working Height: 2.50 mm
Current: 1 Amp
Contact Resistance: 50 mΩ
Spring Force: 80g±20g

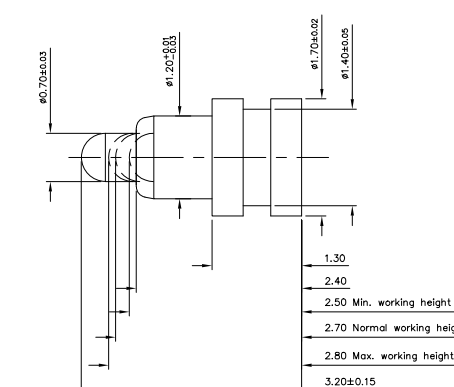

PN: P2616FH03

Length: 3.20 mm
Working Height: 2.70 mm
Current: 1.5 Amps
Contact Resistance: 50 mΩ
Spring Force: 80g±20g

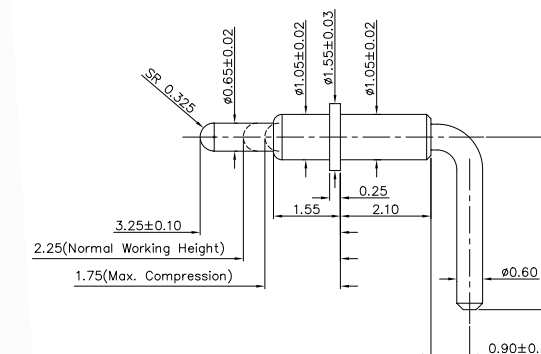

PN: P3533BP02

Length: 3.25 mm
Working Height: 2.25 mm
Current: 1 Amp
Contact Resistance: 50 mΩ
Spring Force: 80g±20g

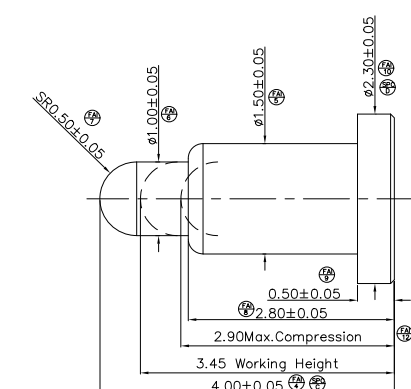

PN: P3775FH01

Length: 4.00 mm
Working Height: 3.45 mm
Current: 1 Amp
Contact Resistance: 200 mΩ
Spring Force: 45g±10g

SINGLE PIN

■

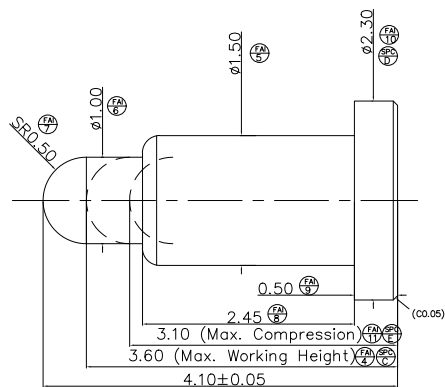

PN: P5067FP01-R

- Length: 4.10 mm
- Working Height: 3.60 mm
- Current: 1 Amp
- Contact Resistance: 100 m Ω
- Spring Force: 100g \pm 20%

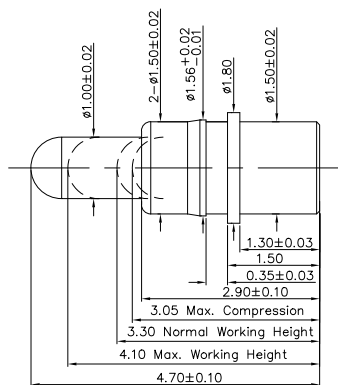

PN: P3697PP01

- Length: 4.70 mm
- Working Height: 3.30 mm
- Current: 1 Amp
- Contact Resistance: 100 m Ω
- Spring Force: 60g \pm 20g

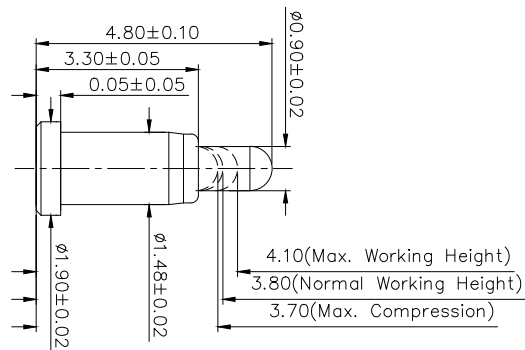

PN: P5660MF03-01A000CR

- Length: 4.80 mm
- Working Height: 3.80 mm
- Current: 1 Amp
- Contact Resistance: 50 m Ω
- Spring Force: 70g \pm 20g

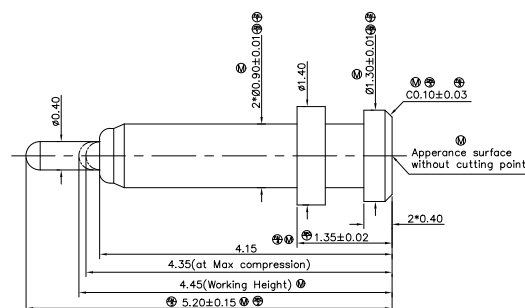

PN: P3989FH01

- Length: 5.20 mm
- Working Height: 4.45 mm
- Current: 1 Amp
- Contact Resistance: 50 m Ω
- Spring Force: 65g \pm 15%

SINGLE PIN

■

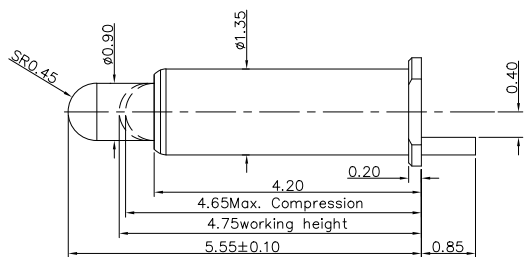

PN: P3730SH02

- Length: 5.50 mm
- Working Height: 4.75 mm
- Current: 5 Amps
- Contact Resistance: 50 m Ω
- Spring Force: 100g \pm 20%

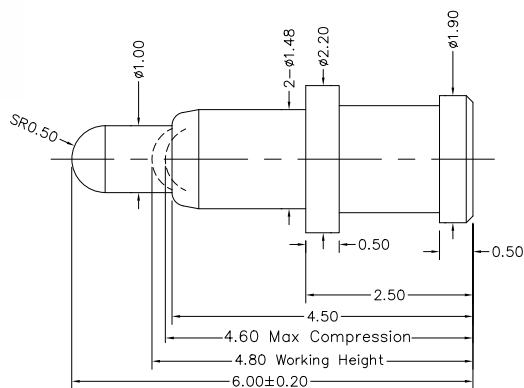

PN: P3256FH01

- Length: 6.00 mm
- Working Height: 4.80 mm
- Current: 1 Amp
- Contact Resistance: 50 m Ω
- Spring Force: 120g \pm 20g

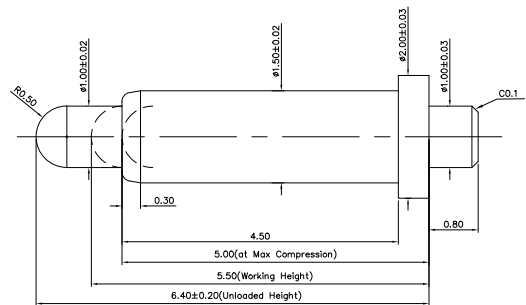

PN: H024M0

- Length: 6.40 mm
- Working Height: 5.50 mm
- Current: 1 Amp
- Contact Resistance: 50 m Ω
- Spring Force: 100g \pm 20%

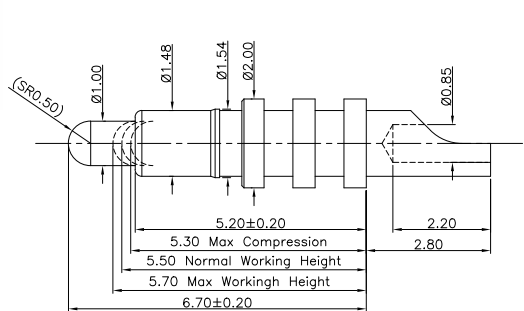

PN: P2859SH01

- Length: 6.70 mm
- Working Height: 5.50 mm
- Current: 5 Amps
- Contact Resistance: 50 m Ω
- Spring Force: 110g \pm 20%

SINGLE PIN

SINGLE PIN

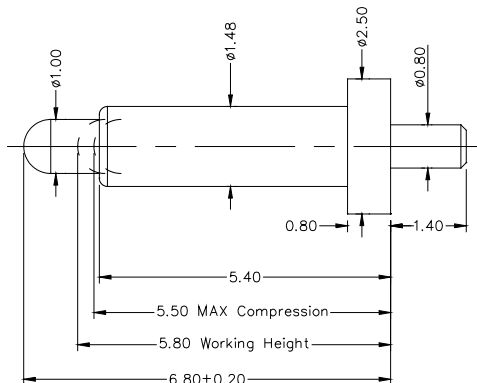

PN: P2871PH01

Length: 6.80 mm
Working Height: 5.80 mm
Current: 3 Amps
Contact Resistance: 50 mΩ
Spring Force: 110g ± 20%

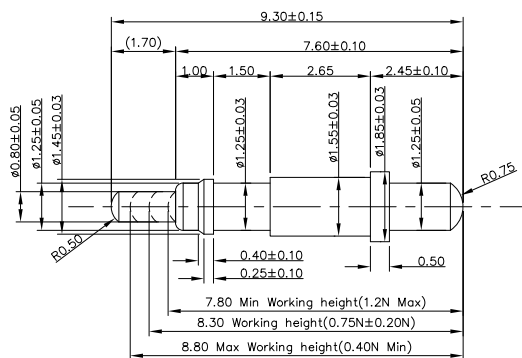

PN: P2631PH03

Length: 9.30 mm
Working Height: 8.30 mm
Current: 2 Amps
Contact Resistance: 100 mΩ
Spring Force: 80g ± 20g

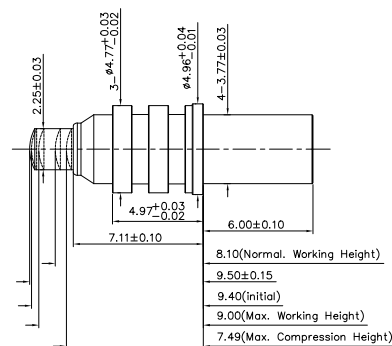

PN: P6123PH03

Length: 9.50 mm
Working Height: 8.10 mm
Current: 5 Amps
Contact Resistance: 50 mΩ
Spring Force: 180g ± 20%

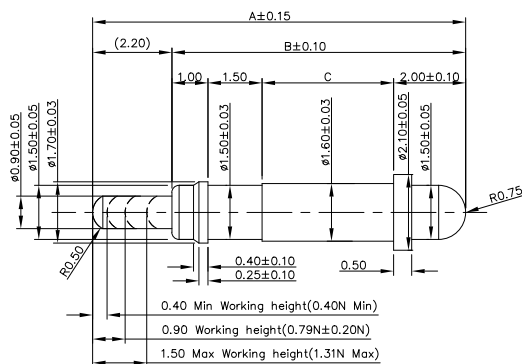

PN: P2683PH09

Length: 10.05 mm
Working Height: 0.90 mm
Current: 2 Amps
Contact Resistance: 50 mΩ
Spring Force: 60g ± 20g

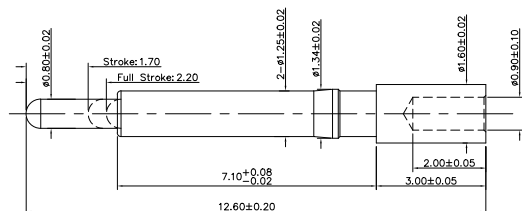

PN: P5773PH02

Length: 12.60 mm
Working Height: 2.20 mm
Current: 1 Amp
Contact Resistance: 100 mΩ
Spring Force: 80g ± 20g

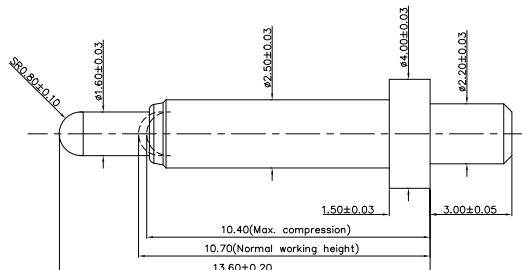

PN: P2783PH01

Length: 13.60 mm
Working Height: 10.70 mm
Current: 5 Amps
Contact Resistance: 50 mΩ
Spring Force: 90g ± 20g

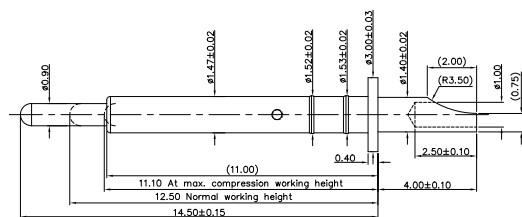

PN: P3737SH01

Length: 14.50 mm
Working Height: 12.50 mm
Current: 2 Amps
Contact Resistance: 50 mΩ
Spring Force: 100g ± 20%

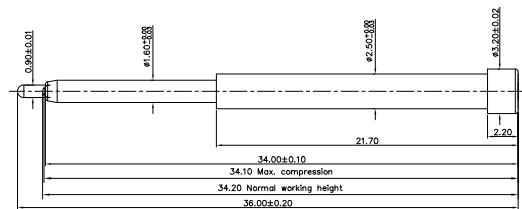

PN: P2977FH01

Length: 36.00 mm
Working Height: 34.20 mm
Current: 1 Amp
Contact Resistance: 50 mΩ
Spring Force: 100g ± 20%

NON STANDARD CONNECTOR

2 PINS

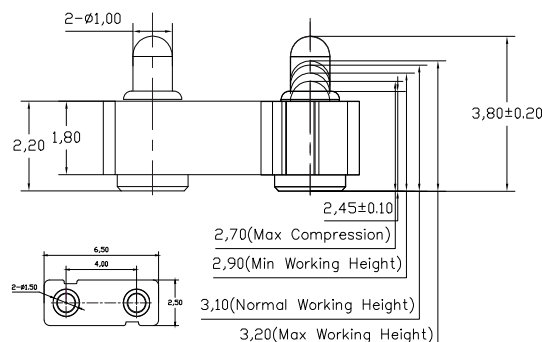

PN: F1106AA01-02A400MR

Length: 3.80 mm
Working Height: 3.10 mm
Pitch: 4.00 mm
Current: 1 Amps
Contact Resistance: 100 mΩ
Spring Force: 90g ± 20%

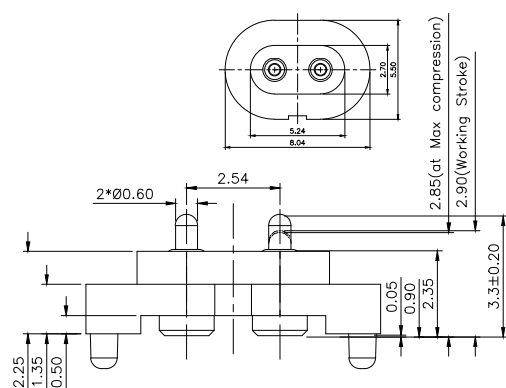

PN: P3013MF01-02F254MR

Length: 3.30 mm
Working Height: 2.90 mm
Pitch: 2.54 mm
Current: 1 Amp
Contact Resistance: 50 mΩ
Spring Force: 100g ± 20g

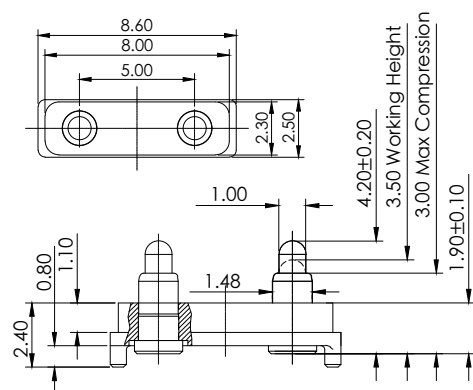

PN: F969AA01-02A500MR

Length: 4.20 mm
Working Height: 3.50 mm
Pitch: 5.00 mm
Current: 1 Amp
Contact Resistance: 50 mΩ
Spring Force: 100g ± 20%

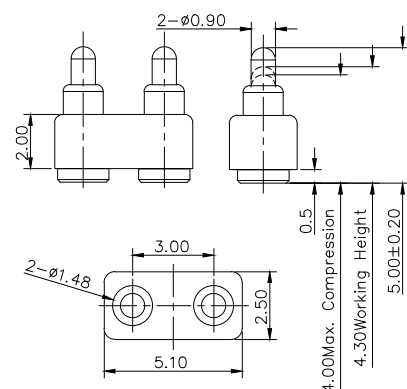

PN: P3708MF01-02F300MR

Length: 5.00 mm
Working Height: 4.30 mm
Pitch: 3.00 mm
Current: 1 Amp
Contact Resistance: 50 mΩ
Spring Force: 60g ± 20g

NON STANDARD CONNECTOR

2 PINS

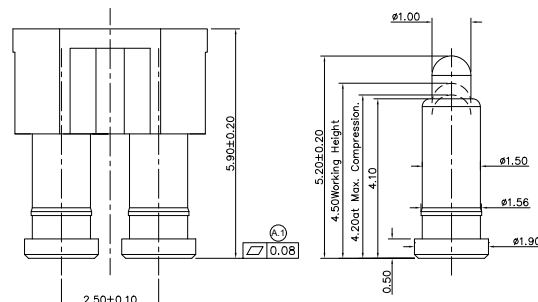

PN: F1835AA01-02A250CR

Length: 5.20 mm
Working Height: 4.50 mm
Pitch: 2.50 mm
Current: 1 Amp
Contact Resistance: 100 mΩ
Spring Force: 60g ± 20g

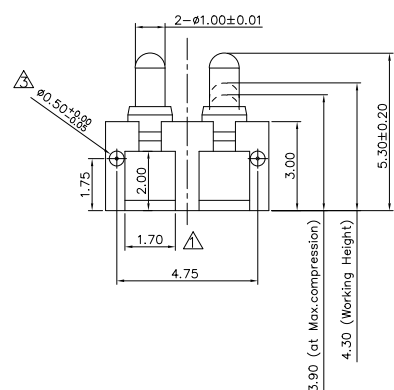

PN: H020M0-H02B250R

Length: 5.30 mm
Working Height: 4.30 mm
Pitch: 2.50 mm
Current: 2.5 Amps
Contact Resistance: 100 mΩ
Spring Force: 120g ± 20%

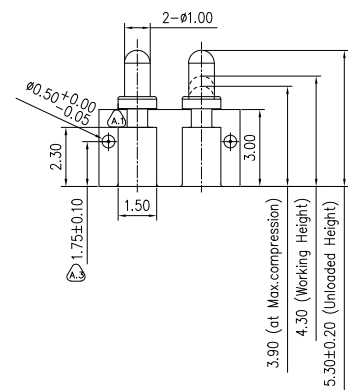

PN: H036M0-H02C250R

Length: 5.30 mm
Working Height: 4.30 mm
Pitch: 2.50 mm
Current: 1 Amp
Contact Resistance: 50 mΩ
Spring Force: 120g ± 20%

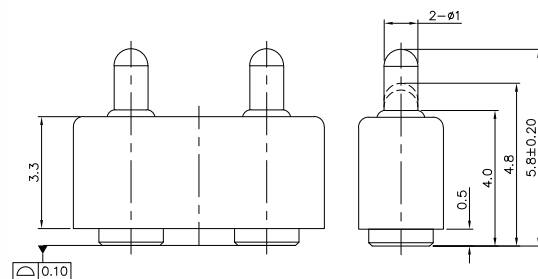

PN: N005M4-02A400HR

Length: 5.80 mm
Working Height: 4.80 mm
Pitch: 4.00 mm
Current: 1 Amp
Contact Resistance: 50 mΩ
Spring Force: 110g ± 20%

NON STANDARD CONNECTOR

2 PINS

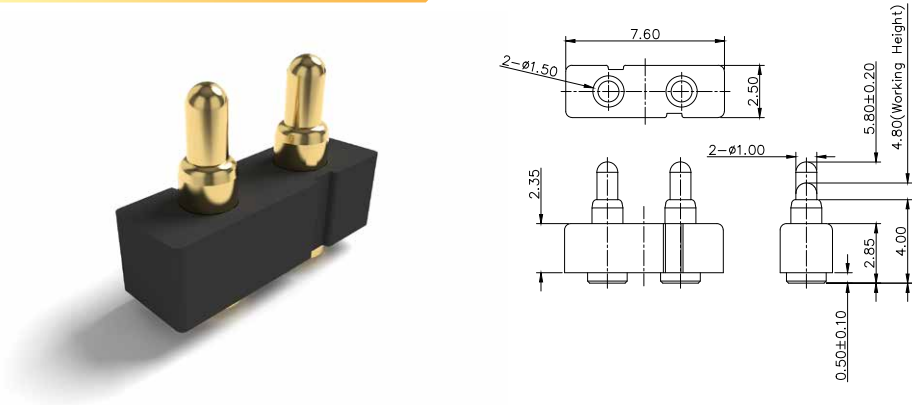

PN: N005M4-02C350MR

Length: 5.80 mm
Working Height: 4.80 mm
Pitch: 3.50 mm
Current: 1 Amp
Contact Resistance: 50 mΩ
Spring Force: 110g ± 20%

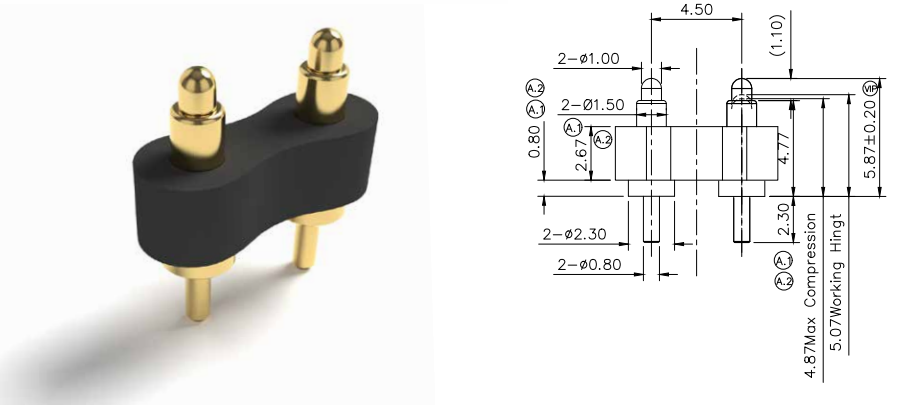

PN: P2688MP01-02G450MR

Length: 5.87 mm
Working Height: 5.07 mm
Pitch: 4.50 mm
Current: 1 Amp
Contact Resistance: 50 mΩ
Spring Force: 110g ± 20%

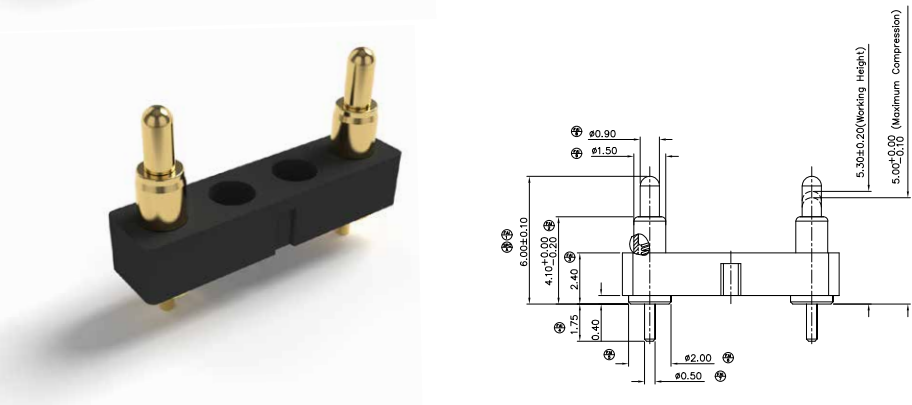

PN: P3721MP01-02A762HR

Length: 6.00 mm
Working Height: 5.30 mm
Pitch: 2.54 mm
Current: 2.5 Amps
Contact Resistance: 30 mΩ
Spring Force: 50g ± 20%

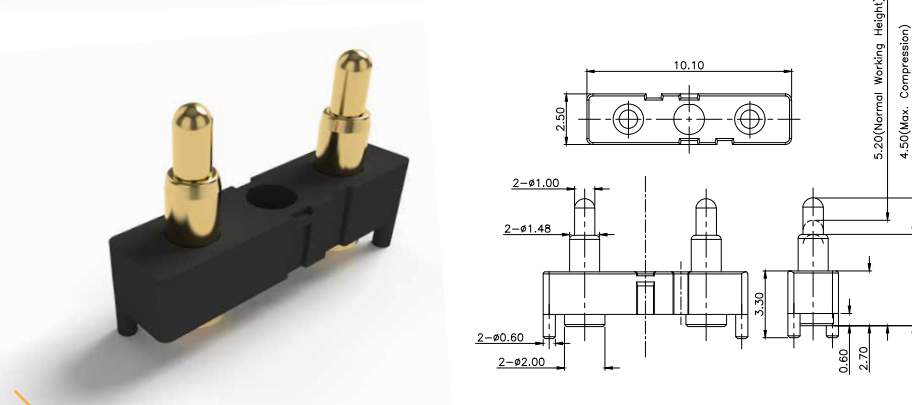

PN: P3037MF01-03A300HB

Length: 6.30 mm
Working Height: 5.20 mm
Pitch: 6.00 mm
Current: 1 Amp
Contact Resistance: 50 mΩ
Spring Force: 110g ± 20%

NON STANDARD CONNECTOR

2 PINS

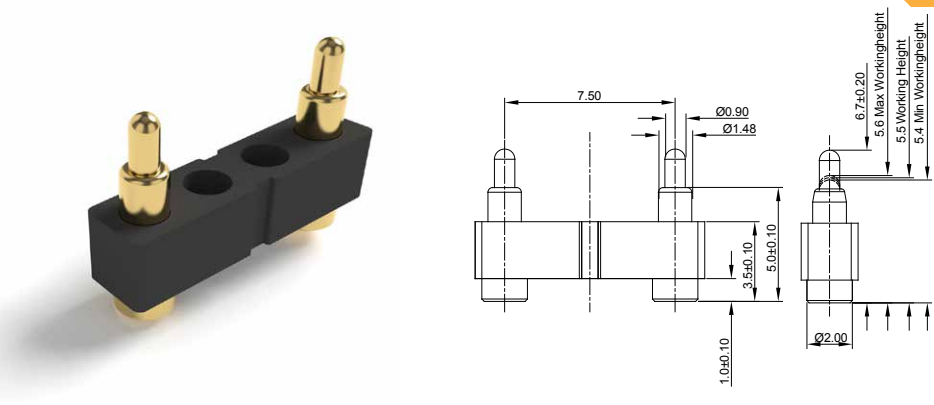

PN: F1615AA02-04B250MR

Length: 6.70 mm
Working Height: 5.50 mm
Pitch: 7.50 mm
Current: 1 Amp
Contact Resistance: 50 mΩ
Spring Force: 110g ± 20%

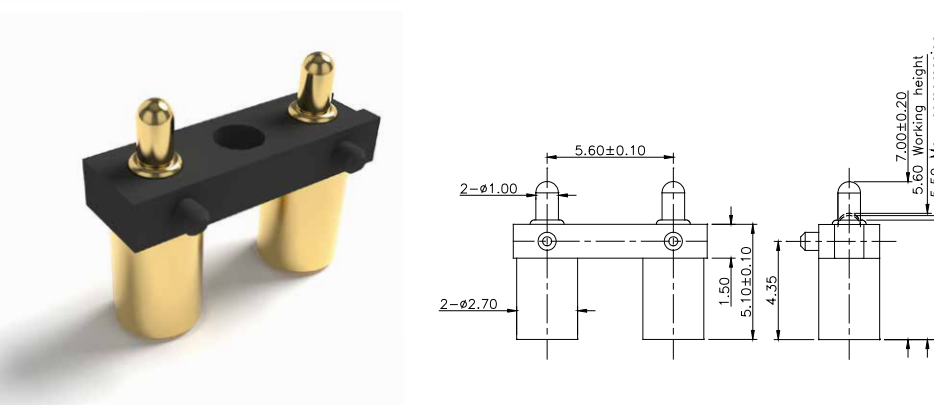

PN: P2723MF01-03B280HB

Length: 7.00 mm
Working Height: 5.60 mm
Pitch: 5.60 mm
Current: 3 Amps
Contact Resistance: 50 mΩ
Spring Force: 130g ± 25%

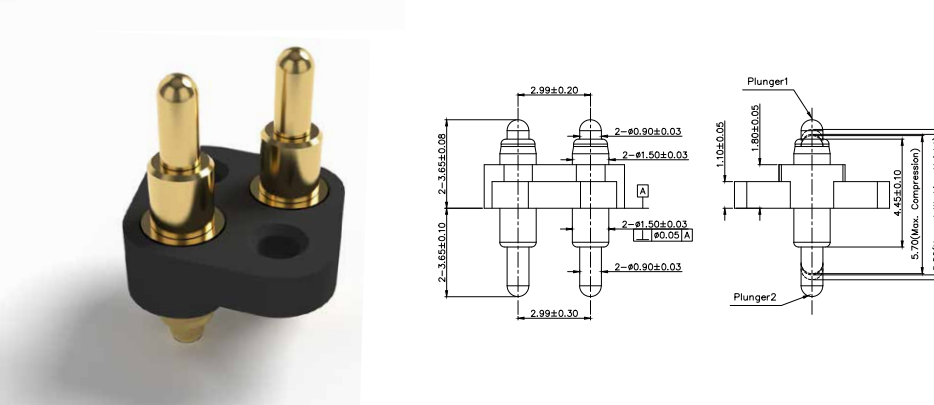

PN: P5121MD10-02A324HB

Length: 7.30 mm
Working Height: 5.80 mm
Pitch: 2.99 mm
Current: 2 Amps
Contact Resistance: 50 mΩ
Spring Force: 85g ± 15g

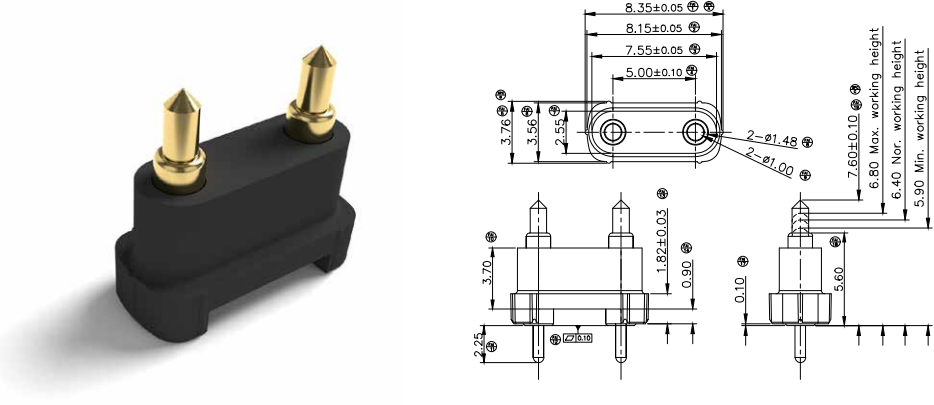

PN: P2388MP10-02G500HR

Length: 7.60 mm
Working Height: 6.40 mm
Pitch: 5.00 mm
Current: 1 Amp
Contact Resistance: 50 mΩ
Spring Force: 120g ± 20%

NON STANDARD CONNECTOR

2 PINS

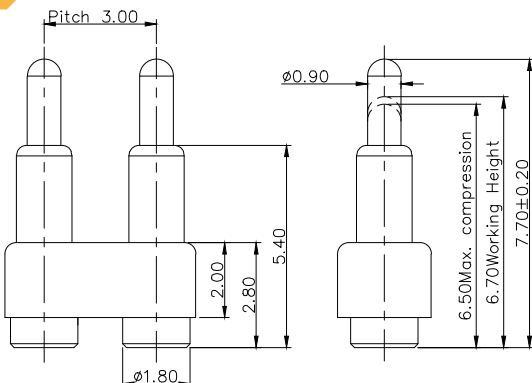
PN: F259AA02-02300MR

- Length: 7.70 mm
- Working Height: 6.70 mm
- Pitch: 3.00 mm
- Current: 1 Amp
- Contact Resistance: 50 mΩ
- Spring Force: 60g±20%

PN: N001M2-02D350MR

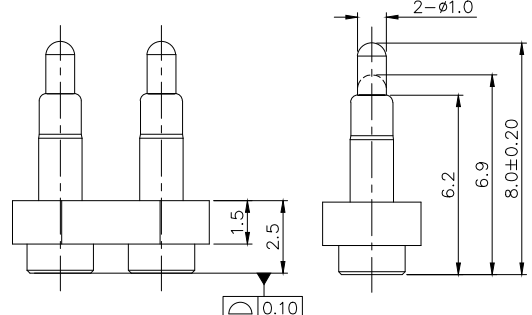
- Length: 8.00 mm
- Working Height: 6.90 mm
- Pitch: 3.50 mm
- Current: 1 Amp
- Contact Resistance: 50 mΩ
- Spring Force: 65g±20%

PN: H015M1-02D350MR

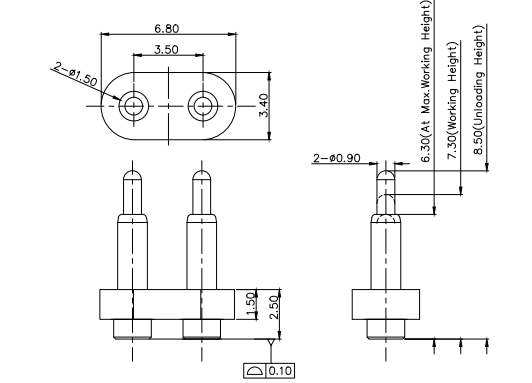
- Length: 8.50 mm
- Working Height: 7.30 mm
- Pitch: 3.50 mm
- Current: 1 Amp
- Contact Resistance: 50 mΩ
- Spring Force: 100g±20g



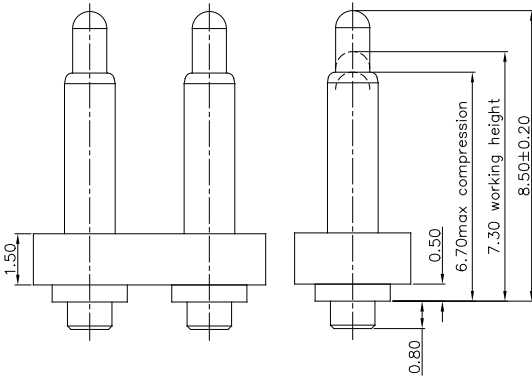

PN: P1089AA01-02D350MR

- Length: 8.50 mm
- Working Height: 7.30 mm
- Pitch: 3.50 mm
- Current: 1.5 Amps
- Contact Resistance: 50 mΩ
- Spring Force: 120g±20%

NON STANDARD CONNECTOR

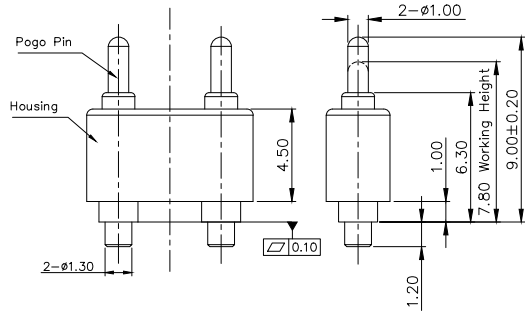
2 PINS

PN: N002M10-02B500HR

- Length: 9.00 mm
- Working Height: 7.80 mm
- Pitch: 5.00 mm
- Current: 1 Amp
- Contact Resistance: 50 mΩ
- Spring Force: 100g±20g



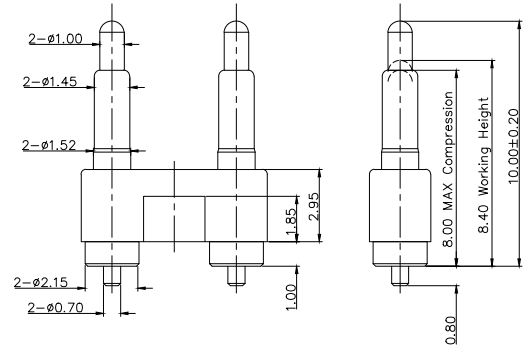

PN: P2780MF01-02A508MR

- Length: 10.00 mm
- Working Height: 8.40 mm
- Pitch: 5.08 mm
- Current: 1 Amp
- Contact Resistance: 50 mΩ
- Spring Force: 100g±20%

NON STANDARD CONNECTOR

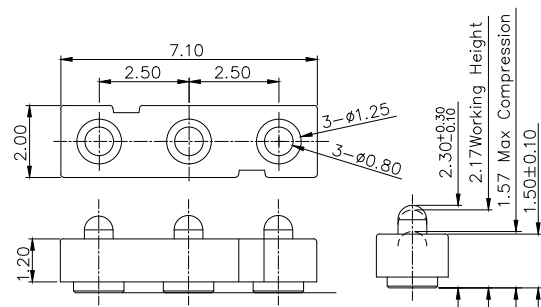
3 PINS



PN: F1106AA01-02A400MR

Length: 2.30 mm
Working Height: 2.17 mm
Pitch: 2.50 mm
Current: 1 Amp
Contact Resistance: 100 mΩ
Spring Force: 80g ± 20%

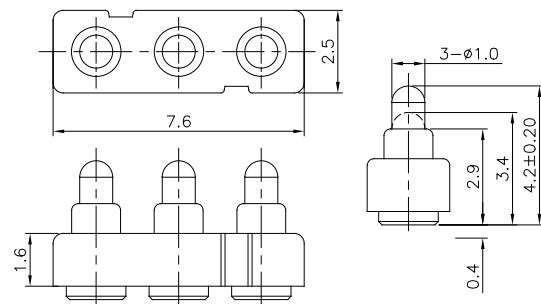

PN: N103M5-03G250MR

Length: 4.20 mm
Working Height: 3.40 mm
Pitch: 2.50 mm
Current: 1 Amp
Contact Resistance: 50 mΩ
Spring Force: 120g ± 20%

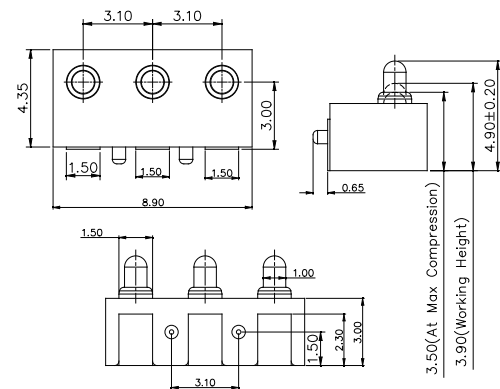

PN: H003M7-H03A310R

Length: 4.90 mm
Working Height: 3.90 mm
Pitch: 3.10 mm
Current: 1 Amp
Contact Resistance: 50 mΩ
Spring Force: 120g ± 20%

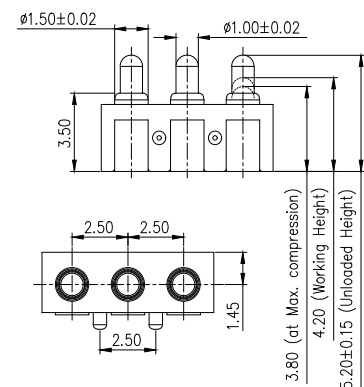

PN: H003M1-H03B250RR

Length: 5.20 mm
Working Height: 4.20 mm
Pitch: 2.50 mm
Current: 1 Amp
Contact Resistance: 50 mΩ
Spring Force: 120g ± 20%

NON STANDARD CONNECTOR

3 PINS

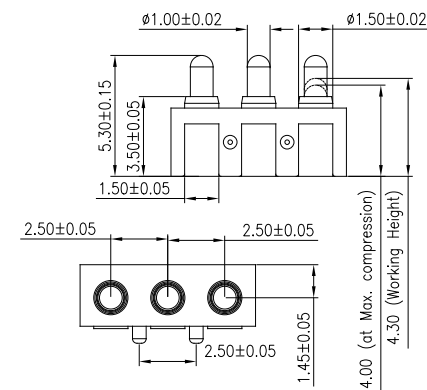

PN: H003M3-H03B250R

Length: 5.30 mm
Working Height: 4.30 mm
Pitch: 2.50 mm
Current: 1 Amps
Contact Resistance: 50 mΩ
Spring Force: 120g ± 20%

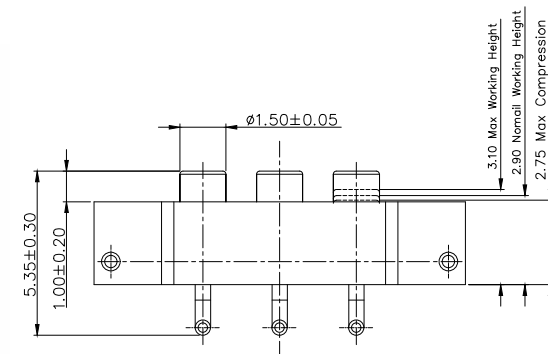

PN: P3309MF01-03R250MR

Length: 5.30 mm
Working Height: 3.10 mm
Pitch: 2.50 mm
Current: 1 Amp
Contact Resistance: 100 mΩ
Spring Force: 100g ± 20%

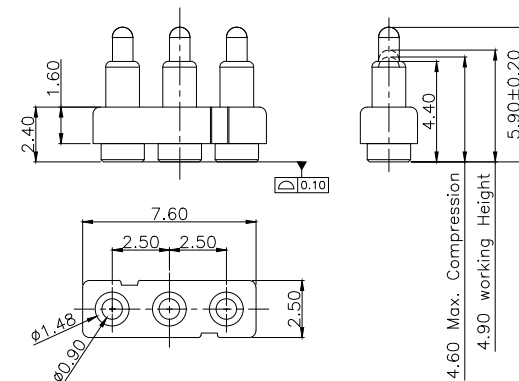

PN: F515AA01-03250MR

Length: 5.90 mm
Working Height: 4.90 mm
Pitch: 2.50 mm
Current: 1 Amp
Contact Resistance: 50 mΩ
Spring Force: 120g ± 20%

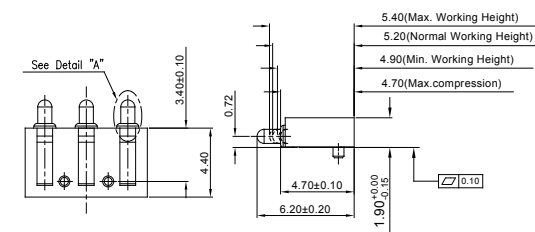

PN: R175AA09-03265HR

Length: 6.20 mm
Working Height: 5.20 mm
Pitch: 4.90 mm
Current: 2.5 Amps
Contact Resistance: 50 mΩ
Spring Force: 120g ± 20%

NON STANDARD CONNECTOR

3 PINS

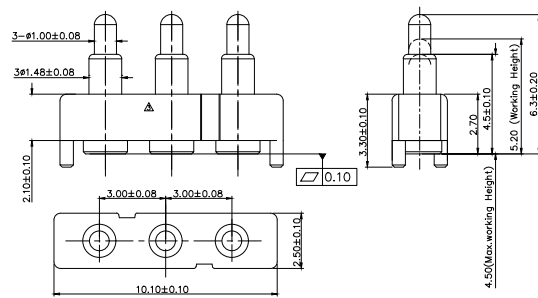

PN: H179M0-03A300MR

Length: 6.30 mm
Working Height: 5.20 mm
Pitch: 3.00 mm
Current: 1 Amp
Contact Resistance: 50 m Ω
Spring Force: 110g \pm 20%

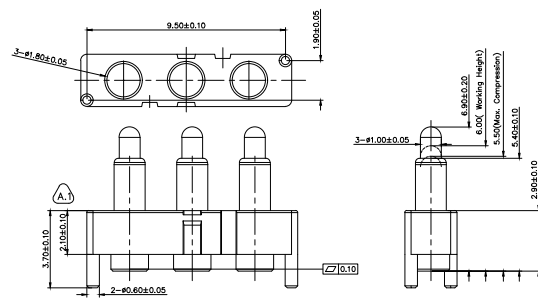

PN: F1767AA01-03A300MR

Length: 6.90 mm
Working Height: 6.00 mm
Pitch: 3.00 mm
Current: 1 Amp
Contact Resistance: 50 m Ω
Spring Force: 100g \pm 20%

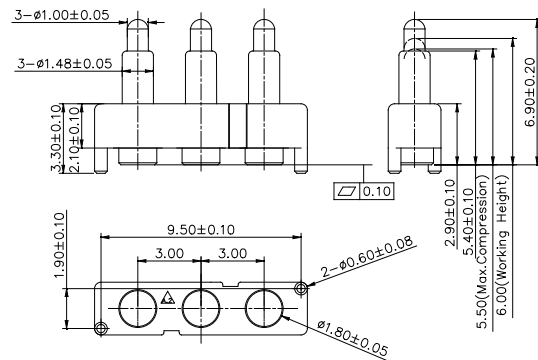

PN: N042M4-03A300MR

Length: 6.90 mm
Working Height: 6.00 mm
Pitch: 3.00 mm
Current: 1 Amp
Contact Resistance: 50 m Ω
Spring Force: 60g \pm 20g

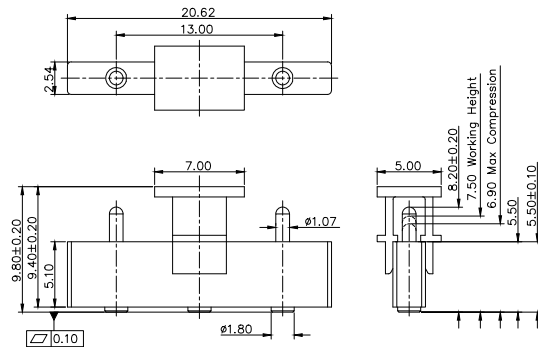
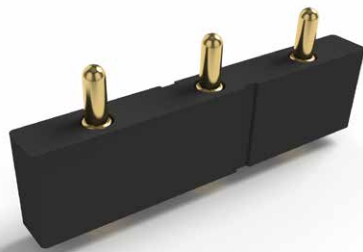

PN: F1712AA02-03D650MR

Length: 8.20 mm
Working Height: 7.50 mm
Pitch: 6.50 mm
Current: 1 Amp
Contact Resistance: 100 m Ω
Spring Force: 85g \pm 20%

NON STANDARD CONNECTOR

3 PINS

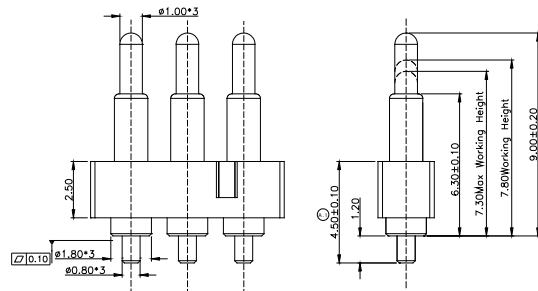

PN: P1500AA01-03C250MR

Length: 9.00 mm
Working Height: 7.80 mm
Pitch: 2.50 mm
Current: 1 Amp
Contact Resistance: 50 m Ω
Spring Force: 60g \pm 20%

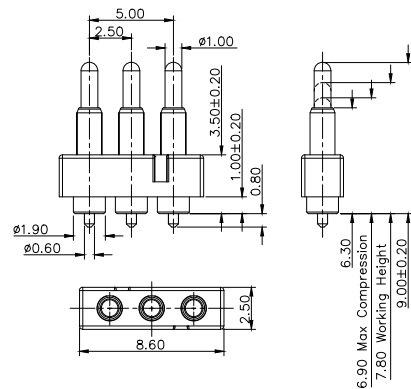

PN: P2223MP01-03C250MR

Length: 9.00 mm
Working Height: 7.80 mm
Pitch: 2.50 mm
Current: 1 Amp
Contact Resistance: 50 m Ω
Spring Force: 100g \pm 20%

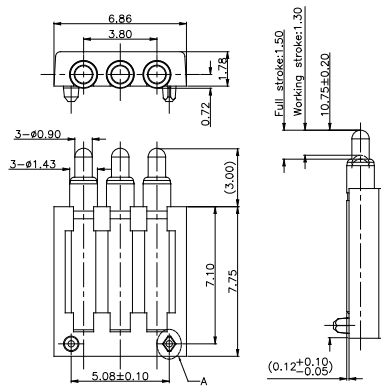

PN: R1332AA01-03B190RR

Length: 10.75 mm
Working Height: 9.45 mm
Pitch: 1.90 mm
Current: 1 Amp
Contact Resistance: 50 m Ω
Spring Force: 110g \pm 20%

NON STANDARD CONNECTOR

4 PINS

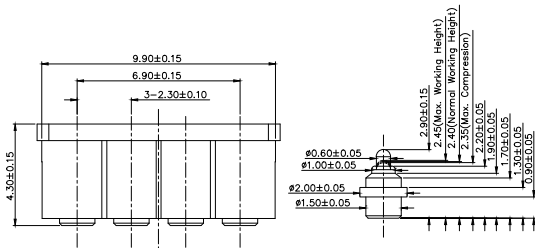

PN: P5331MF02-04A230CR

Length: 2.90 mm
Working Height: 2.40 mm
Pitch: 2.30 mm
Current: 1 Amp
Contact Resistance: 50 mΩ
Spring Force: 75g ± 15g

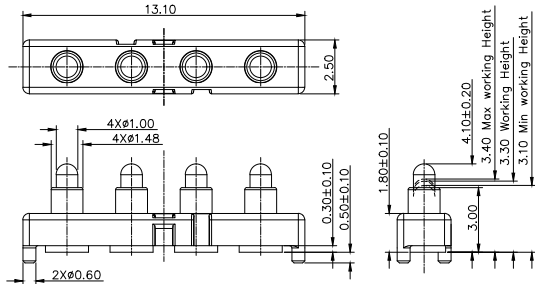

PN: F1853AA02-04F300MR

Length: 4.10 mm
Working Height: 3.30 mm
Pitch: 3.00 mm
Current: 1 Amp
Contact Resistance: 50 mΩ
Spring Force: 80g ± 20%

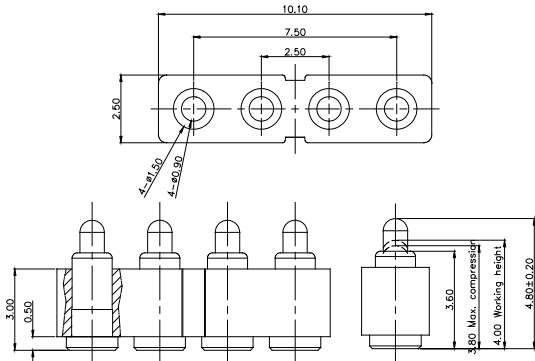

PN: P3063MF01-04B250MR

Length: 4.80 mm
Working Height: 4.00 mm
Pitch: 2.50 mm
Current: 2 Amps
Contact Resistance: 50 mΩ
Spring Force: 90g ± 20%

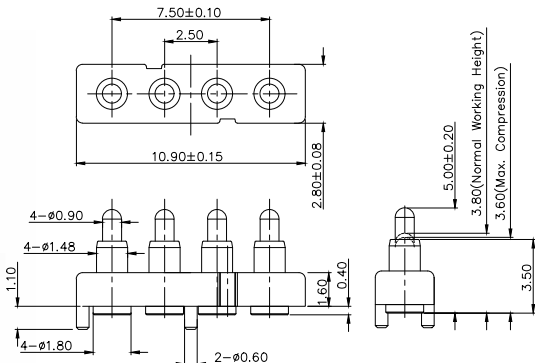

PN: P2808MF01-04D250MR

Length: 5.00 mm
Working Height: 3.80 mm
Pitch: 2.50 mm
Current: 2 Amps
Contact Resistance: 50 mΩ
Spring Force: 90g ± 20g

NON STANDARD CONNECTOR

4 PINS

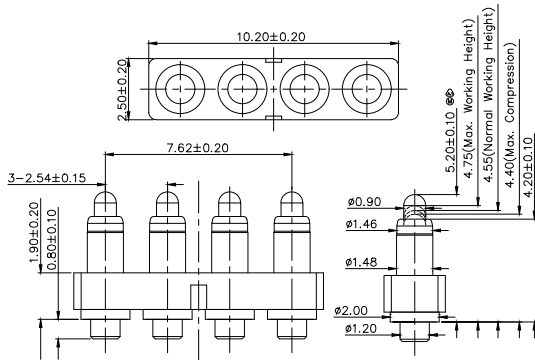

PN: P3859MP01-04A254MR

Length: 5.20 mm
Working Height: 4.55 mm
Pitch: 2.54 mm
Current: 1 Amp
Contact Resistance: 50 mΩ
Spring Force: 55g ± 10g

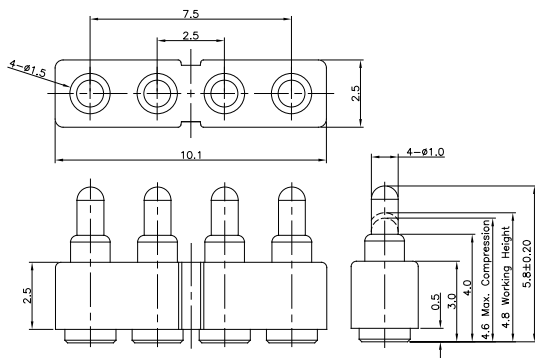

PN: N005M4-04B250MR

Length: 5.80 mm
Working Height: 4.80 mm
Pitch: 2.50 mm
Current: 1 Amp
Contact Resistance: 50 mΩ
Spring Force: 110g ± 20%

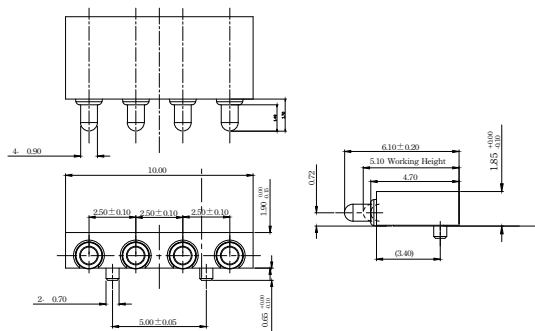

PN: R175AA00-04250RR

Length: 6.10 mm
Working Height: 5.10 mm
Pitch: 2.50 mm
Current: 1 Amp
Contact Resistance: 50 mΩ
Spring Force: 110g ± 20%

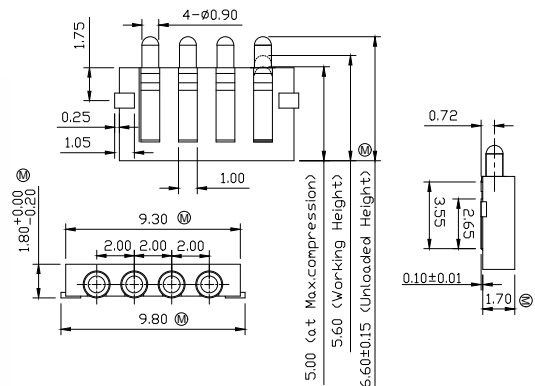

PN: H016M0-H04A200R

Length: 6.60 mm
Working Height: 5.60 mm
Pitch: 2.00 mm
Current: 1 Amp
Contact Resistance: 50 mΩ
Spring Force: 110g ± 20%

4 PINS

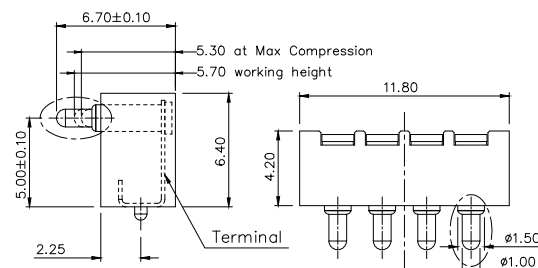

Length:	6.70 mm
Working Height:	5.70 mm
Pitch:	2.50 mm
Current:	1 Amp
Contact Resistance:	50 mΩ
Spring Force:	120g ± 20%

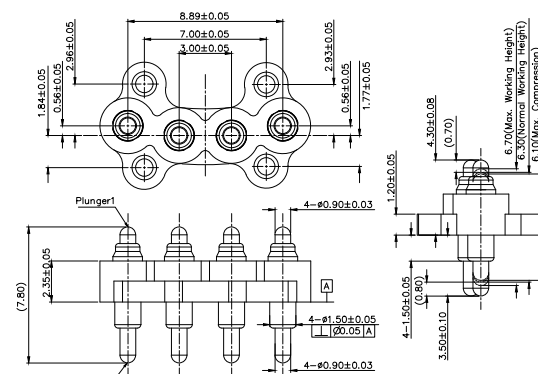

Length:	7.80 mm
Working Height:	6.30 mm
Pitch:	3.00 mm
Current:	1 Amp
Contact Resistance:	30 mΩ
Spring Force:	85g ± 15g

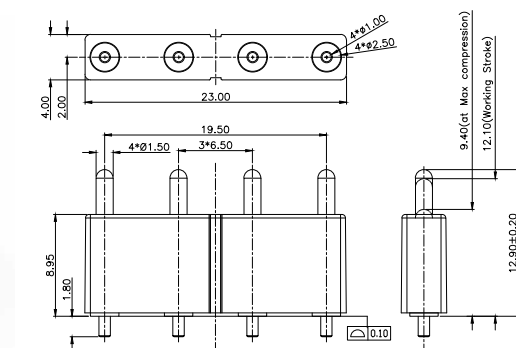

Length:	12.90 mm
Working Height:	12.10 mm
Pitch:	6.50 mm
Current:	1 Amp
Contact Resistance:	50 mΩ
Spring Force:	105g ± 20g

5 PINS

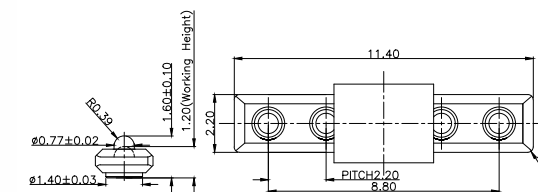

Length:	1.60 mm
Working Height:	1.20 mm
Pitch:	2.20 mm
Current:	1 Amp
Contact Resistance:	100 mΩ
Spring Force:	60g ± 20g

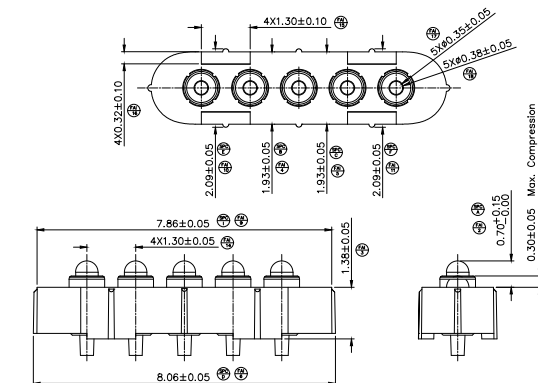

Length:	2.08 mm
Working Height:	1.68 mm
Pitch:	1.30 mm
Current:	1 Amp
Contact Resistance:	50 mΩ
Spring Force:	100g ± 20g

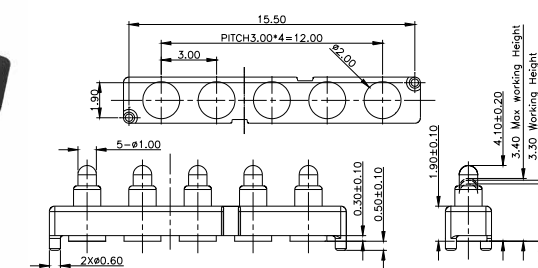

Length:	4.10 mm
Working Height:	3.30 mm
Pitch:	3.00 mm
Current:	1 Amp
Contact Resistance:	50 mΩ
Spring Force:	80g ± 20%

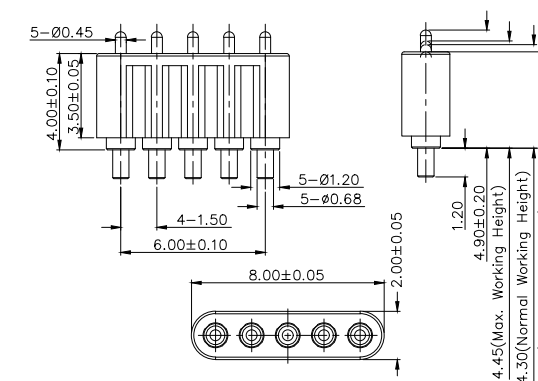

Length:	4.90 mm
Working Height:	4.30 mm
Pitch:	1.50 mm
Current:	2 Amps
Contact Resistance:	50 mΩ
Spring Force:	110g ± 20%

NON STANDARD
CONNECTOR

5 PINS

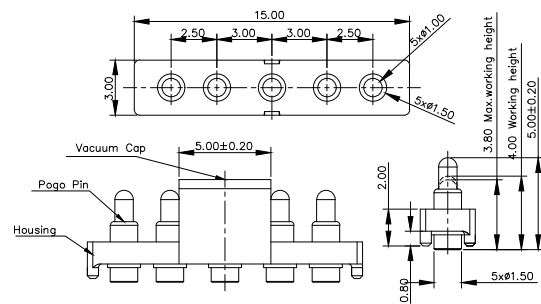
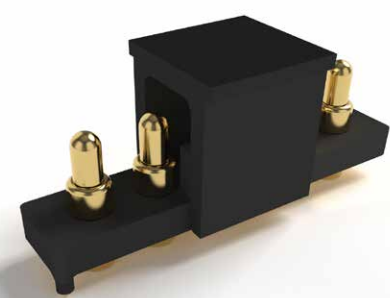

PN: F1371AA01-05A250MR

Length: 5.00 mm
Working Height: 4.00 mm
Pitch: 2.50 mm
Current: 1 Amp
Contact Resistance: 100 mΩ
Spring Force: 80g ± 20g

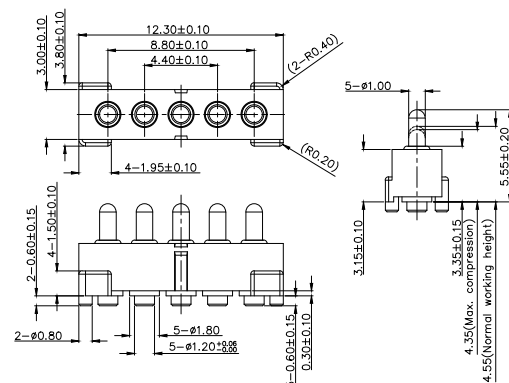

PN: P2761MP01-05E220MR

Length: 5.55 mm
Working Height: 4.55 mm
Pitch: 2.20 mm
Current: 1 Amp
Contact Resistance: 50 mΩ
Spring Force: 80g ± 20g

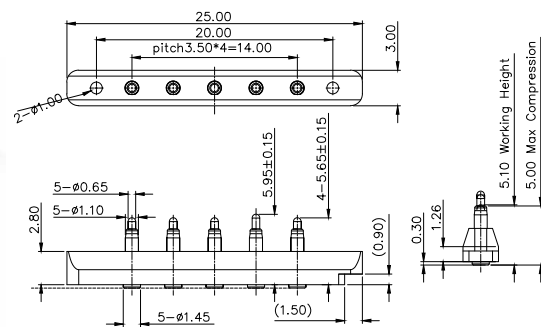

PN: P5362MF01-05A350MR

Length: 5.65 / 5.95 mm
Working Height: 5.10 mm
Pitch: 3.50 mm
Current: 2 Amps
Contact Resistance: 50 mΩ
Spring Force: 70g ± 20g

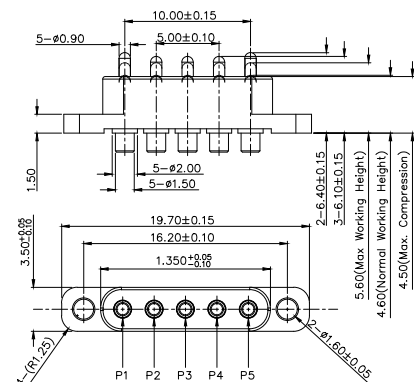

PN: P2673MF02-05R250HT

Length: 6.10 / 6.41 mm
Working Height: 4.60 mm
Pitch: 2.50 mm
Current: 2 Amps
Contact Resistance: 50 mΩ
Spring Force: 150g ± 20%

NON STANDARD
CONNECTOR

5 PINS

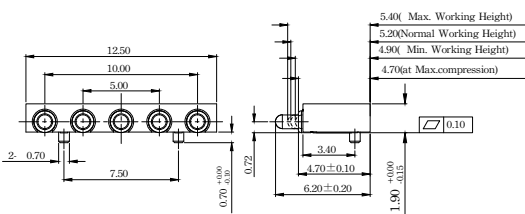

PN: R175AA05-05250RR

Length: 6.20 mm
Working Height: 5.20 mm
Pitch: 2.50 mm
Current: 2 Amps
Contact Resistance: 50 mΩ
Spring Force: 120g ± 20%

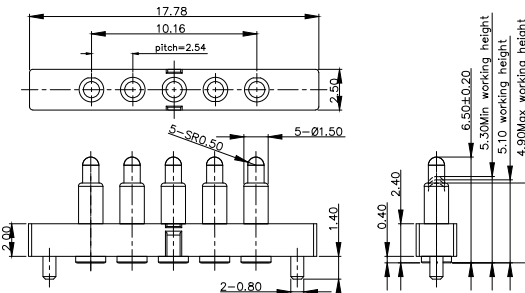

PN: P2037MF01-05J254MR

Length: 6.50 mm
Working Height: 5.10 mm
Pitch: 2.54 mm
Current: 2 Amps
Contact Resistance: 50 mΩ
Spring Force: 90g ± 20%

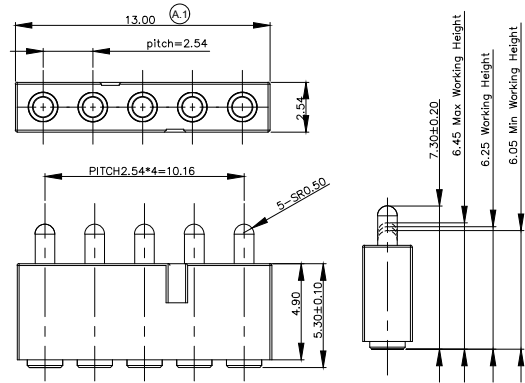

PN: P2315MF01-05L254MR

Length: 7.30 mm
Working Height: 6.25 mm
Pitch: 2.54 mm
Current: 5 Amps
Contact Resistance: 20 mΩ
Spring Force: 80g ± 20%

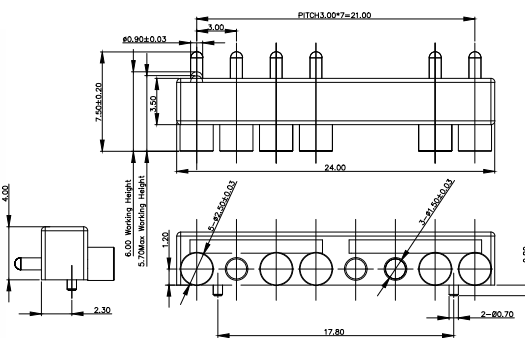

PN: F1601AA05-08G300HB

Length: 7.50 mm
Working Height: 6.00 mm
Pitch: 3.00 mm
Current: 2 Amps
Contact Resistance: 50 mΩ
Spring Force: 120g ± 20%

5 PINS

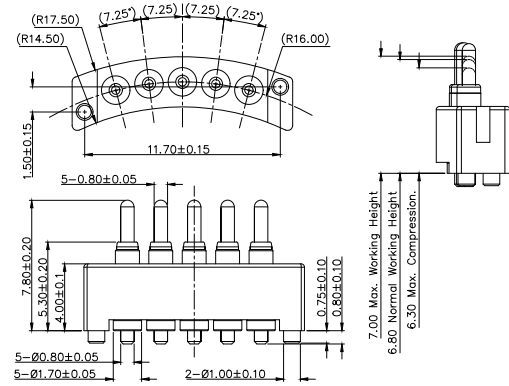

Length:	7.80 mm
Working Height:	6.80 mm
Pitch:	2.02 mm
Current:	2 Amps
Spring Force:	30g ± 10g

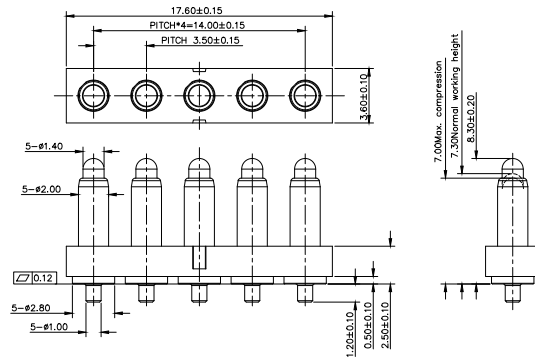

Length:	8.30 mm
Working Height:	7.30 mm
Pitch:	3.50 mm
Current:	3 Amps
Contact Resistance:	50 mΩ
Spring Force:	95g ± 20g

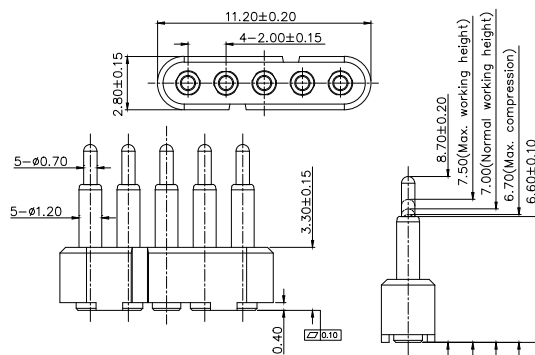

Length: 8.70 mm
Working Height: 7.00 mm
Pitch: 2.00 mm
Current: 3~5 Amps
Contact Resistance: 50 mΩ
Spring Force: 120g ± 20%

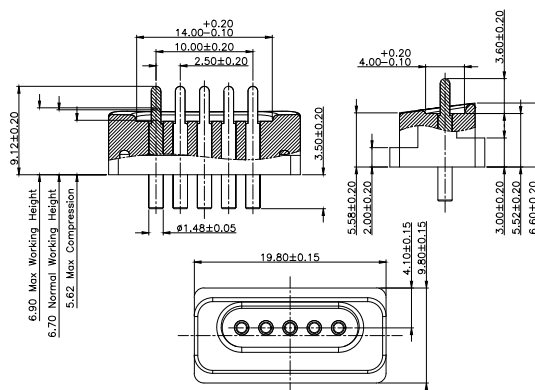

Length:	9.12 mm
Working Height:	6.70 mm
Pitch:	2.50 mm
Current:	1 Amp
Spring Force:	100g \pm 20g

6 PINS

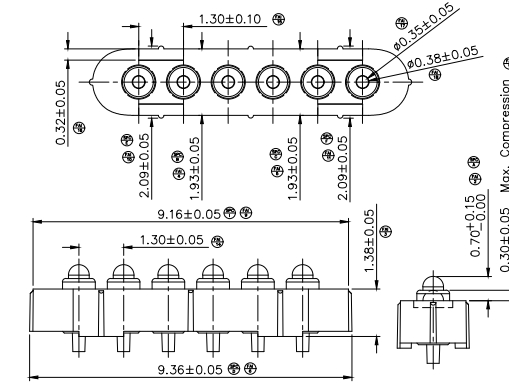

Length:	2.08 mm
Working Height:	1.68 mm
Pitch:	1.30 mm
Current:	1 Amp
Contact Resistance:	100 mΩ
Spring Force:	50g ± 20g

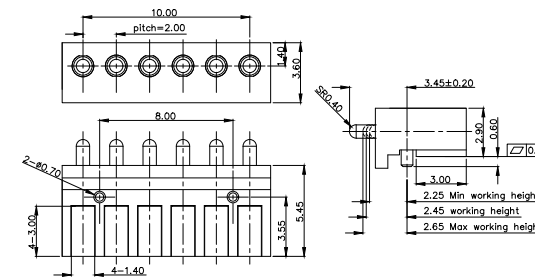

Length:	3.45 mm
Working Height:	2.45 mm
Pitch:	2.00 mm
Current:	2 Amps
Contact Resistance:	50 mΩ
Spring Force:	70g ± 20%

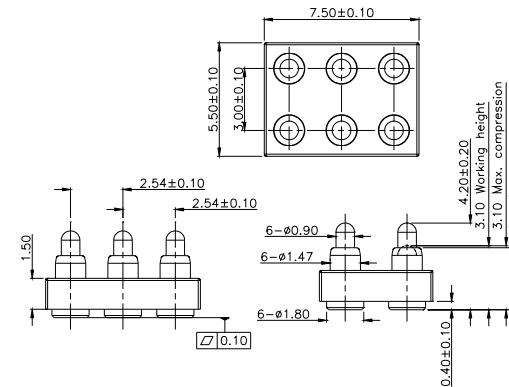

Length:	4.20 mm
Working Height:	3.10 mm
Pitch:	2.54 mm
Current:	1 Amp
Contact Resistance:	50 mΩ
Spring Force:	80g ± 20%

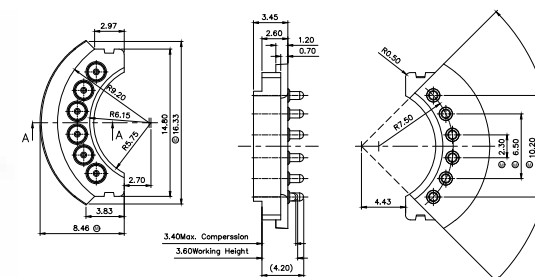

Length:	4.20 mm
Working Height:	3.60 mm
Pitch:	1.85 mm
Current:	1 Amp
Contact Resistance:	50 mΩ
Spring Force:	90g ± 20%

NON STANDARD CONNECTOR

6 PINS

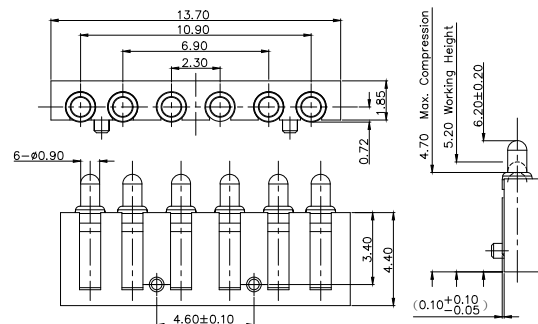

PN: R175AA05-06B200RR

Length: 6.20 mm
Working Height: 5.20 mm
Pitch: 2.30 mm
Current: 1.5 Amps
Contact Resistance: 50 mΩ
Spring Force: 120g ± 20%

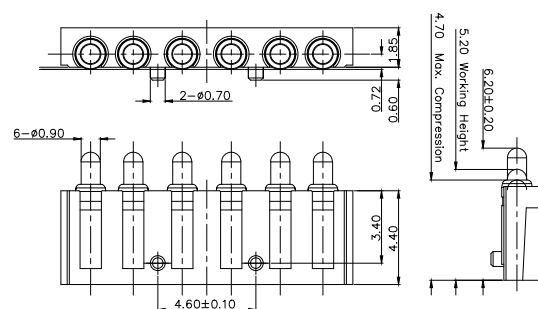

PN: R175AA08-06B200RR

Length: 6.20 mm
Working Height: 5.20 mm
Pitch: 2.30 mm
Current: 2 Amps
Contact Resistance: 50 mΩ
Spring Force: 120g ± 20%

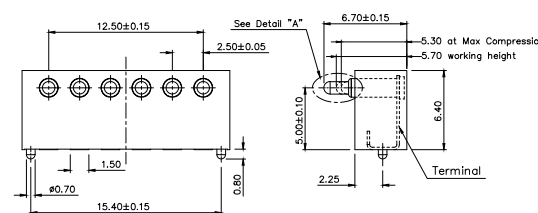

PN: R035AA06-06250RR

Length: 6.70 mm
Working Height: 5.70 mm
Pitch: 2.50 mm
Current: 1 Amp
Contact Resistance: 50 mΩ
Spring Force: 120g ± 20%

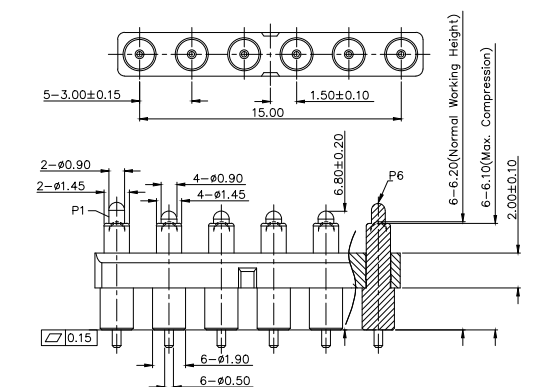

PN: P3588MP02-06B300MR

Length: 6.80 / 7.30 mm
Working Height: 6.20 mm
Pitch: 3.00 mm
Current: 2 Amps
Contact Resistance: 50 mΩ
Spring Force: 110g ± 20%

NON STANDARD CONNECTOR

6 PINS

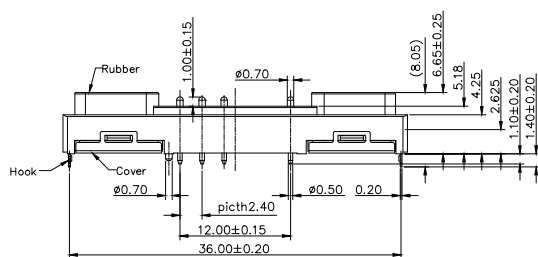

PN: P2197MP01-06C240MR

Length: 7.28 mm
Working Height: 6.48 mm
Pitch: 2.40 mm
Current: 2 Amps
Contact Resistance: 50 mΩ
Spring Force: 90g ± 20%

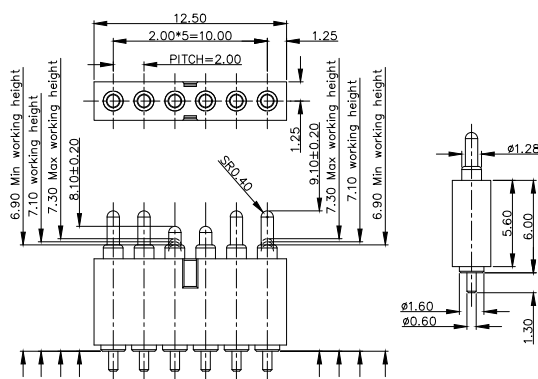

PN: P2294MP01-06E200MR

Length: 8.10 / 9.10 mm
Working Height: 7.10 mm
Pitch: 2.00 mm
Current: 2 Amps
Contact Resistance: 50 mΩ
Spring Force: 70g ± 20%

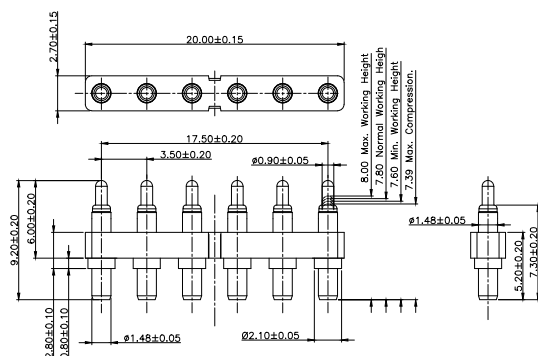

PN: P3783MP01-06L350MR

Length: 9.20 mm
Working Height: 7.80 mm
Pitch: 3.50 mm
Current: 5 Amps
Contact Resistance: 50 mΩ
Spring Force: 100g ± 20g

NON STANDARD CONNECTOR

8 PINS

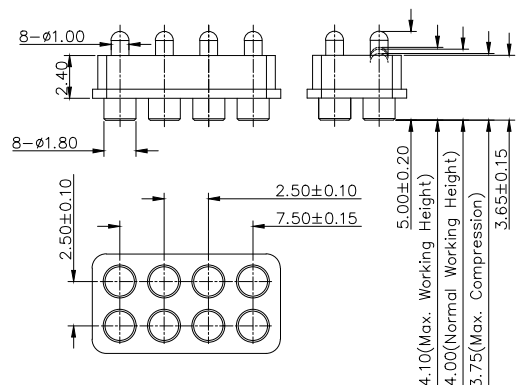

PN: P3728MF01-08P250HR

Length: 5.00 mm
Working Height: 4.00 mm
Pitch: 2.50 mm
Current: 1 Amp
Contact Resistance: 50 mΩ
Spring Force: 80g ± 20g

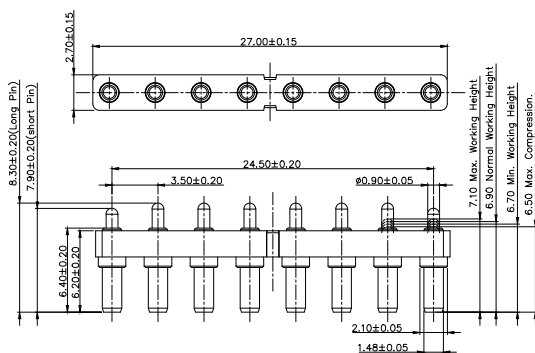
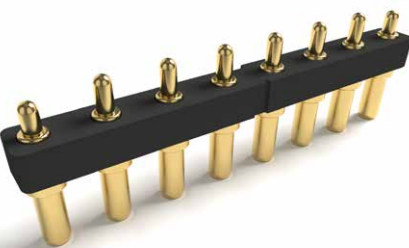

PN: P2613MP01-08E350MR

Length: 7.90 / 8.30 mm
Working Height: 6.90 mm
Pitch: 3.50 mm
Current: 2 Amps
Contact Resistance: 50 mΩ
Spring Force: 110g ± 20g

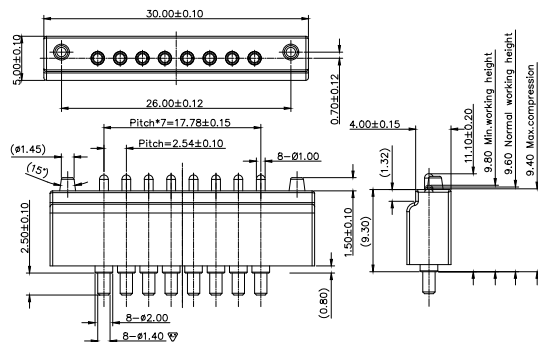
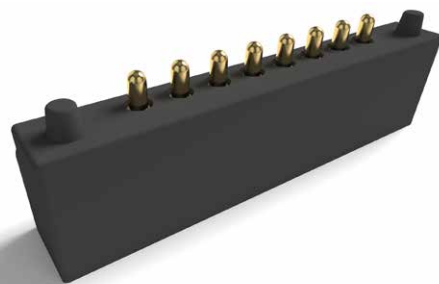

PN: P1933AA01-08C254HT

Length: 11.10 mm
Working Height: 9.60 mm
Pitch: 2.54 mm
Current: 2 Amps
Contact Resistance: 50 mΩ
Spring Force: 120g ± 20%

NON STANDARD CONNECTOR

9-12 PINS

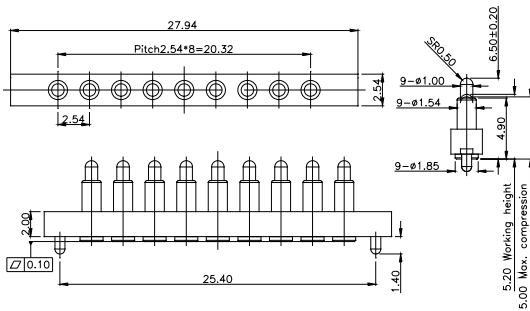

PN: P2839MF01-09F254MR

Length: 6.50 mm
Working Height: 5.20 mm
Pitch: 2.54 mm
Current: 1 Amp
Contact Resistance: 50 mΩ
Spring Force: 100g ± 20%

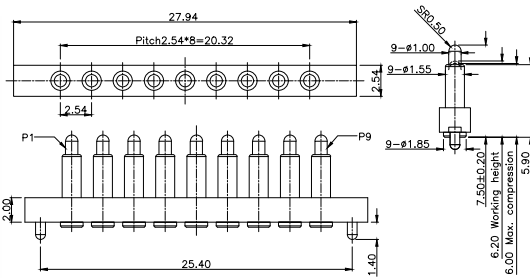

PN: P2879MF01-09F254MR

Length: 7.50 mm
Working Height: 6.20 mm
Pitch: 2.54 mm
Current: 1 Amp
Contact Resistance: 50 mΩ
Spring Force: 100g ± 20%

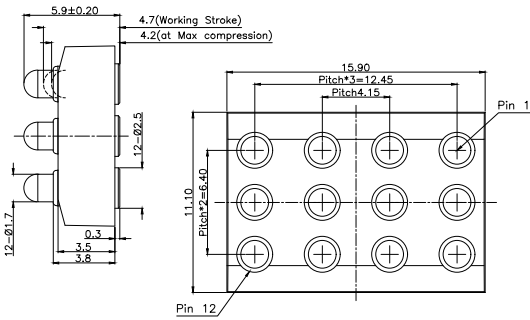

PN: P2976MF01-12A415HR

Length: 5.90 mm
Working Height: 4.70 mm
Pitch: 3.20 mm
Current: 2 Amps
Contact Resistance: 50 mΩ
Spring Force: 110g ± 20g

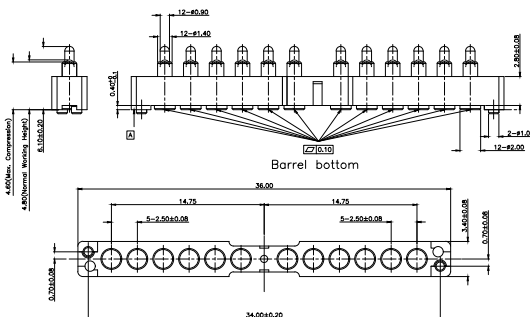
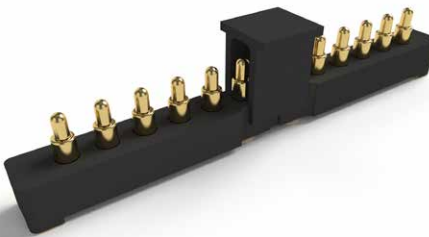

PN: P3303MF01-12A250MR

Length: 6.10 mm
Working Height: 4.80 mm
Pitch: 2.50 mm
Current: 1 Amp
Contact Resistance: 100 mΩ
Spring Force: 60g ± 20g

12-18 PINS

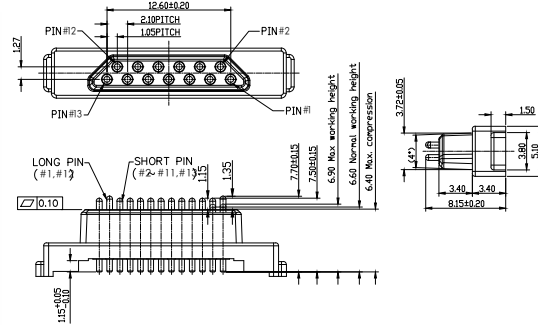

Length:	7.50 / 7.70 mm
Working Height:	6.60
Pitch:	1.05 mm
Current:	2 Amps
Contact Resistance:	50 mΩ
Spring Force:	140g ± 20%

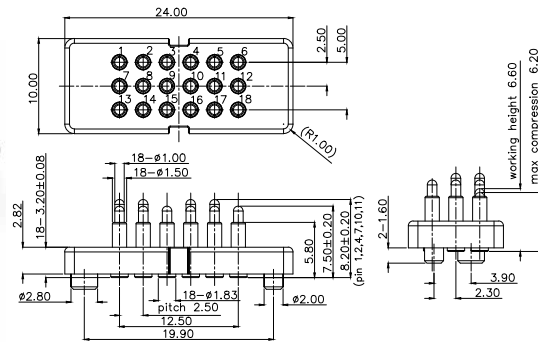

PN: P36/3MF01-18A250MR

■

Length:	7.50/8.20 mm
Working Height:	6.60 mm
Pitch:	2.50 mm
Current:	1 Amp
Contact Resistance:	50 mΩ
Spring Force:	130g ± 20g

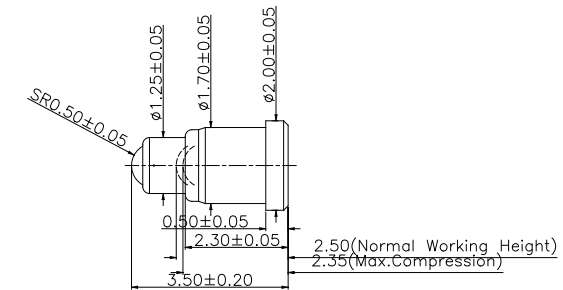

Length:	3.50 mm
Working Height:	2.50 mm
Current:	2 Amps
Contact Resistance:	100 mΩ
Spring Force:	60g ± 15g
Durability:	2,000

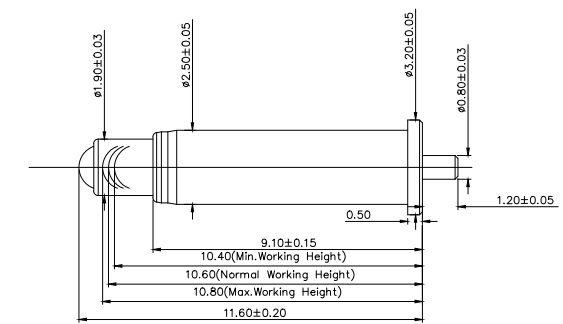

Length:	11.60 mm
Working Height:	10.60 mm
Current:	2 Amps
Contact Resistance:	50 mΩ
Spring Force:	90g ± 20g
Durability:	10,000

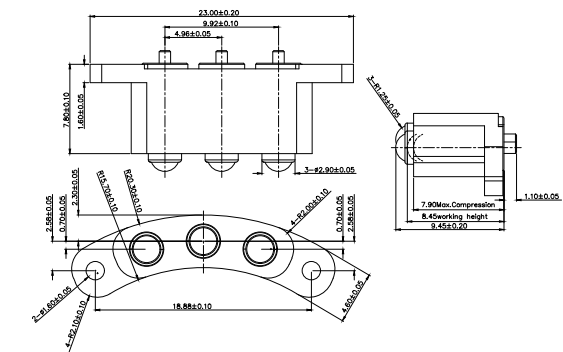

Length:	9.45 mm
Working Height:	8.45 mm
Pitch:	4.96 mm
Current:	1 Amp
Contact Resistance:	100 mΩ
Spring Force:	60g ± 15g
Durability:	200,000

WATERPROOF CONNECTOR

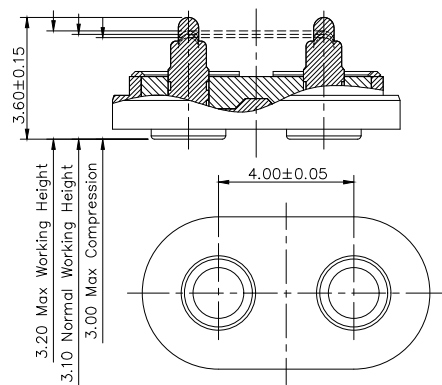

PN: P5562MP01-02B400HB

Length: 3.60 mm
Working Height: 3.10 mm
Pitch: 4.00 mm
Current: 1 Amps
Contact Resistance: 100 mΩ
Spring Force: 80g ± 20g
IP Factor: IPX8

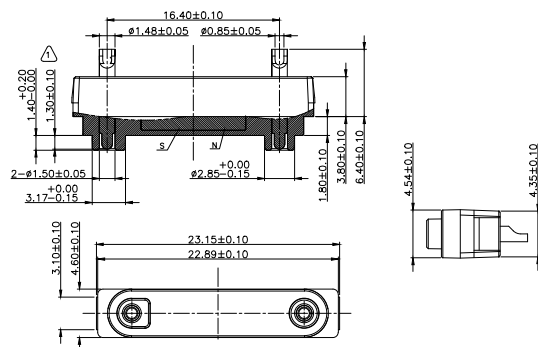
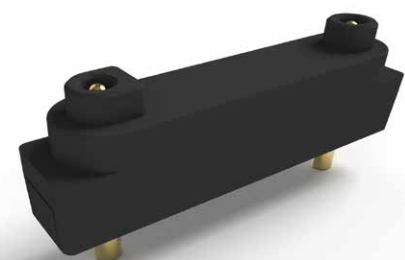

PN: P2859MS01-02B164HT

Length: 9.60 mm
Working Height: 9.50 mm
Pitch: 16.40 mm
Current: 5 Amps
Contact Resistance: 50 mΩ
Spring Force: 110g ± 20g
IP Factor: IPX7

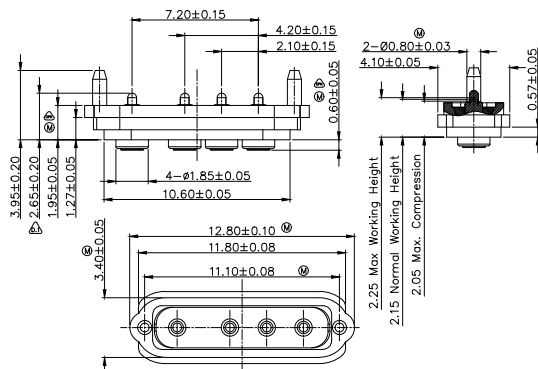

PN: P5320MF01-04A210HT

Length: 2.65 mm
Working Height: 2.15 mm
Pitch: 2.10 mm
Current: 1.5 Amps
Contact Resistance: 50 mΩ
Spring Force: 80g ± 20g
IP Factor: IPX7

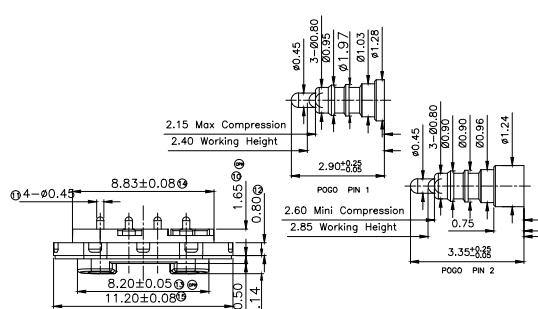

PN: P2988MM03-04C180HB

Length: 2.90 / 3.35 mm
Working Height: 2.40 / 2.85 mm
Pitch: 1.80 mm
Current: 1 Amp
Contact Resistance: 50 mΩ
Spring Force: 60g ± 20g

WATERPROOF CONNECTOR

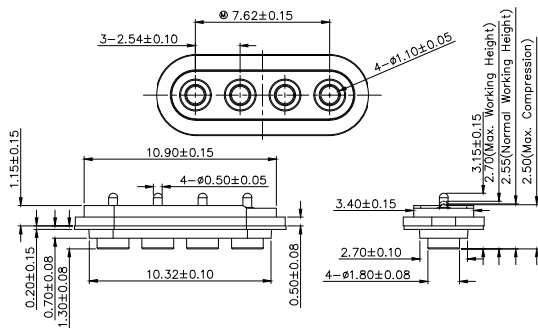

PN: P5875MF01-04A250HT

Length: 3.15 mm
Working Height: 2.55 mm
Pitch: 2.54 mm
Current: 1 Amp
Contact Resistance: 50 mΩ
Spring Force: 75g ± 20g
IP Factor: IPX7

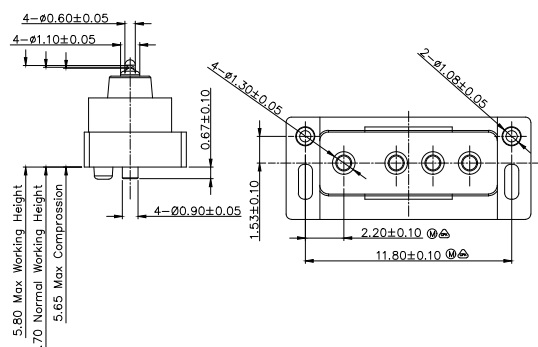

PN: P3613MP05-04A210MR

Length: 6.13 mm
Working Height: 5.70 mm
Pitch: 2.10 mm
Current: 1 Amp
Contact Resistance: 50 mΩ
Spring Force: 50g ± 15g

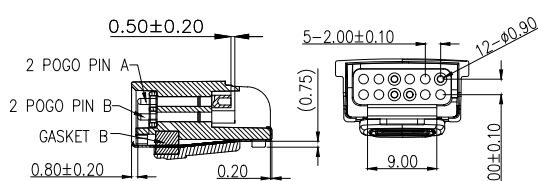

PN: F047AA00-04200ST

Length: 18.00 mm
Working Height: 17.50 mm
Pitch: 2.0 mm
Current: 1 Amp
Contact Resistance: 100 mΩ
Spring Force: 80g ± 20g

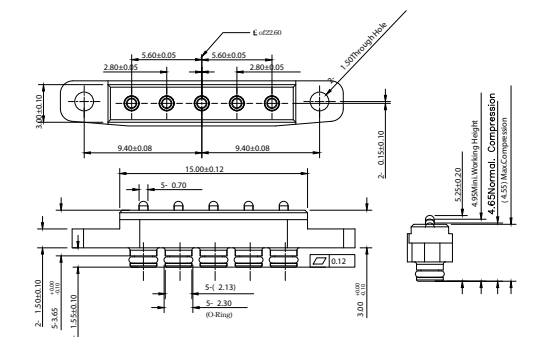

PN: P2352MF01-05A280HT

Length: 5.25 mm
Working Height: 4.95 mm
Pitch: 2.80 mm
Current: 2 Amps
Contact Resistance: 50 mΩ
Spring Force: 95g ± 20g

WATERPROOF CONNECTOR

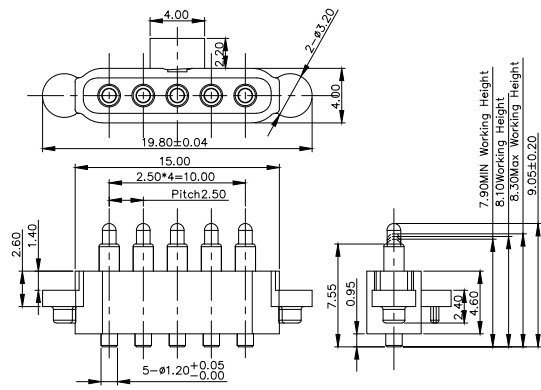

PN: P3608MP01-05A250MR

- Length: 9.05 mm
- Working Height: 8.10 mm
- Pitch: 2.50 mm
- Current: 2 Amps
- Contact Resistance: 50 mΩ
- Spring Force: 90g ± 20%
- IP Factor: IPX7

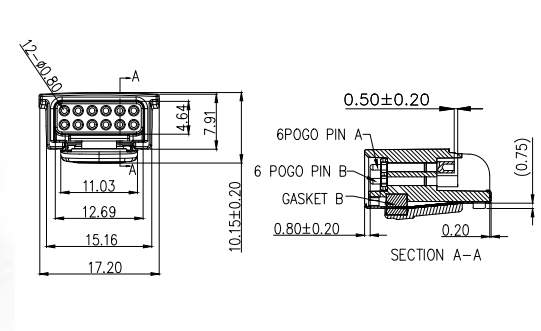

PN: F047AA00-12200ST

- Length: 18.00 mm
- Working Height: 17.50 mm
- Pitch: 2.0 mm
- Current: 1 Amp
- Contact Resistance: 100 mΩ
- Spring Force: 80g ± 20%

MAGNETIC CONNECTOR

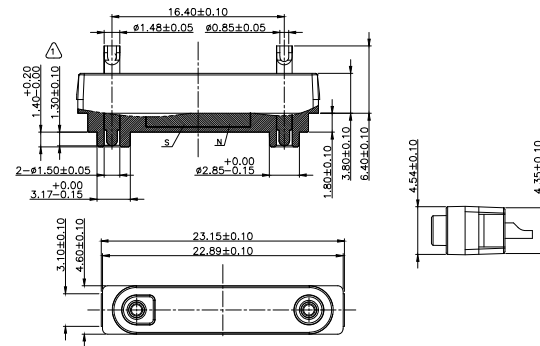
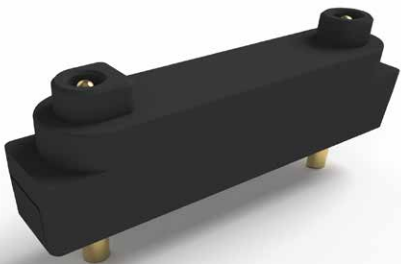

PN: P2859MS01-02B164HT

- Length: 9.60 mm
- Working Height: 9.50 mm
- Pitch: 16.40 mm
- Current: 5 Amps
- Contact Resistance: 50 mΩ
- Spring Force: 110g ± 20%
- IP Factor: IPX7

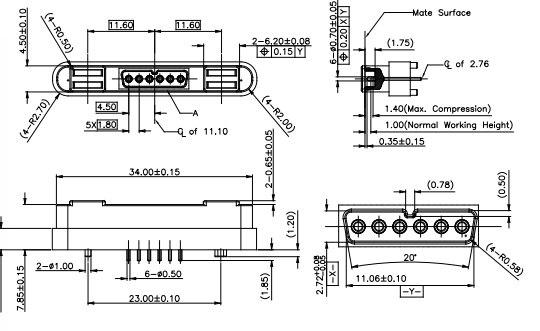

PN: P2578MP01-06C180HT

- Length: 9.70 mm
- Working Height: 8.70 mm
- Pitch: 1.80 mm
- Current: 3 Amps
- Contact Resistance: 50 mΩ
- Spring Force: 70g ± 20g

HIGH CURRENT CONNECTOR

DOUBLE ENDED PIN

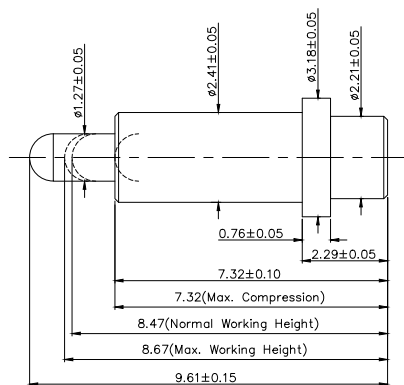

PN: P5650FH01

- Length: 9.61 mm
- Working Height: 8.47 mm
- Current: 9 Amps
- Contact Resistance: 30 mΩ
- Spring Force: 100g ± 20%

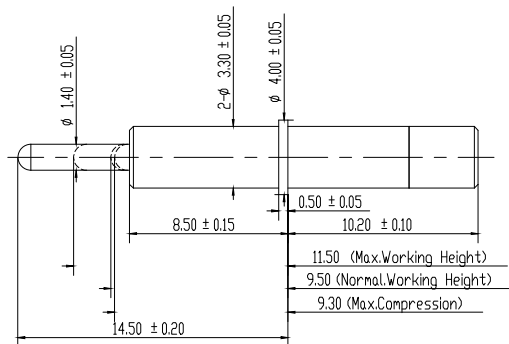

PN: P07408PH1

- Length: 14.50 mm
- Working Height: 9.50 mm
- Current: 12 Amps
- Contact Resistance: 50 mΩ
- Spring Force: 150g ± 20%

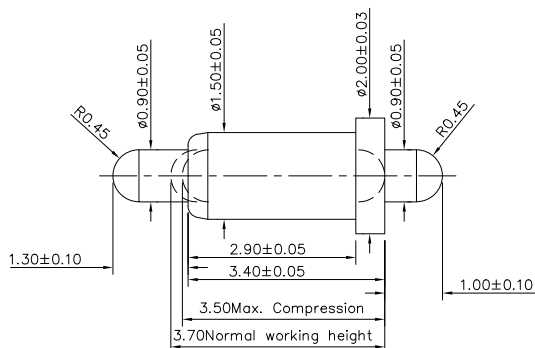

PN: P2573DP01

- Length: 5.70 mm
- Working Height: 3.70 mm
- Current: 1 Amp
- Contact Resistance: 100 mΩ
- Spring Force: 100g ± 20%

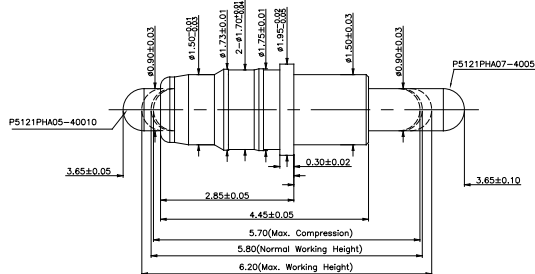

PN: P5650FH01

- Length: 7.30 mm
- Working Height: 5.80 mm
- Current: 2 Amps
- Contact Resistance: 30 mΩ
- Spring Force: 85g ± 15g

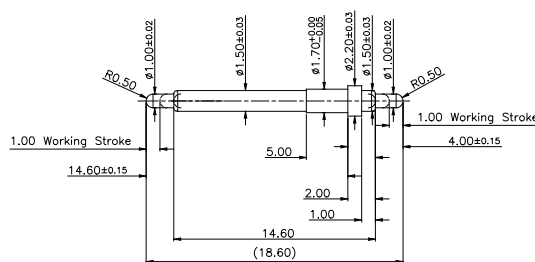

PN: D406AA01

- Length: 18.60 mm
- Working Height: 16.60 mm
- Current: 1 Amp
- Contact Resistance: 100 mΩ
- Spring Force: 60g ± 20%

ULTRA SMALL
PIN

SCREW
PIN

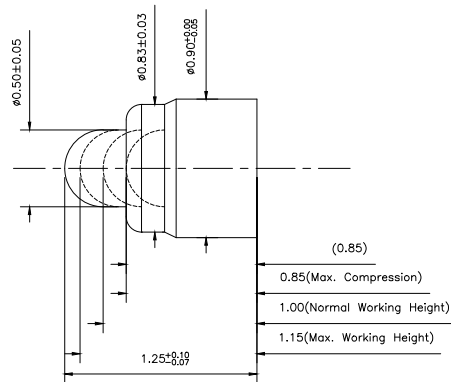

PN: P6925FP03

Length: 1.25 mm
Working Height: 1.00 mm
Current: 300m Amp
Contact Resistance: 100 mΩ
Spring Force: 35g ± 20%

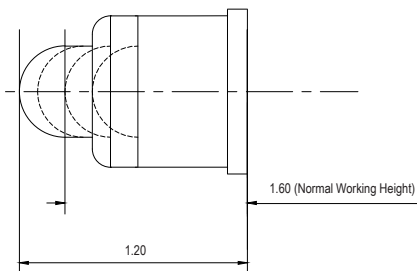

PN: F254AA01

Length: 1.60 mm
Working Height: 1.20 mm
Current: 300m Amp
Contact Resistance: 100 mΩ
Spring Force: 40g ± 20%

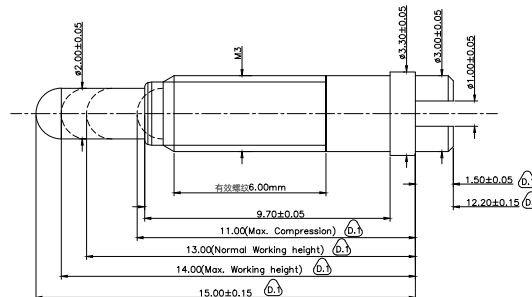

PN: P07417PH1

Length: 15.00 mm
Working Height: 13.00 mm
Current: 1 Amps
Contact Resistance: 50 mΩ
Spring Force: 250g ± 20%

Testing Items

Environmental

- Waterproof
- Humidity Test
- Salt Spray
- Thermal Impact
- Resistance to Solder Heat
- Vibration

Electrical

- Contact Resistance
- Insulation
- HIPOT
- Rated Current

Mechanical

- Retention Force
- Life Cycle
- Vibration
- Mechanical Shock

Other

- Drop
- Soldering Side Force
- Solderability

Testing Equipment

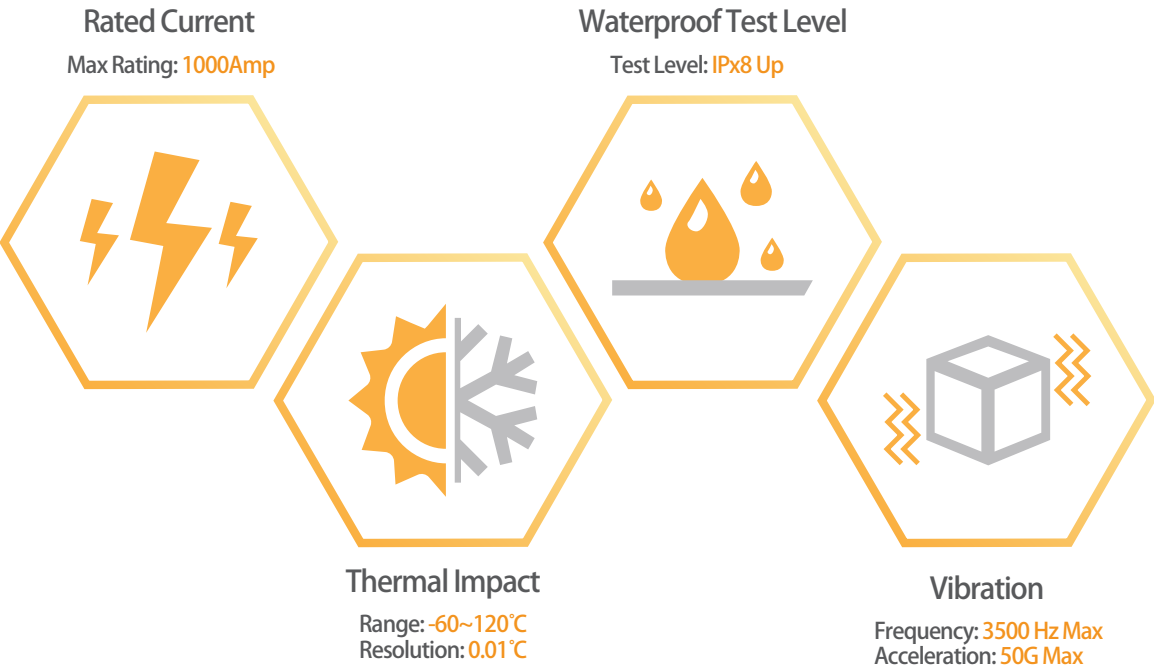

ISO 9001: 2015
Quality Management Systems

ISO 14001: 2015
Environmental Management Systems

IATF 16949: 2016
Automotive Quality Management Systems

QC 080000
Hazardous Substance Process Management

Quality Assurance





C.C.P. CONTACT PROBES

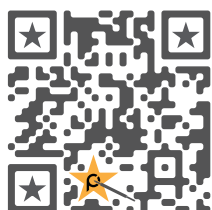

Dongguan
+86-769-85151668

Beijing
+86-10-53856584

Shenzhen
+86-755-82794229

San Jose
+1-408-3341981

Chengdu
+86-28-87440813

Frankfurt
+49-171-3669549

Chongqing
+86-158-23468769

Singapore
+65-81391296

Kunshan
+86-512-57378981

Taipei HQ
+886-2-29612525

Bangalore
+91-761689680

Wuhab
+86-139-73919421

Kaohsiung
+886-7-3601161

Tokyo
+81-03-52957090

Hong Kong
+852-23014671

Zhubei
+886-3-5506368

Seoul
+82-70-75432531

Hanoi
+843-88051121

www.ccpcontactprobes.com
ccp_service@pccp.com.tw