

REVISIONS				
LTR	DESCRIPTION	DATE	APPROVED	NOTE
	INITIAL RELEASE	10/11/04'		
△				
△				
△				

Please Approve this Drawing

Date	
Signature	

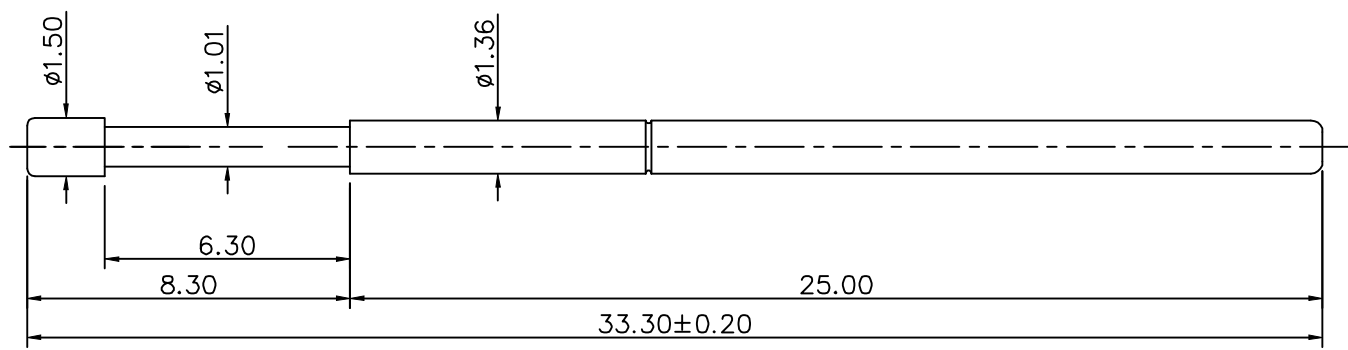

NOTES:
 1. Material
 .Plunger : BeCu AuPlated
 .Barrel : PhBz Au Plated
 .Spring : SWP Au Plated
 2. Mechanical
 .Full Stroke : 6.30 mm
 .Spring Force : 250 g \pm 20% at 6.30 mm Stroke

DRAWN		SCALE: 5 / 1	中國探針股份有限公司 C.C.P. CONTACT PROBES CO.,LTD.
CHECKED		SHEET: 1 OF 1	
APPROVED		DATE: 04/12/05'	
DIMENSIONS ARE IN MILLIMETERS TOLERANCES ARE: DECIMALS ANGLES X $\pm .25$ $\pm 2.0^\circ$ X.X $\pm .15$ $\pm 1.0^\circ$ X.XX $\pm .10$ $\pm 0.5^\circ$		THE INFORMATION AND DESIGN DISCLOSED HEREIN WAS ORIGINATED BY AND IS THE PROPERTY OF C.C.P. CONTACT PROBES CO.,LTD. C.C.P. CONTACT PROBES CO.,LTD. RESERVES ALL PATENT, PROPRIETARY, DESIGN, MANUFACTURING, REPRODUCTION, USE AND SALES RIGHTS THEREOF, AND TO ANY ARTICLE DISCLOSED HEREIN EXCEPT TO THE EXTENT RIGHTS ARE EXPRESSLY GRANTED TO OTHERS. THE FOREGOING DOES NOT APPLY TO VENDOR PROPRIETARY RIGHTS.	
FILE PATH:		TITLE: P-25 Probes SIZE: A4 	DRAWING NO. P-25G-0525 REV. 00