

4  
PART No. P-1G1-0513

3

2

1  
REVISIONS

Please Approve this Drawing

Date	
Signature	

LTR	DESCRIPTION	DATE	APPROVED	NOTE
	INITIAL RELEASE			
△				
△				
△				

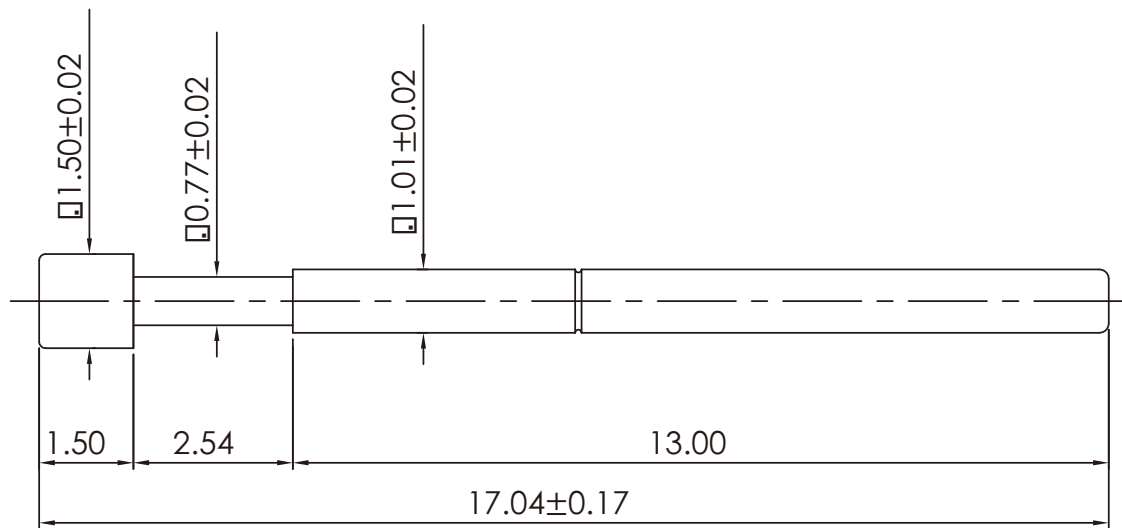

NOTES:

1.Material

- .Plunger : BeCu Au Plated
- .Barrel : Brass Au Plated
- .Spring : SUS304 Not Plated

2.Mechanical

- .Full Stroke : 2.54 mm
- .Spring Force : 130 g±20% at 2.54 mm Stroke

DRAWN		SCALE: 8:1
CHECKED		SHEET: 1 OF 1
APPROVED		DATE: 103/07/28
<small>DIMENSIONS ARE IN MILLIMETERS TOLERANCES ARE: DECIMALS ANGLES X. ±.25 ±2.0° XX ±.15 ±1.0° XXX ±.10 ±0.5° UNIT : mm</small>		<small>THE INFORMATION AND DESIGN DISCLOSED HEREIN WAS ORIGINATED BY AND IS THE PROPERTY OF C.C.P. CONTACT PROBES CO.,LTD. C.C.P. CONTACT PROBES CO.,LTD. RESERVES ALL PATENT, PROPRIETARY DESIGN, MANUFACTURING, REPRODUCTION, USE AND SALES RIGHTS THEREOF, AND TO ANY ARTICLE DISCLOSED HEREIN EXCEPT TO THE EXTENT RIGHTS ARE EXPRESSLY GRANTED TO OTHERS. THE FOREGOING DOES NOT APPLY TO VENDOR PROPRIETARY RIGHTS.</small>
FILE PATH:		

中國探針股份有限公司  
C.C.P. CONTACT PROBES CO.,LTD.

TITLE:  
P-1G1  
Probes

SIZE  
A4

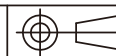

DRAWING NO.  
P-1G1-0513

REV.  
00