

| REVISIONS(修正) | | | |
|---------------|-----------------------|----------------|------------|
| NO. (序号) | DESCRIPTION(描述) | ECN NO.(变更号) | DATE(日期) |
| | INITIAL RELEASE(首次发行) | ECN-2201408027 | 2014.08.13 |
| △ | | | |

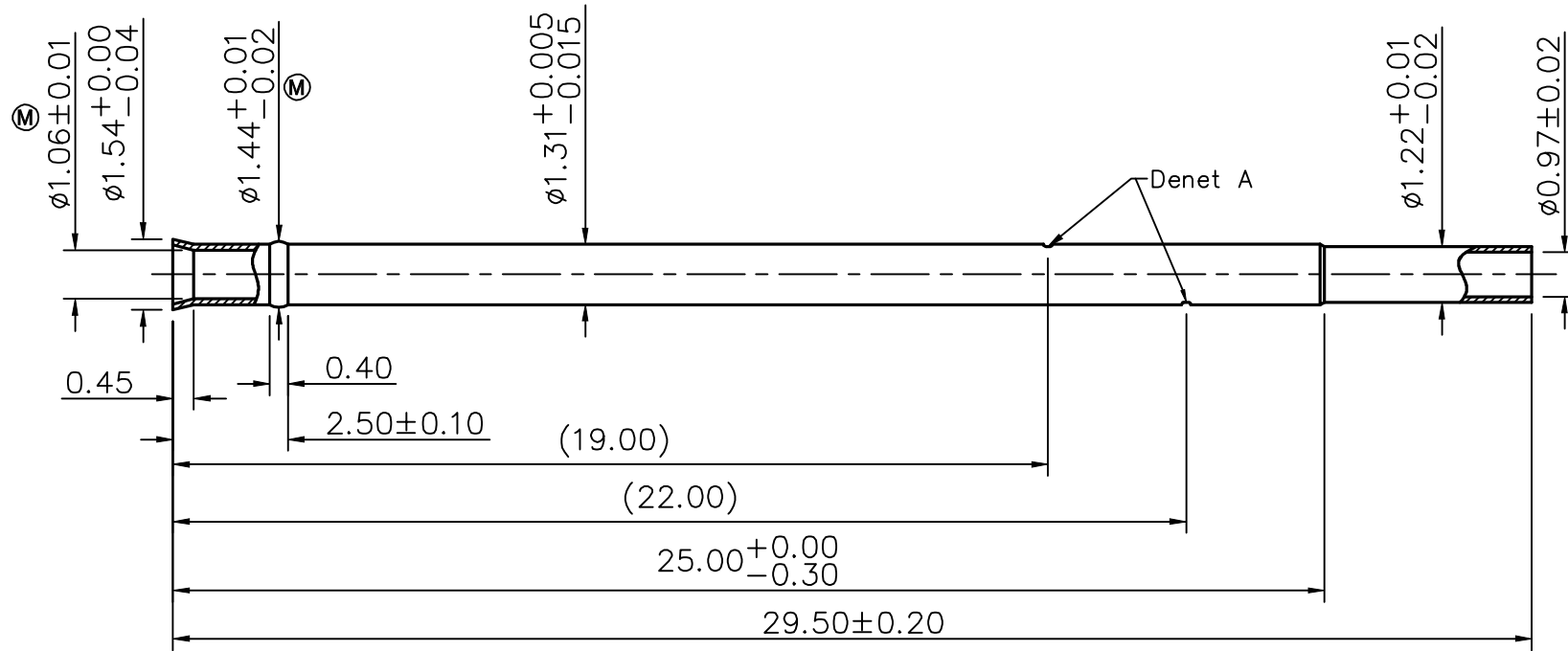

NOTE: (技术规范)

1. MATERIALS: (材质)

.Receptacle(外管): Brass(黄铜)

2. The insert force reference vaule is 0.85~1.0kgf with 1.01 gauge pin
(采用Ø1.01圆规测试插入力参考值为0.85~1.0kgf)

3. Harmful material control please follow DOC. NO."DQ03050"
(有害物质管控请遵循文件NO."DQ03050")

4. Ⓜ Mark is major dimension(标记 Ⓜ符号尺寸为重点尺寸)

| | | | | | | | |
|---|-----------|---------------|------------|--|-----|---------------------|-------------|
| DRAWN (设计) | linyushou | SCALE (比例) | 1 : 1 | UNIT (单位) | mm | DRAWING NO. (图号) | PR-111V-A01 |
| CHECKED (确认) | | SHEET (页数) | 1 of 1 | PROJECT (视图) | | TITLE (品名) | Receptacel |
| APPROVED (核准) | | DATE (日期) | 2014.08.13 | VER. (版本) | A.0 | | |
| THE UNMARKED TOLERANCE ARE AS BELOW : (未标记的公差) | | | | C.C.P. (DG) CONTACT PROBES CO.,LTD. 东莞中探探针有限公司 | | | |
| LENGTH (尺寸) | | ANGLE (角度) | | The information in this document is property of C.C.P company and should not be copied or reproduced in any other way, without written permission. | | | |
| 0~6.0 | ±0.05mm | 0. | ±2.0° | | | | |
| >6~30 | ±0.10mm | 0.0 | ±1.0° | | | | |
| >30~120 | ±0.15mm | 0.00 | ±0.50° | | | | |