

Please Approve this Drawing

Date	
Signature	

REVISIONS(修正)			
NO.(序号)	DESCRIPTION(描述)	ECN NO.(变更号)	DATE(日期)
	INITIAL RELEASE(首次发行)	ECN-2201401024	2014.01.20

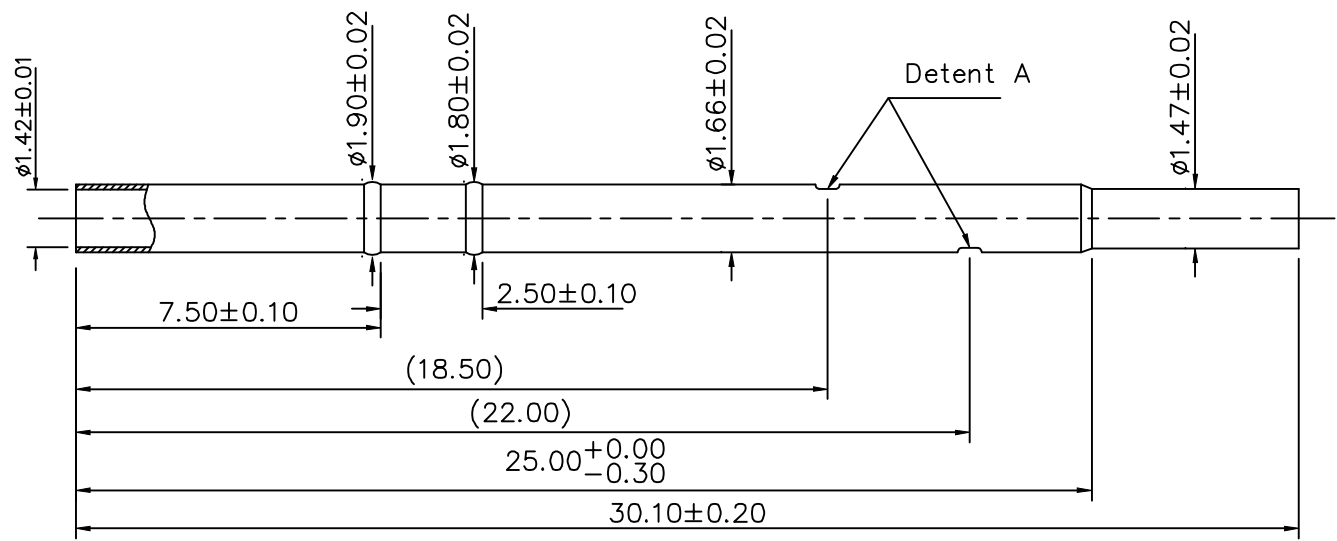

NOTE:  
 1.MATERIALS:  
 .Receptacle: Brass Au Plated  
 2.The insert force reference vaule is 0.5~1.2kgf with  $\phi 1.36$  gauge pin  
 3.Harmful material control please follow DOC. NO."DQ03050"  
 4. Working temperature:  $-40^{\circ}\text{C} \sim 180^{\circ}\text{C}(\text{peak})$

DRAW (设计)	linyushou	SCALE (比例)	10 : 1	UNIT (单位)	mm	DRAWING NO. (图号)	PR-25WV5-A05		
CHECK (校对)		SHEET (页数)	1 of 1	PROJECT (视图)		MATERIAL (材质)	Seeing notes (见备注)		
AUDIT (审核)		COUNTER SIGN (会签)				DATE (日期)	2016.08.10	REV	A.0
APPROVE (核准)		PLATE (镀层)	Seeing notes (见备注)			TITLE (品名)	Receptacle		
THE UNMARKED TOLERANCE ARE AS BELOW : (未标记的公差)						C.C.P. (DG) CONTACT PROBES CO.,LTD. 东莞中探探针有限公司			
LENGTH (尺寸)		ANGLE (角度)							
0~6.0	$\pm 0.05\text{mm}$	0.	$\pm 2.0^{\circ}$			The information in this document is property of C.C.P company and should not be copied or reproduced in any other way, without written permission.			
>6~30	$\pm 0.10\text{mm}$	0.0	$\pm 1.0^{\circ}$						
>30~120	$\pm 0.15\text{mm}$	0.00	$\pm 0.50^{\circ}$						