

PART No. SR-9W5-A09

REVISIONS

LTR	DESCRIPTION	DATE	APPROVED	NOTE
AO	INITIAL RELEASE	08/18/05		
△				
△				
△				

Please Approve this Drawing

Date	
Signature	

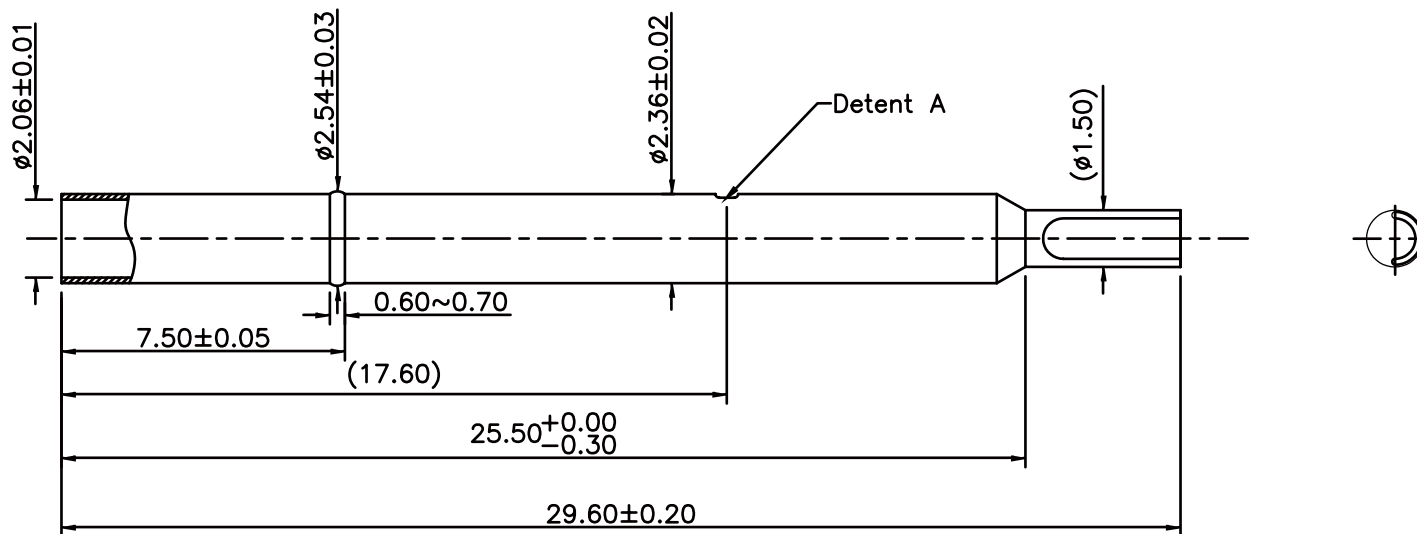

NOTES:

- MATERIALS:  
RECEPTACLE : BRASS
- PLATING:  
RECEPTACLE : BRASS Ni/Au  
OVER SUBSTRATE PLATED 80~120 μ" Nickel  
2 μ" Au PLATED.
- DETENT A, THE INSERT FORCE IS 0.9~1.5Kg.

DRAWN	SCALE: 5 / 1	<b>中國探針股份有限公司</b> C.C.P. CONTACT PROBES CO.,LTD.
CHECKED	SHEET: 1 OF 1	
APPROVED	DATE: 08/18/05	
DIMENSIONS ARE IN MILLIMETERS TOLERANCES ARE: DECIMALS                      ANGLES X.                                   ± 2.0° X.X                                  ± 1.0° X.XX                                ± 0.5° UNIT : mm		TITLE: CSR-9 RECEPTACLE
FILE PATH:	THE INFORMATION AND DESIGN DISCLOSED HEREIN WAS ORIGINATED BY AND IS THE PROPERTY OF C.C.P. CONTACT PROBES CO.,LTD. C.C.P. CONTACT PROBES CO.,LTD. RESERVES ALL PATENT, PROPRIETARY, DESIGN, MANUFACTURING, REPRODUCTION, USE AND SALES RIGHTS, THEREOF, AND TO ANY ARTICLE DISCLOSED HEREIN EXCEPT TO THE EXTENT RIGHTS ARE EXPRESSLY GRANTED TO OTHERS. THE FOREGOING DOES NOT APPLY TO VENDOR PROPRIETARY RIGHTS.	DRAWING NO. CSR-9WS
	SIZE A4	REV. 00