

4

3

2

1

D

D

C

C

B

B

A

A

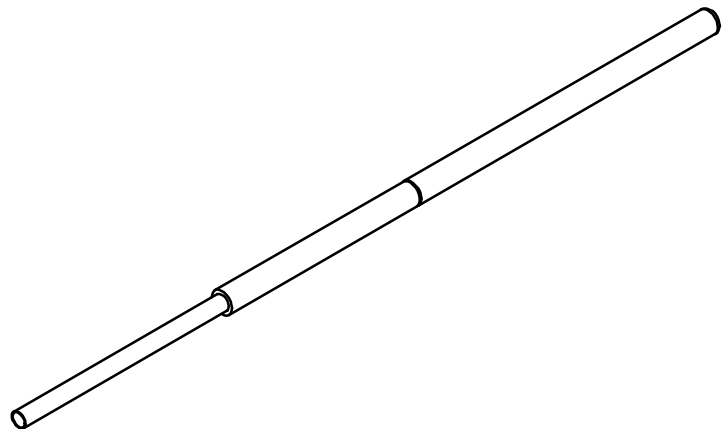

Please Approve this Drawing

| | |
|-----------|--|
| Date | |
| Signature | |

| REVISIONS (修正) | | | |
|----------------|-----------------|--------------|----------|
| NO. (序号) | DESCRIPTION(描述) | DCN NO.(变更号) | DATE(日期) |
| D.0 | NEW RELEASE | | |
| | | | |
| | | | |

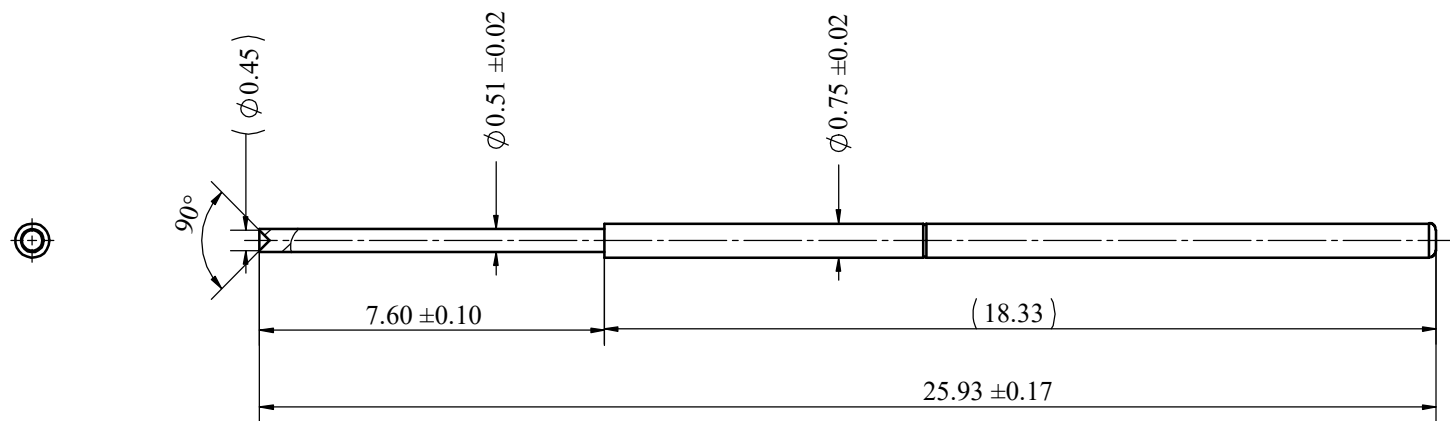

Notes :

- Materials and Finishes
 - Plunger : BeCu alloy with gold plating
 - Barrel : PhBz alloy with gold plating
 - Spring : SWP with gold plating
- Mechanical
 - Recommended travel : 1.00 mm
 - Full travel : 2.00 mm
 - Spring force : 150 g \pm 20% at recommended travel
- Durability :
 - Mechanical life : 100k cycles(minimum) at recommended travel
- Rated Current: 3A Max at recommended travel
- RoHS and HF compliant product.

| | | | | | | | |
|-------------------|-----|------------|-------------------|--------------|-----|------------------|-----------------|
| DRAW (设计) | 黄业沛 | SCALE (比例) | 6:1 | UNIT (单位) | mm | DRAWING NO. (图号) | CM-M2-075-20147 |
| COUNTER SIGN (会签) | N/A | SHEET (页数) | 1 of 1 | PROJECT (视图) | | MATERIAL (材质) | NA |
| AUDIT (审核) | | DATE (日期) | 2020/10/13 | VER (版次) | D.0 | TITLE (品名) | ICT Test Probes |
| APPROVE (核准) | | PLATE (镀层) | Seeing notes(见备注) | | | | |

THE UNMARKED TOLERANCE ARE AS BELOW :
 (未标记的公差)
 LENGTH (尺寸) ANGLE (角度)

| | | | |
|---------|---------------------|------|------------------|
| 0~6.0 | $\pm 0.05\text{mm}$ | 0.0 | $\pm 2.0^\circ$ |
| >6~30 | $\pm 0.10\text{mm}$ | 0.0 | $\pm 1.0^\circ$ |
| >30~120 | $\pm 0.15\text{mm}$ | 0.00 | $\pm 0.50^\circ$ |

C.C.P. (DG) CONTACT PROBES CO.,LTD.
东莞中探探针有限公司

The information in this document is property of C.C.P company and should not be copied or reproduced in any other way, without written permission.

4

3

2

1